

S5N



EXTENDED RANGE OF STANDARD “ONE FOR ALL” PHOTOELECTRIC TUBULAR M18 SENSORS

- All optic functions
- Improved EMI immunity
- Improved ambient light immunity
- Improved laser safety level
- M18 flat plastic with universal mounting
- Short plastic housing models
- Available in M18 metal housing
- Stainless steel housing models
- Axial or radial optics, cable or connector
- Standard 4-wire NO-NC NPN or PNP output
- M12 pigtail models available
- IO-Link connectivity V1.1 with double channel



APPLICATIONS

- Processing and Packaging machinery
- Conveyor lines, material handling
- Ceramics intralogistics
- Automated warehousing

(*) Stainless steel models. ATEX II 3DG

S5N		
Through beam	0...25 m (S5N-PP/NN; S5N-Px/Mx...PK/NK models) 0...20 m (S5N-SA/NA models) 0...60 m (class 1 LASER S5N...PP/NN models)	
Retroreflective (on R2 reflector)	0,1...4 m (S5N-PP/NN; S5N-Px/Mx...PK/NK models)	
Polarized retroreflective (on R2 reflector)	0,1...3m (S5N-Px/Mx...PK/NK models) 0,1...4 m (S5N...PP/NN; S5N-SA/NA models) 0,1...16 m (class 1 LASER S5N...PP/NN models)	
Retroreflective for transparent (on R2 reflector)	0,1...0,8 m (S5N-SA/NA) 0,1...1,3 m (S5N...PP/NN models)	
Diffuse proximity	short distance 0...100 mm (all models) medium distance 0...400 mm (S5N...PP/NN models) medium distance 0...350 (S5N-SA/NA models) medium distance 0...450 (S5N-Px/Mx...PK/NK models) long distance 0...700 ammm (S5N...PP/NN models) long distance Laser 0...350 mm (S5N...PP/NN models)	
Fixed focus	50 mm (S5N-SA/NA models) 100 mm (S5N...PP/NN models)	
Background suppression	40...120 mm (S5N-SA/NA models) 50...150 mm (S5N...PP/NN models)	
Through beam with fiber optic	0...100 mm (S5N...PP/NN models)	
Diffuse proximity with fiber optic	0...30 mm (S5N...PP/NN models)	
Contrast sensor	10 ±2 mm (S5N...PP/NN models)	
Luminescence sensor	0...20 mm (S5N...PP/NN models)	
Power supply	Vdc	10...30 V
	Vac	
Output	Vac/dc	
	PNP	•
	NPN	•
	NPN/PNP	
	relay	
Connection	other	IO-Link v 1.1
	cable	•
	connector	•
Approximate dimensions (mm)	pig-tail	•
Housing material		M18 x (see mechanical drawings)
Mechanical protection		PBT, Nickel plated Brass (S5N-PP/NN; S5N-Px/Mx...PK/NK models) ABS, AISI 316 L Stainless steel inox (S5N-SA/NA models) IP67 (S5N-PP/NN; S5N-Px/Mx...PK/NK models) IP65 - IP67 - IP69K (S5N-SA/NA)

TECHNICAL DATA

Power supply	10 ... 30 Vdc (limit values all models)
Ripple	2 Vpp max. (all models)
Consumption (output current excluded)	35 mA max. (all models)
Light emission	red LED 630 nm (mod. S5N...D00/E01, S5N-PA/MA...M03) red LED 660 nm (mod. S5N...B01...PP/NN/PK/NK; S5N...T01...PP/NN) - (mod. S5N-SA/NA...B/D/T/M) red LED 670 nm (mod. S5N-PS/MS...M03...PP/NN) IR LED 880 nm - (mod. S5N-Px/Mx...A00/C01/C10/C21/G00...PP/NN/PK/NK) - (mod. S5N-SA/NA...A/C/G) white LED 400-700 nm (mod. S5N...W03...PP/NN) UV LED 370 nm (mod. S5N...U03...PP/NN) red Laser 650 nm (mod. S5N-PH/PL...G00/B01/C01...PP/NN)
Setting	sensitivity trimmer 270° and without trimmer model (see mech drawings) 4 turns sensitivity trimmer (mod. S5N-Px/Mx...M01...PK/NK) teach-in push-button (mod. S5N...M03/W03/U03...PP/NN)
Operating mode	LIGHT mode on N.O. output / DARK mode on N.C. output (mod.S5N...C01/C10/C21/D00/M03/U03...PP/NN) DARK mode on N.O. output / LIGHT mode on N.C. output (mod.S5N...A00/B01/E01/F01/T01/W03...PP/NN) L/D input white wire or pin 2, if pin not connected on S5N-Px/Mx...PK/NK: LIGHT mode (mod. S5N-Px/Mx...C/D/M...PK/NK) DARK mode (mod. S5N-Px/Mx...A/B/T/F...PK/NK) white wire or pin 2 connected to: 0 V DARK mode, +Vcc LIGHT mode
Indicators	yellow OUTPUT LED (S5N, excl. mod. G00) green STABILITY LED (mod. S5N...B01/C01/C21/E01/F01/W03/U03), POWER LED (mod. S5N...G00) green/red READY/ERROR LED (mod. S5N...M03...PP/NN)
Output	PNP or NPN; NO; NC (mod. S5N...PP/NN) PNP or NPN (mod. S5N-Px/Mx...PK/NK) IO-Link v 1.1 (mod.S5N...OZ)
IO-Link interface	(mod.S5N...OZ) v 1.1, com 2, 38,4 kBAud, 32 bit process data, 5 ms cycle time LED emission model, 8 ms cycle time LASER emission model
Output current	100 mA max. (all models)
Saturation voltage	2 V max. (all models)
Response time	0,5 ms (mod. S5N...A00/B01/T01/C10/C21/C01/D00/E01/U03...PP/NN) - (mod. S5N-Px/Mx...D00...PK/NK) 2 ms (mod. S5N...F01/G00...PP/NN) - (mod. S5N-Px/Mx...F00...PK/NK) 1 ms (mod. S5N...M03...PP/NN) - (mod. S5N-Px/Mx...A/B/C/T/M...PK/NK) 100 µs (mod. S5N...W03...PP/NN) 333 µs (mod. S5N-PH/PL...PP/NN Laser emission models)
Switching frequency	1 kHz (mod. S5N...A00/B01/T01/C10/C21/C01/D00/E01/U03...PP/NN) - (mod. S5N-Px/Mx...D00...PK/NK) 250 Hz (mod. S5N...F01/G00...PP/NN) - (mod. S5N-Px/Mx...F00...PK/NK) 500 Hz (mod. S5N...M03...PP/NN) - (mod. S5N-Px/Mx...A/B/C/T/M...PK/NK) 100 µs (mod. S5N...W03...PP/NN) 333 µs (mod. S5N...PP/NN Laser emission models)
Connection	M12 4-pole connector, 2 m cable Ø 4 mm, 150 mm length Ø 4 mm cable with M12 4-pole connector
Dielectric strength	500 Vac, 1 min between electronics and housing
Insulating resistance	>20 MΩ, 500 Vdc between electronics and housing
Electrical protection	class 2
Mechanical protection	IP67 (S5N-PP/NN; S5N-Px/Mx...PK/NK models) IP65 - IP67 - IP69K (S5N-SA/NA)
Ambient light rejection	according to EN 60947-5-2
Vibrations	0,5 mm amplitude, 10 ... 55 Hz frequency, for every axis (EN60068-2-6)
Shock resistance	11 ms (30 G) 6 shock for every axis (EN60068-2-27)
Housing material	PBT, Nickel plated Brass (S5N-Px/Mx...PP/NN/PK/NK models) ABS, AISI 316 L Stainless steel inox (S5N-SA/NA models)
Lens material	PMMA (all models)
Operating temperature	-25 ... 55 °C (Laser mod.) -10 ... 50 °C
Storage temperature	-25 ... 70 °C
Weight	Plastic version 75 g max. cable vers. (90 g max. mod. M03), 25 g max. conn. vers. (40 g max. mod. M03) Metal version 110 g max. cable vers. (125 g max. mod. M03), 60 g max. conn. vers. (75 g max. mod. M03)

DIMENSIONS

S5N...NN/PP MODELS

PLASTIC

AXIAL VERSION

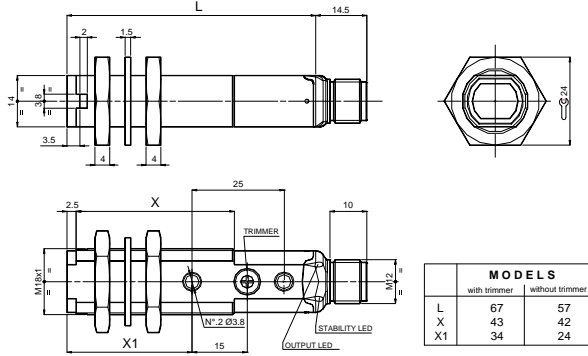

RADIAL VERSION

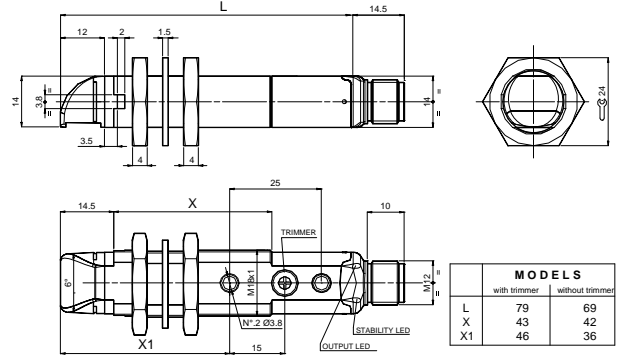

FIBRE OPTIC VERSION

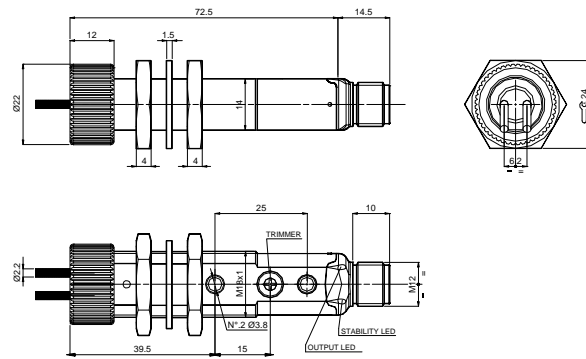

METAL

AXIAL VERSION

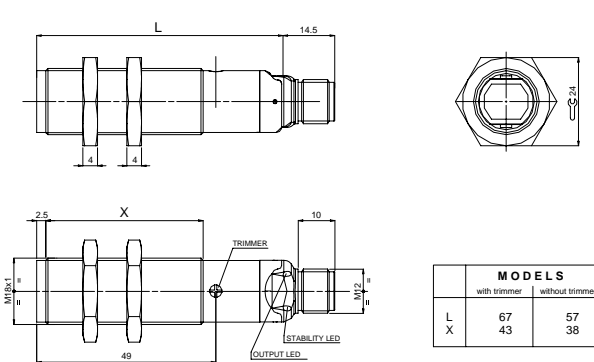

RADIAL VERSION

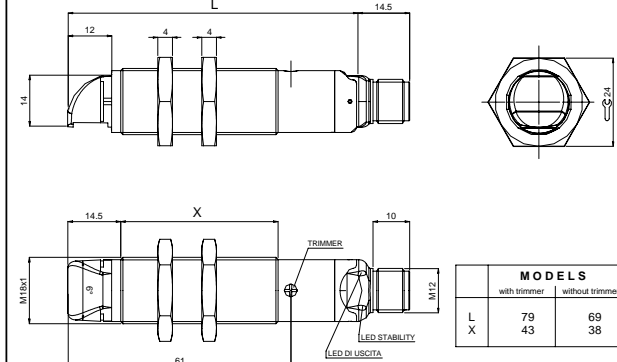

FIBRE OPTIC VERSION

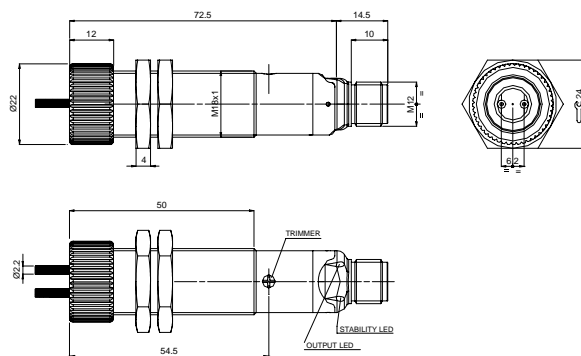

BACKGROUND SUPPRESSION AXIAL VERSION

PLASTIC

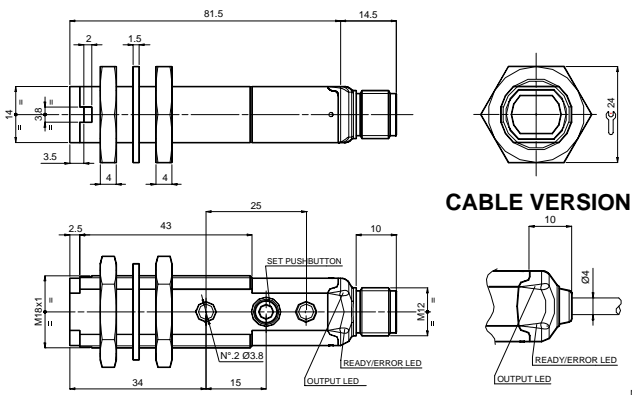

METAL

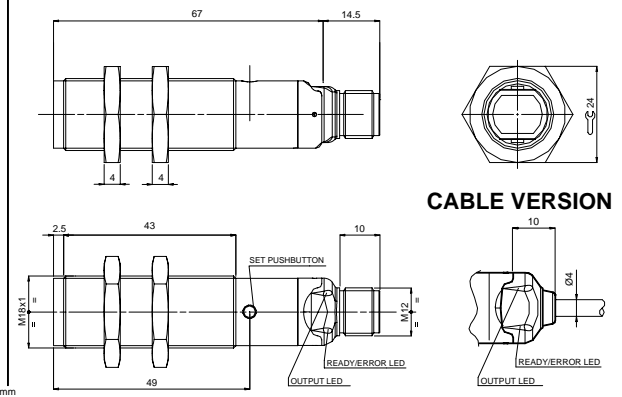

BACKGROUND SUPPRESSION RADIAL VERSION

PLASTIC

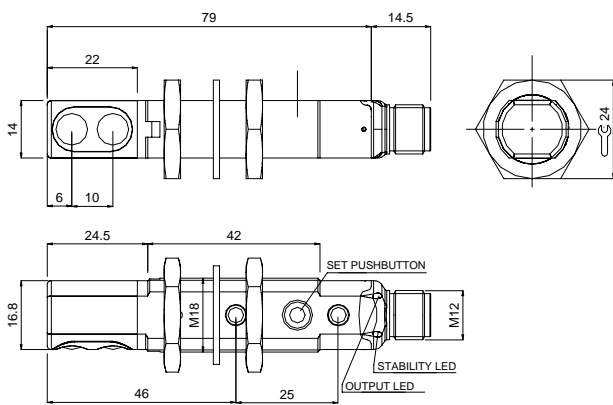

METAL

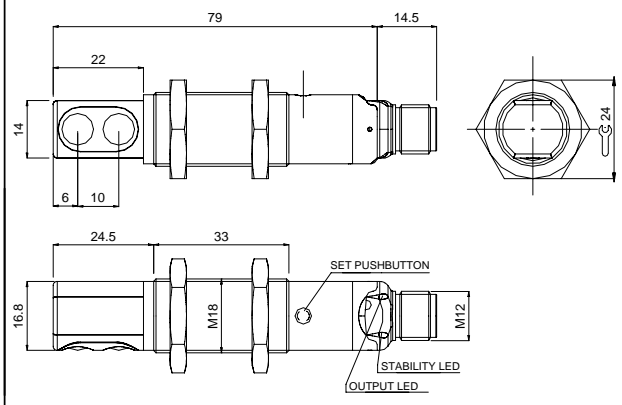

LUMINESCENCE AND CONTRAST

PLASTIC

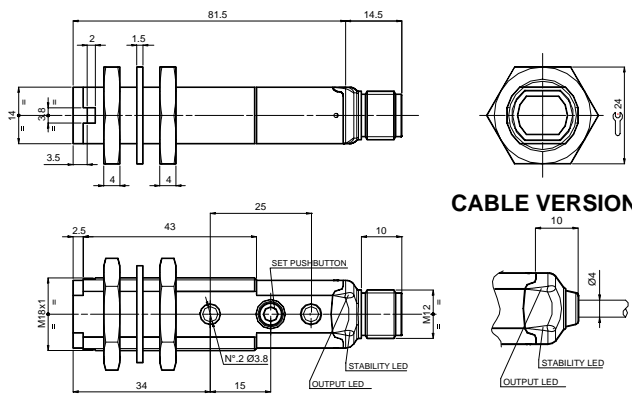

METAL

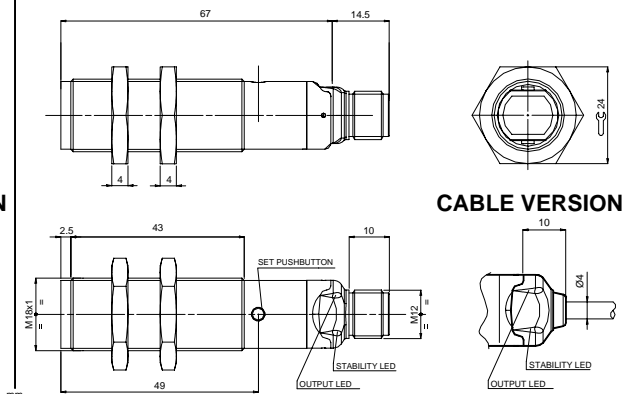

DIMENSIONS

S5N-Px/Mx...PK/NK MODELS

AXIAL VERSION

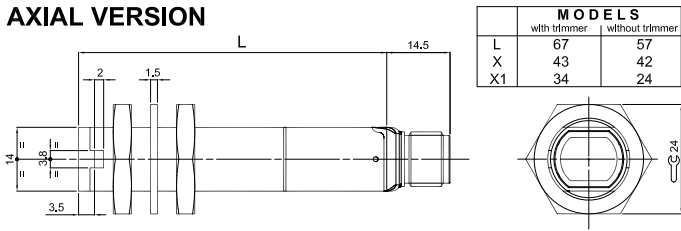

	MODELS	
	with trimmer	without trimmer
L	67	57
X	43	42
X1	34	24

RADIAL VERSION

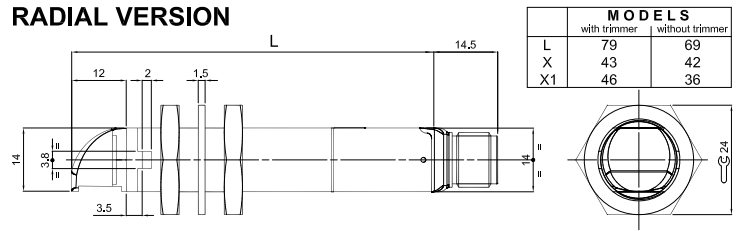

	MODELS	
	with trimmer	without trimmer
L	79	69
X	43	42
X1	46	36

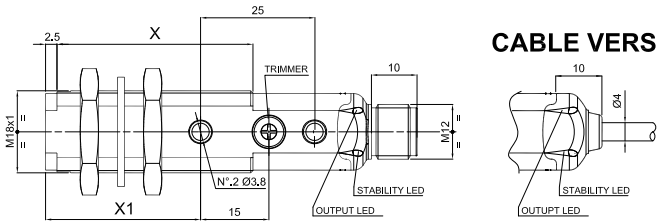

CABLE VERS

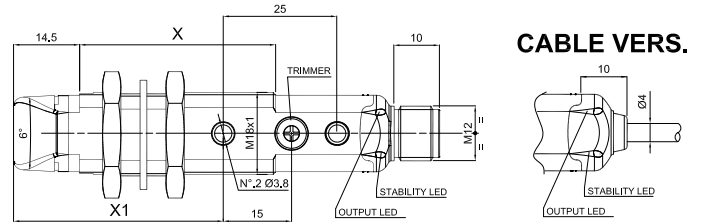

CABLE VERS.

CH.24 PLASTIC NUTS

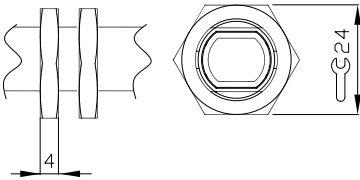

CH.22 PLASTIC NUTS

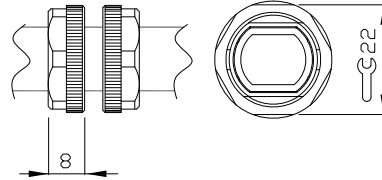

AXIAL VERSION

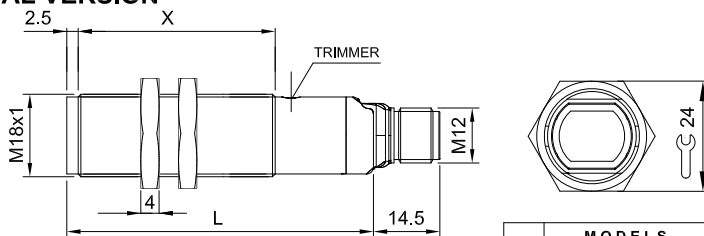

	MODELS	
	B01/C01/F00	A00/C10/G00
L	67	57
X	43	38

RADIAL VERSION

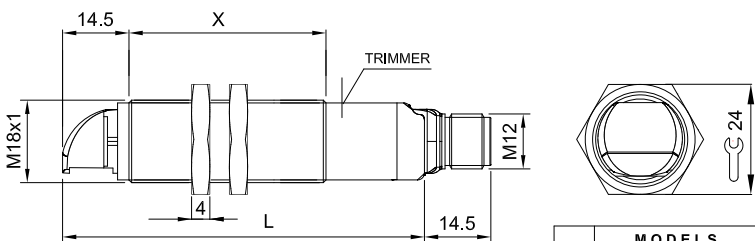

	MODELS	
	B01/C01/F00	A00/C10/G00
L	79	69
X	43	38

mm

CABLE VERSION

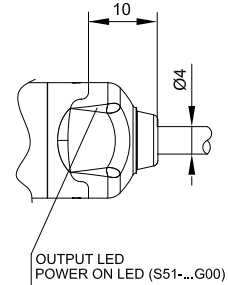

S5N-SA MODELS

PLASTIC

M12 connector version

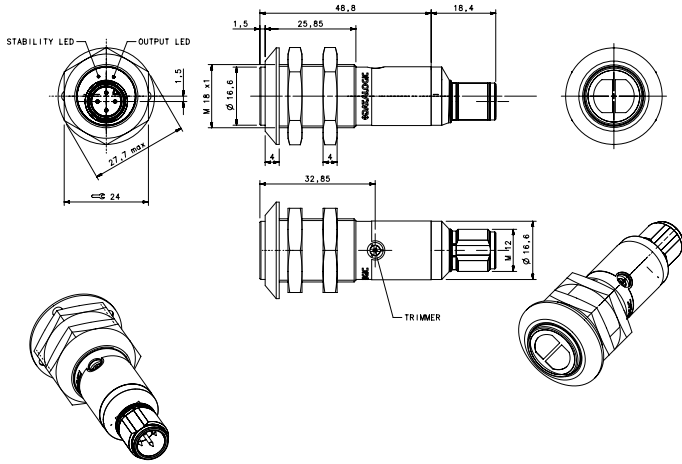

Cable version

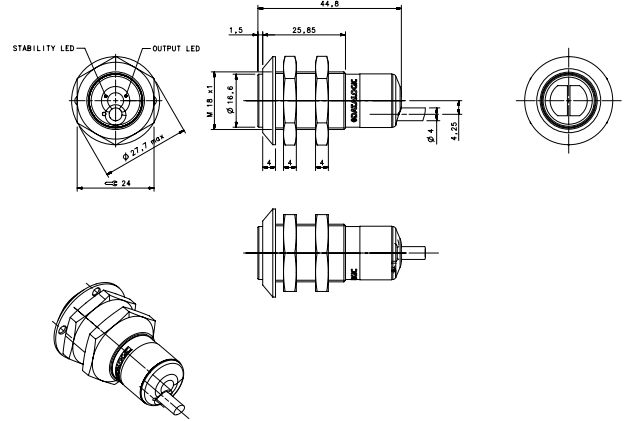

Through beam emitter - M12 connector version

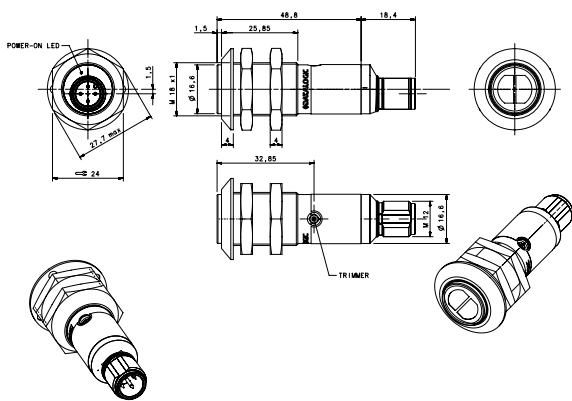

Background suppression - M12 connector version

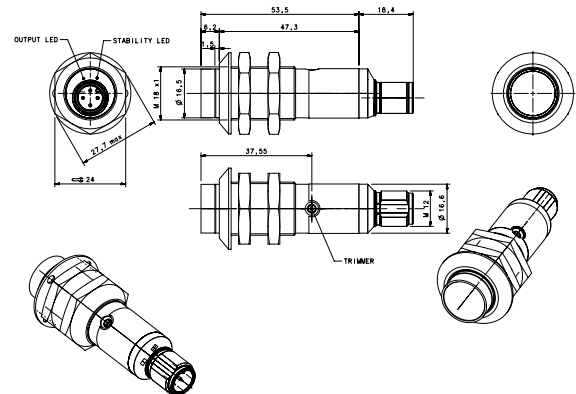

Through beam emitter - cable version

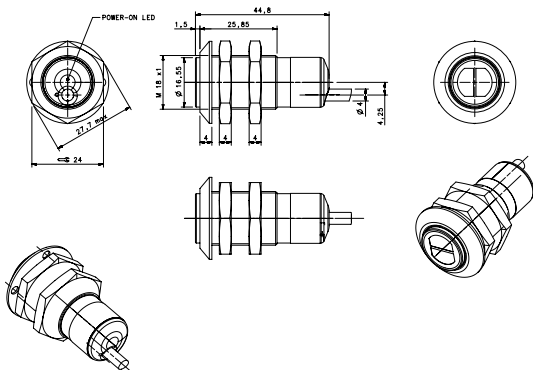

Diffuse proximity - cable version

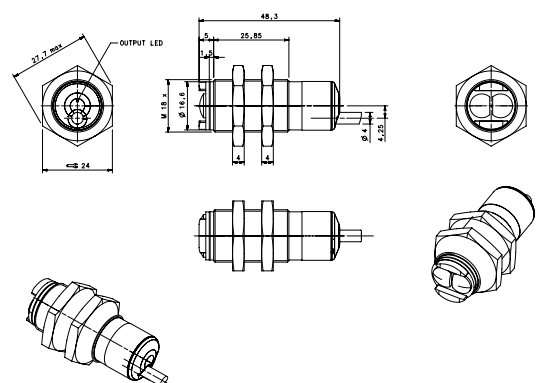

S5N...NA/SA MODELS

Cable and Pig-tail

M12 connector

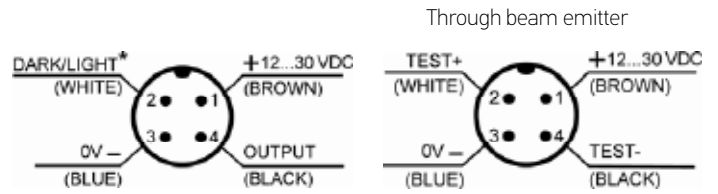
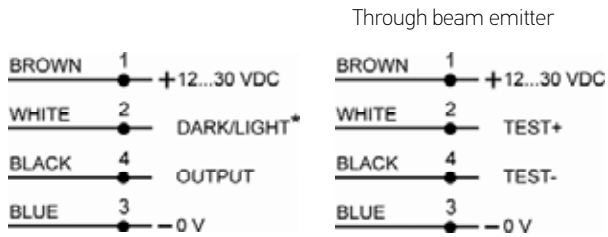

INDICATORS AND SETTINGS

S5N...PP/NN MODELS

S5N-XX...A00/B01/C01/C21/E01/F01/T01

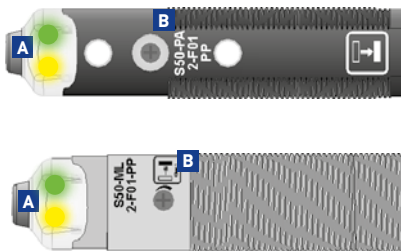

- A** OUTPUT status LED Yellow
STABILITY LED Green (Only Receiver)
POWER ON LED Green (Only Emitter)
- B** Adjustment trimmer (receiver)

Single-turn trimmer for sensitivity adjustment. Rotate in a clockwise direction to increase the operating distance.

S5N-XX-U03

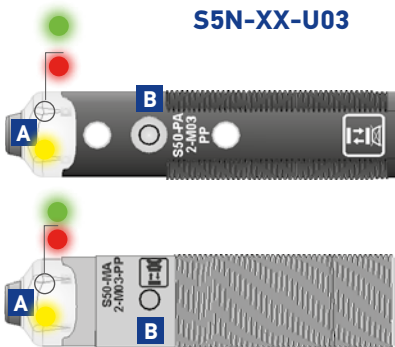

- A** OUTPUT status LED Yellow
READY LED Green
LED Red error
- B** Teach-in push-button

Teach-in button for setting.

EASYtouch™ provides two setting modes: standard or fine, both obtained by pressing the push-button only once. Please refer to instructions manual for operating details.

S5N-XX-M03/W03

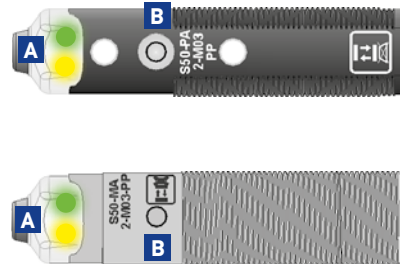

- A** OUTPUT status LED Yellow
READY LED Green
- B** Teach-in push-button

S5N-XX-A00/C10/D00

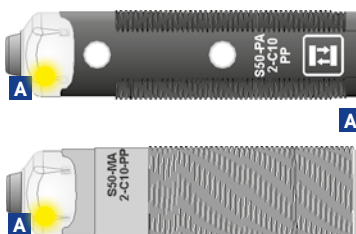

- A00/C10
A OUTPUT status LED Yellow
- G00
A OUTPUT status LED yellow (Only Emitter G00)

S5N-Px/Mx...PK/NK MODELS

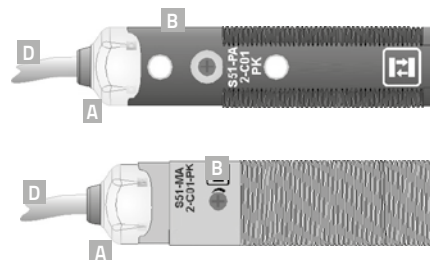

- A** OUTPUT status LED;
POWER ON LED on G00 model
- B** Adjustment trimmer (B01, C01 models)
- C** M12 connector
- D** Cable connection

Trimmer for sensitivity adjustment. Rotate in a clockwise direction to increase the operating distance.

S5N...SA/NA MODELS

Plastic/metal case with trimmer, M12 connector

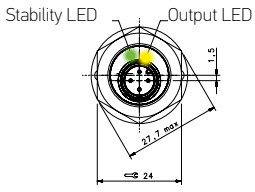

A01, B01, C11, C31, T01, F01, M01

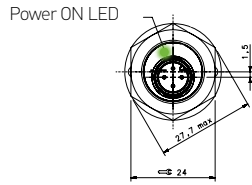

G01

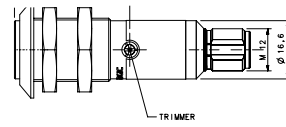

Plastic, no trimmer, Cable, Pig Tail

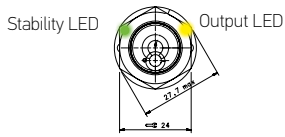

A00, B00, C10, C00, T01, D50

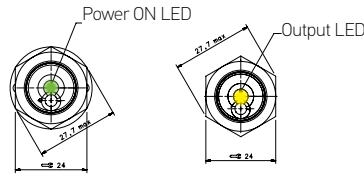

G00

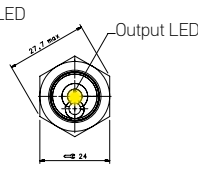

F00



DETECTION DIAGRAMS

S5N...PP/NN MODELS

THROUGH BEAM (G/F) INFRARED EMISSION

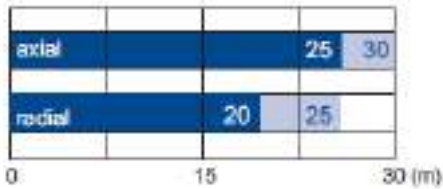

■ Recommended operating distance
■ Maximum operating distance

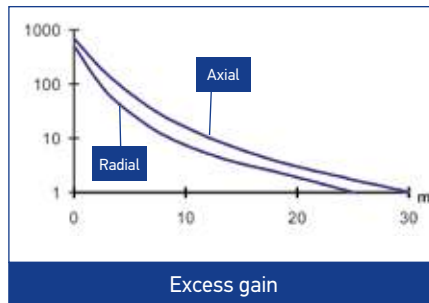

Excess gain

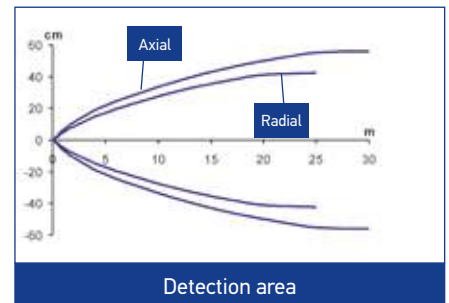

Detection area

THROUGH BEAM (G/F) LASER RED EMISSION



■ Operating distance

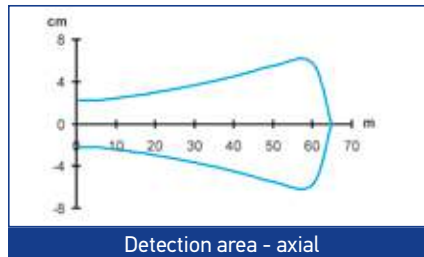

Detection area - axial

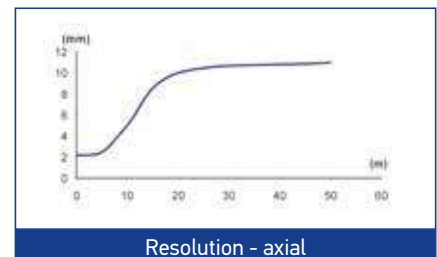

Resolution - axial

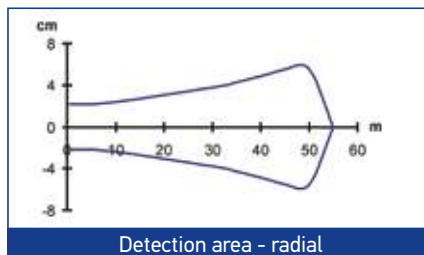

Detection area - radial

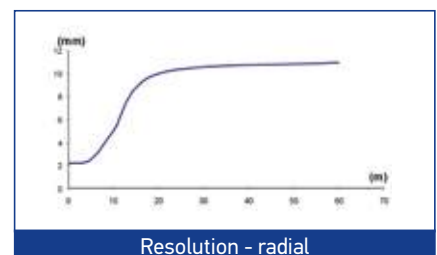

Resolution - radial

RETROREFLECTIVE (A) INFRARED EMISSION



Operating distance

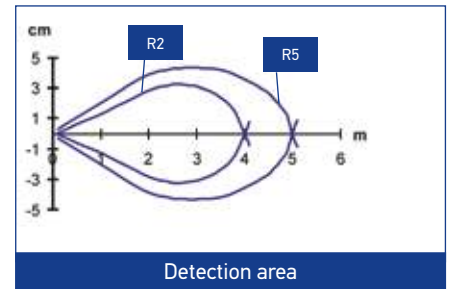
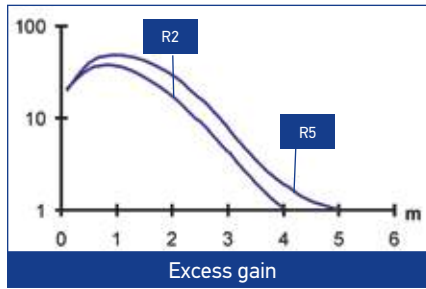

RETROREFLECTIVE POLARIZED (B) RED EMISSION



Recommended operating distance
Maximum operating distance

High efficiency reflectors can be used to obtain larger operating distances. Refer to **Reflectors** (A.01).

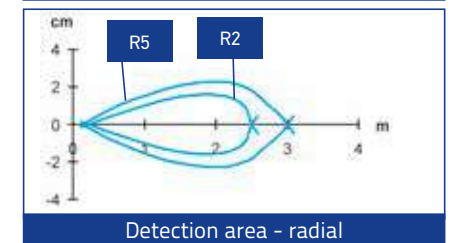
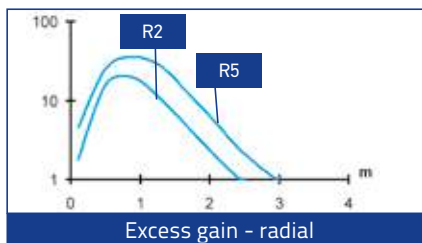
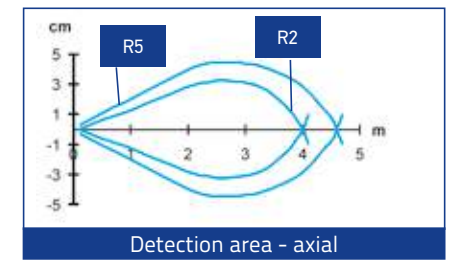
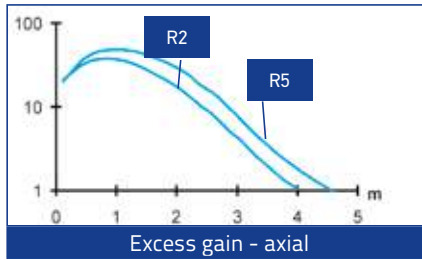

RETROREFLECTIVE POLARIZED (B) LASER RED EMISSION

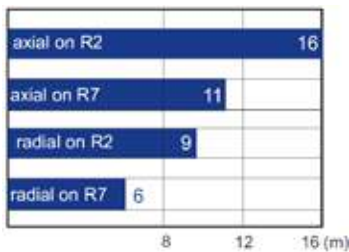

Operating distance

High efficiency reflectors can be used to obtain larger operating distances. Refer to **Reflectors** (A.01).

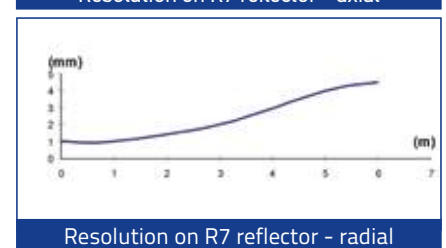
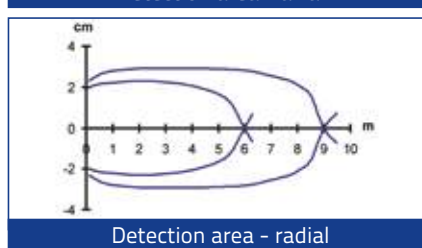
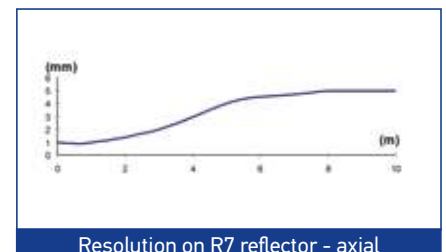
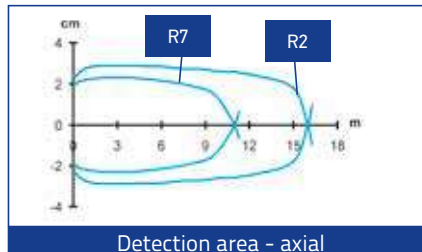

RETROREFLECTIVE TRANSPARENT (T) RED EMISSION

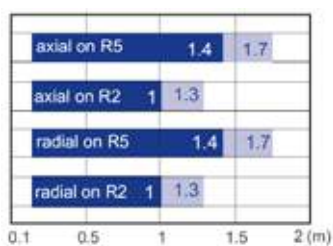

Recommended operating distance
Maximum operating distance

High efficiency reflectors can be used to obtain larger operating distances. Refer to **Reflectors**.

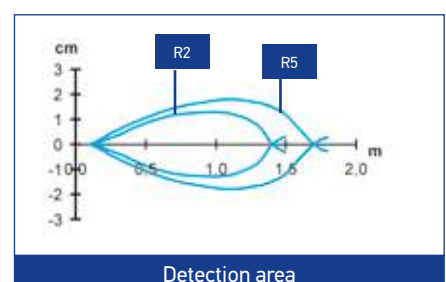
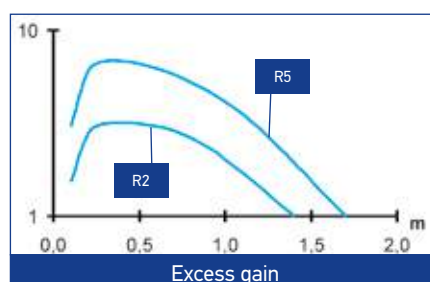

ENERGETIC DIFFUSED (C) SHORT INFRARED EMISSION

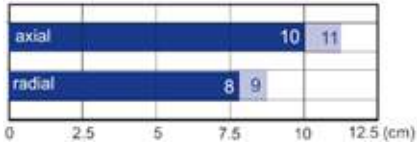

Recommended operating distance
 Maximum operating distance

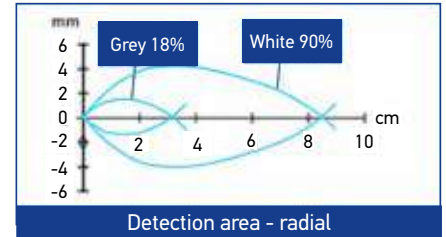
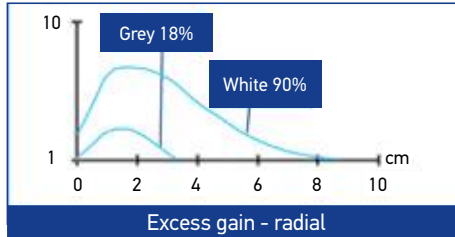
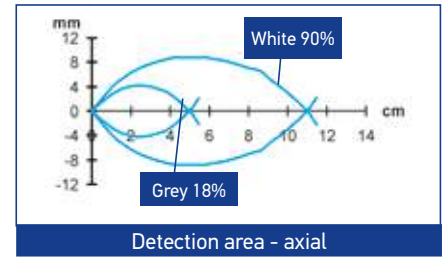
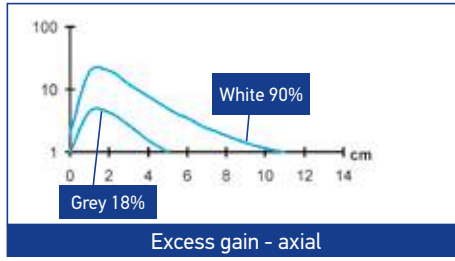

ENERGETIC DIFFUSED (C) MID INFRARED EMISSION

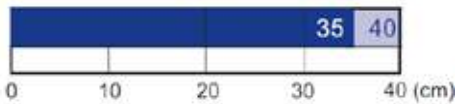

Recommended operating distance
 Maximum operating distance

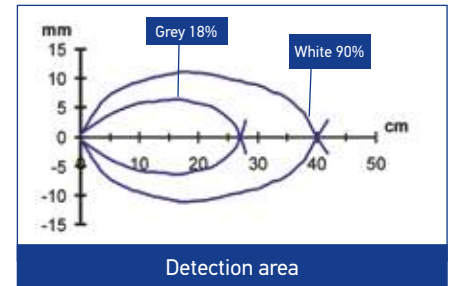
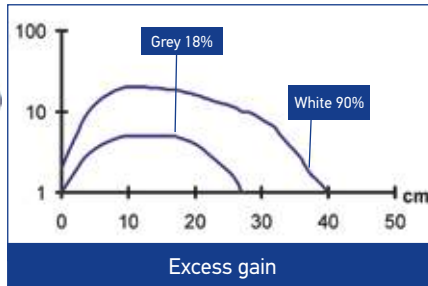

ENERGETIC DIFFUSED (C) LONG INFRARED EMISSION

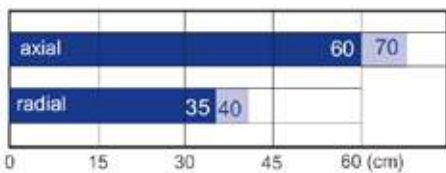

Recommended operating distance
 Maximum operating distance

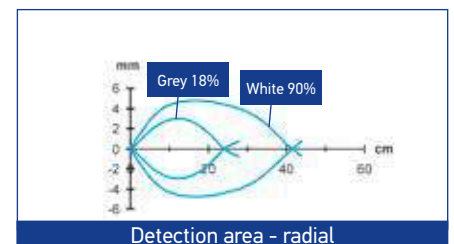
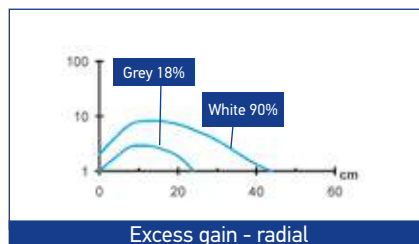
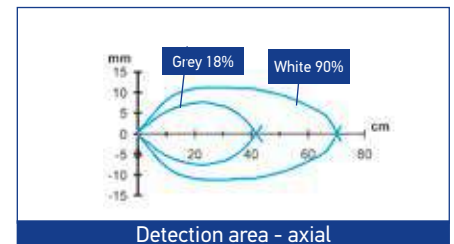
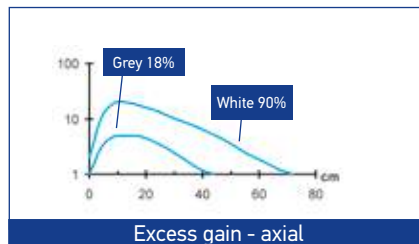

FIXED FOCUS (D) RED EMISSION

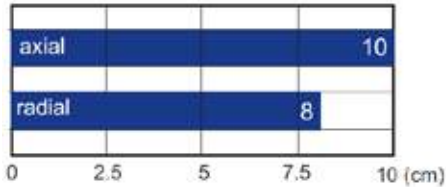

Operating distance

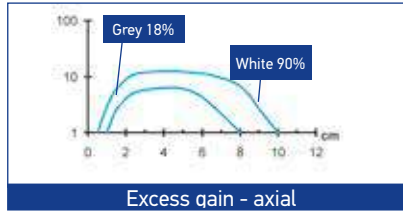

Excess gain - axial

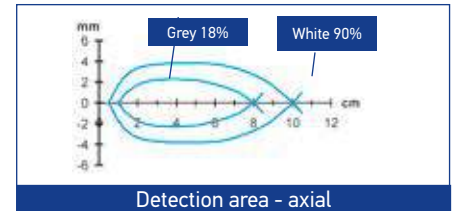

Detection area - axial

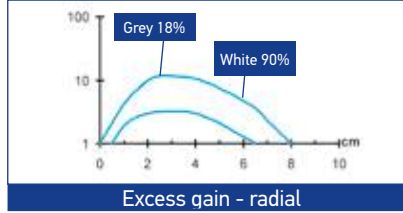

Excess gain - radial

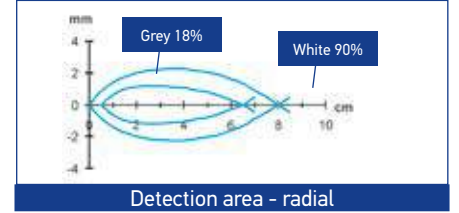

Detection area - radial

DIFFUSED (C) LASER RED EMISSION

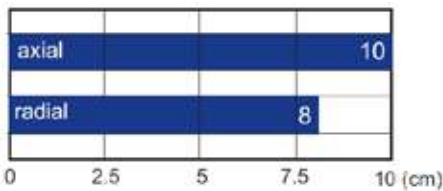

Operating distance

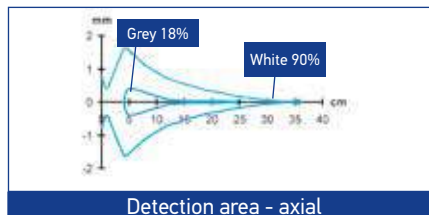

Detection area - axial

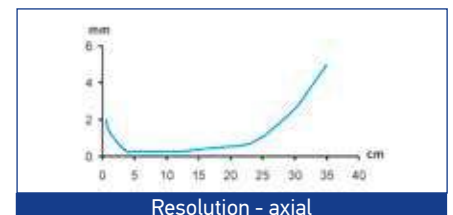

Resolution - axial

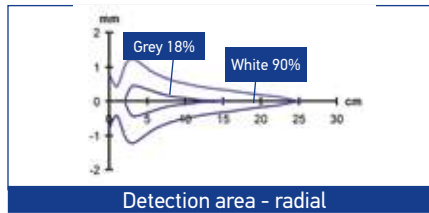

Detection area - radial

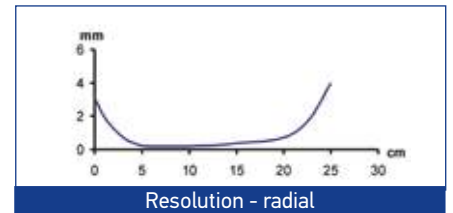

Resolution - radial

BACKGROUND SUPPRESSOR (M) AXIAL RED EMISSION

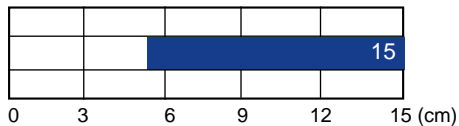

Operating distance

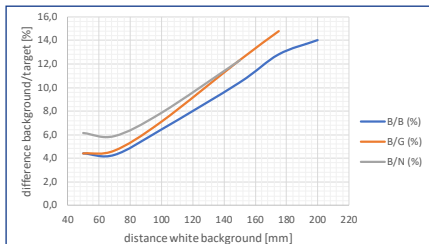

Detection difference with EASYtouch™ acquisition

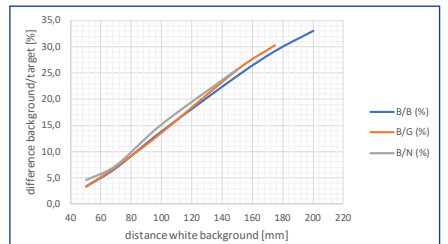

Detection difference with EASYtouch™ fine acquisition

BACKGROUND SUPPRESSOR (M) RADIAL RED EMISSION

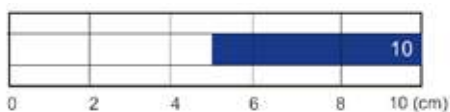

Operating distance

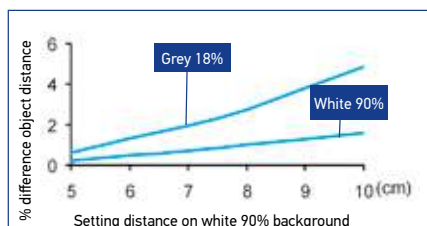

Detection difference with EASYtouch™ acquisition

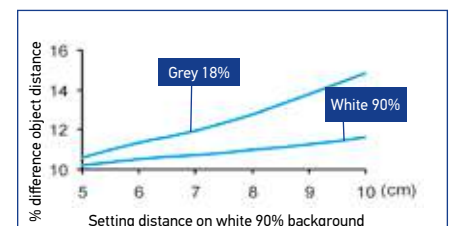

Detection difference with fine acquisition

FIBER OPTIC (E) RED EMISSION

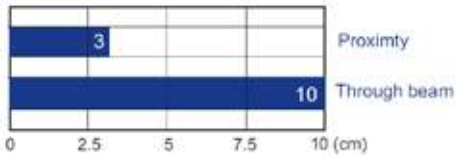

Operating distance with standard fibers

Standard Fiber-optics:
OF-42-ST-20 proximity
OF-43-ST-20 through beam

High efficiency fiber-optics or accessory lenses can be used to obtain larger operating distances.

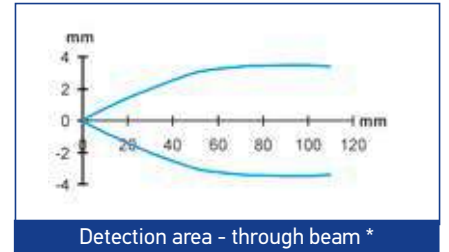
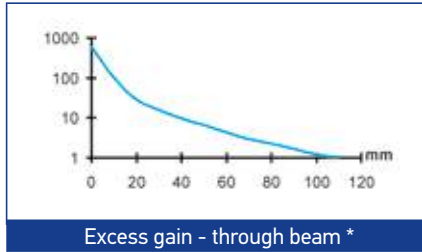
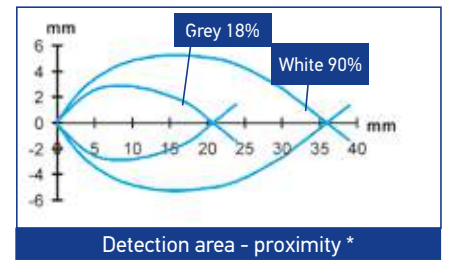
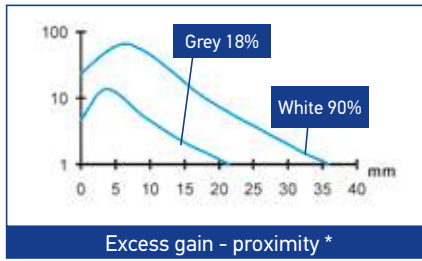

* standard Fiber-optics

MARK READER (W) WHITE EMISSION

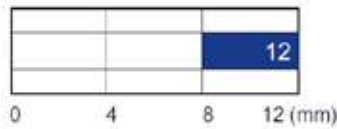

Operating distance

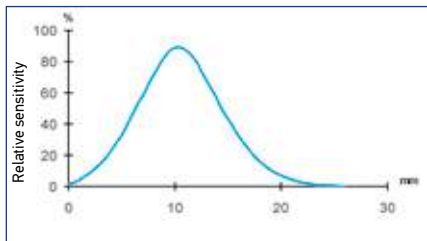

Operating distance

LUMINESCENCE (U) UV EMISSION

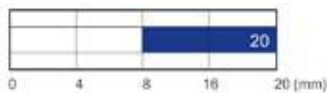

Operating distance

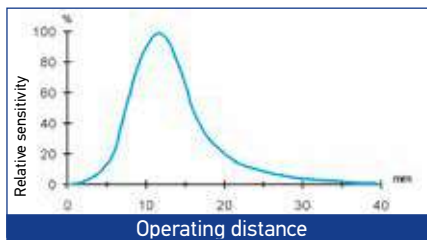

Operating distance

S5N...PK/NK MODELS

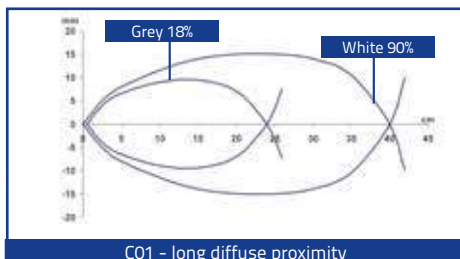

C01 - long diffuse proximity

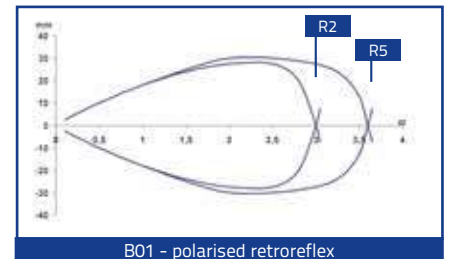

B01 - polarised retroreflex

D01	2.5	3
B01	3	3.5
B01	2	2.5
B01	2.5	3

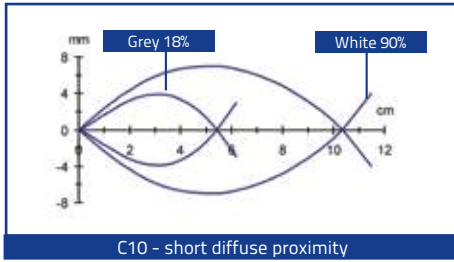

C01	40	45
C01	30	35

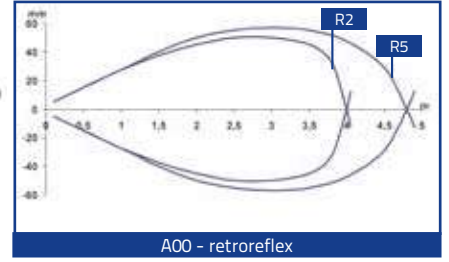

F/G	18	20
F/G	15	18

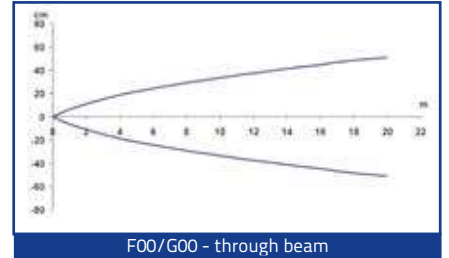
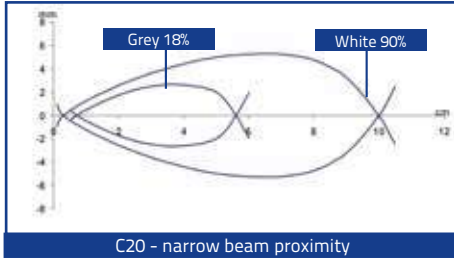

Recommended operating distance
Maximum operating distance

Note: the diagrams indicate the detection area typical of the axial optic versions; the maximum operating distance of the radial optic versions decreases as indicated in the tables given below

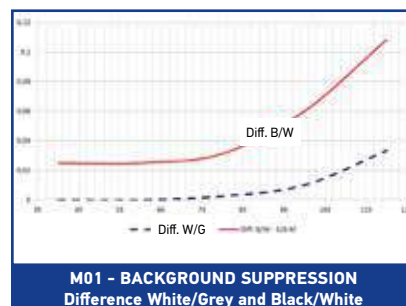
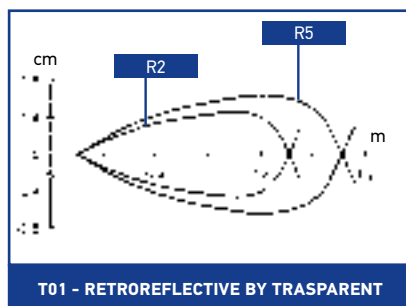
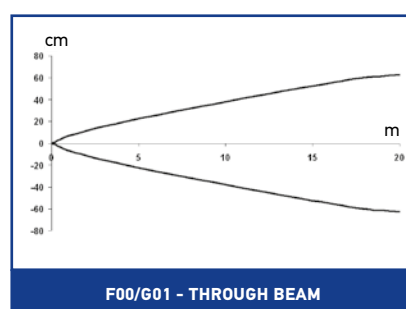
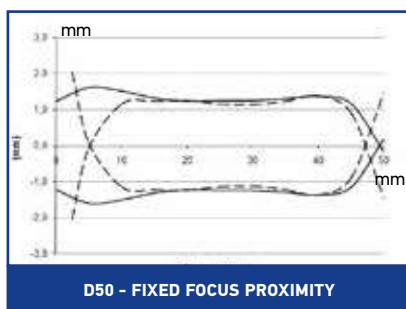
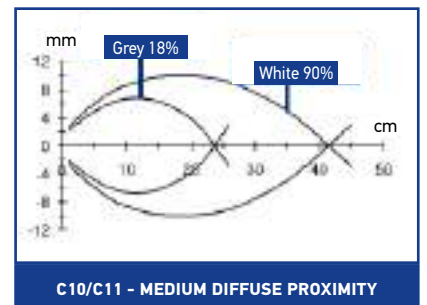
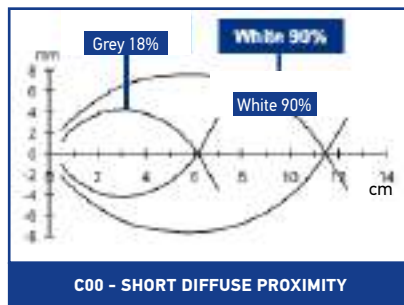
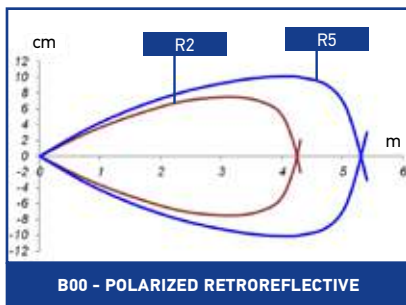

S5N-SA/NA MODELS



MODEL SELECTION AND ORDER INFORMATION

S5N - STANDARD PLASTIC HOUSING - NO/NC STANDARD OUTPUT & IO-LINK MODELS (S5N-PA...PP/NN/OZ)						
OPTIC FUNCTION	EMISSION	CONNECTION	OUTPUT	MODEL	ORDER NO.	
Retroreflective	LED, Axial optic	2m Cable	NPN	S5N-PA-2-A00-NN	952002091	
			PNP	S5N-PA-2-A00-PP	952002081	
		M12 Connector	NPN	S5N-PA-5-A00-NN	952002111	
			PNP	S5N-PA-5-A00-PP	952002101	
Polarized retroreflective	LED, Axial optic	2m Cable	NPN	S5N-PA-2-B01-NN	952001611	
			PNP	S5N-PA-2-B01-PP	952001011	
		M12 Connector	NPN	S5N-PA-5-B01-NN	952001501	
			PNP	S5N-PA-5-B01-PP	952001021	
	LED, Radial optic	2m Cable	NPN	S5N-PR-2-B01-NN	952001781	
			PNP	S5N-PR-2-B01-PP	952001031	
		M12 Connector	NPN	S5N-PR-5-B01-NN	952001721	
			PNP	S5N-PR-5-B01-PP	952001041	
	LASER, Axial optic	2m Cable	NPN	S5N-PL-2-B01-NN	952001871	
			PNP	S5N-PL-2-B01-PP	952001361	
		M12 Connector	NPN	S5N-PL-5-B01-NN	952001841	
			PNP	S5N-PL-5-B01-PP	952001371	
LASER, Radial optic	2m Cable	IO-Link	S5N-PL-5-B01-OZ	952002250		
		NPN	S5N-PH-2-B01-NN	952001951		
	M12 Connector	PNP	S5N-PH-2-B01-PP	952001941		
		NPN	S5N-PH-5-B01-NN	952001971		
Long Diffuse proximity	LED, Axial optic	2m Cable	NPN	S5N-PA-2-C01-NN	952001621	
			PNP	S5N-PA-2-C01-PP	952001051	
		M12 Connector	NPN	S5N-PA-5-C01-NN	952001511	
			PNP	S5N-PA-5-C01-PP	952001061	
	LED, Radial optic	2m Cable	IO-Link	S5N-PA-5-C01-OZ	952002210	
			NPN	S5N-PR-2-C01-NN	952001791	
		M12 Connector	PNP	S5N-PR-2-C01-PP	952001071	
			NPN	S5N-PR-5-C01-NN	952001731	
	LASER, Axial optic	2m Cable	PNP	S5N-PR-5-C01-PP	952001081	
			NPN	S5N-PL-2-C01-NN	952001881	
		M12 Connector	PNP	S5N-PL-2-C01-PP	952001381	
			NPN	S5N-PL-5-C01-NN	952001851	
	LASER, Radial optic	2m Cable	PNP	S5N-PL-5-C01-PP	952001391	
			IO-Link	S5N-PL-5-C01-OZ	952002260	
		M12 Connector	NPN	S5N-PH-2-C01-NN	952001991	
			PNP	S5N-PH-2-C01-PP	952001981	
	Short Diffuse proximity	LED, Axial optic	2m Cable	NPN	S5N-PA-2-C10-NN	952001631
				PNP	S5N-PA-2-C10-PP	952001241
			M12 Connector	NPN	S5N-PA-5-C10-NN	952001521
				PNP	S5N-PA-5-C10-PP	952001251
		LED, Radial optic	2m Cable	NPN	S5N-PR-2-C10-NN	952001801
				PNP	S5N-PR-2-C10-PP	952001491
			M12 Connector	NPN	S5N-PR-5-C10-NN	952001741
				PNP	S5N-PR-5-C10-PP	952001481
Medium Diffuse proximity		LED, Axial optic	2m Cable	NPN	S5N-PA-2-C21-NN	952002171
				PNP	S5N-PA-2-C21-PP	952002161
			M12 Connector	NPN	S5N-PA-5-C21-NN	952002191
				PNP	S5N-PA-5-C21-PP	952002181
Fixed focus		LED, Axial optic	2m Cable	NPN	S5N-PA-2-D00-NN	952001641
				PNP	S5N-PA-2-D00-PP	952001091
			M12 Connector	NPN	S5N-PA-5-D00-NN	952001531
				PNP	S5N-PA-5-D00-PP	952001101
		LED, Radial optic	2m Cable	NPN	S5N-PR-2-D00-NN	952001811
				PNP	S5N-PR-2-D00-PP	952001111
			M12 Connector	NPN	S5N-PR-5-D00-NN	952001751
				PNP	S5N-PR-5-D00-PP	952001121
Fiber optic		LED, Axial optic	2m Cable	NPN	S5N-PA-2-E01-NN	952001651
				PNP	S5N-PA-2-E01-PP	952001131
			M12 Connector	NPN	S5N-PA-5-E01-NN	952001541
				PNP	S5N-PA-5-E01-PP	952001141
Through beam receiver	LED, Axial optic	2m Cable	NPN	S5N-PA-2-F01-NN	952001661	
			PNP	S5N-PA-2-F01-PP	952001151	
		M12 Connector	NPN	S5N-PA-5-F01-NN	952001551	
			PNP	S5N-PA-5-F01-PP	952001161	
Through beam receiver	LED, Radial optic	2m Cable	NPN	S5N-PR-2-F01-NN	952001821	
			PNP	S5N-PR-2-F01-PP	952001171	
		M12 Connector	NPN	S5N-PR-5-F01-NN	952001761	
			PNP	S5N-PR-5-F01-PP	952001181	
	LASER, Axial optic	2m Cable	NPN	S5N-PL-2-F01-NN	952001891	
			PNP	S5N-PL-2-F01-PP	952001401	
		M12 Connector	NPN	S5N-PL-5-F01-NN	952001861	
			PNP	S5N-PL-5-F01-PP	952001411	
	LASER, Radial optic	2m Cable	NPN	S5N-PH-2-F01-NN	952002031	
			PNP	S5N-PH-2-F01-PP	952002021	
		M12 Connector	NPN	S5N-PH-5-F01-NN	952002051	
			PNP	S5N-PH-5-F01-PP	952002041	
Through beam emitter	LED, Axial optic	2m Cable	-	S5N-PA-2-G00-XG	952001191	
		M12 Connector	-	S5N-PA-5-G00-XG	952001201	
	LED, Radial optic	2m Cable	-	S5N-PR-2-G00-XG	952001211	
		M12 Connector	-	S5N-PR-5-G00-XG	952001221	
	LASER, Axial optic	2m Cable	-	S5N-PL-2-G00-XG	952001421	
		M12 Connector	-	S5N-PL-5-G00-XG	952001431	
	LASER, Radial optic	2m Cable	-	S5N-PH-2-G00-XG	952002061	
		M12 Connector	-	S5N-PH-5-G00-XG	952002071	

S5N - STANDARD PLASTIC HOUSING - NO/NC STANDARD OUTPUT & IO-LINK MODELS (S5N-PA...PP/NN/OZ)

Background suppression	LED, Axial optic	2m Cable	NPN	S5N-PA-2-M03-NN	952001671
			PNP	S5N-PA-2-M03-PP	952001231
	M12 Connector		NPN	S5N-PA-5-M03-NN	952001561
			PNP	S5N-PA-5-M03-PP	952001001
Retroreflective for transparent	LED, Radial optic	M12 Connector	 IO-Link	S5N-PA-5-M03-OZ	952002230
			PNP	S5N-PS-5-M03-PP	952001931
	2m Cable		NPN	S5N-PS-5-M03-NN	952001921
			PNP	S5N-PS-2-M03-PP	952001911
Luminescence	LED, Axial optic	M12 Connector	NPN	S5N-PS-2-M03-NN	952001901
			NPN	S5N-PA-2-T01-NN	952001691
	M12 Connector		PNP	S5N-PA-2-T01-PP	952001261
			NPN	S5N-PA-5-T01-NN	952001581
Contrast	LED, Radial optic	2m Cable	PNP	S5N-PA-5-T01-PP	952001271
			 IO-Link	S5N-PA-5-T01-OZ	952002220
	M12 Connector		NPN	S5N-PR-2-T01-NN	952001831
			PNP	S5N-PR-2-T01-PP	952001281
Retroreflective	LED, Axial optic	2m Cable	NPN	S5N-PR-5-T01-NN	952001771
			PNP	S5N-PR-5-T01-PP	952001291
	M12 Connector		NPN	S5N-PA-2-U03-NN	952001701
			PNP	S5N-PA-2-U03-PP	952001301
Diffuse proximity	LED, Axial optic	2m Cable	NPN	S5N-PA-5-U03-NN	952001591
			PNP	S5N-PA-5-U03-PP	952001311
	M12 Connector		NPN	S5N-PA-2-W03-NN	952001711
			PNP	S5N-PA-2-W03-PP	952001321
Retroreflective	LED, Axial optic	2m Cable	NPN	S5N-PA-5-W03-NN	952001601
			PNP	S5N-PA-5-W03-PP	952001331
	M12 Connector		 IO-Link	S5N-PA-5-W03-OZ	952002240





S5N - STANDARD PLASTIC HOUSING - L/D INPUT MODELS (S5N-PA...PK/NK)

Retroreflective	LED, Axial optic	2m Cable	NPN	S5N-PA-2-A00-NK	952701072
			PNP	S5N-PA-2-A00-PK	952701002
	M12 Connector		NPN	S5N-PA-5-A00-NK	952701332
			PNP	S5N-PA-5-A00-PK	952701262
Polarized retroreflective	LED, Radial optic	2m Cable	NPN	S5N-PR-2-A00-NK	952701202
			PNP	S5N-PR-2-A00-PK	952701132
	M12 Connector		PNP	S5N-PR-5-A00-PK	952701392
		LED, Axial optic	2m Cable	NPN	S5N-PA-2-B01-NK
	PNP		S5N-PA-2-B01-PK	952701012	
Diffuse proximity	LED, Radial optic	M12 Connector	NPN	S5N-PA-5-B01-NK	952701342
			PNP	S5N-PA-5-B01-PK	952701272
	2m Cable		NPN	S5N-PR-2-B01-NK	952701212
			PNP	S5N-PR-2-B01-PK	952701142
Short Diffuse proximity	LED, Axial optic	M12 Connector	PNP	S5N-PR-5-B01-PK	952701402
			NPN	S5N-PA-2-C01-NK	952701092
	M12 Connector		PNP	S5N-PA-2-C01-PK	952701022
			NPN	S5N-PA-5-C01-NK	952701352
Through beam receiver	LED, Radial optic	2m Cable	PNP	S5N-PA-5-C01-PK	952701282
			NPN	S5N-PR-2-C01-NK	952701222
	M12 Connector		PNP	S5N-PR-2-C01-PK	952701152
			PNP	S5N-PR-5-C01-PK	952701412
Through beam emitter	LED, Axial optic	2m Cable	NPN	S5N-PA-2-C10-NK	952701102
			PNP	S5N-PA-2-C10-PK	952701032
	M12 Connector		NPN	S5N-PA-5-C10-NK	952701362
			PNP	S5N-PA-5-C10-PK	952701292
Through beam receiver	LED, Radial optic	2m Cable	NPN	S5N-PR-2-C10-NK	952701232
			PNP	S5N-PR-2-C10-PK	952701162
	M12 Connector		PNP	S5N-PR-5-C10-PK	952701422
		LED, Axial optic	2m Cable	NPN	S5N-PA-2-F00-NK
	NPN		S5N-PA-5-F00-NK	952701382	
Through beam emitter	LED, Radial optic	M12 Connector	PNP	S5N-PA-5-F00-PK	952701312
			PNP	S5N-PR-5-F00-PK	952701442
	LED, Axial optic	2m Cable	-	S5N-PA-2-G00-XG	952001191
			-	S5N-PA-5-G00-XG	952001201
Through beam emitter	LED, Radial optic	2m Cable	-	S5N-PR-2-G00-XG	952001211
			-	S5N-PR-5-G00-XG	952001221
	LASER, Axial optic	2m Cable	-	S5N-PL-2-G00-XG	952001421
			-	S5N-PL-5-G00-XG	952001431
Retroreflective for transparent	LASER, Radial optic	2m Cable	-	S5N-PH-2-G00-XG	952002061
			-	S5N-PH-5-G00-XG	952002071

S5N - SHORT PLASTIC HOUSING - L/D INPUT MODELS (S5N-SA...)

Polarized retroreflective	LED, Axial optic	2m Cable	NPN	S5N-SA-2-B00-NK	952301062
			PNP	S5N-SA-2-B00-PK	952301012
Pig Tail M12		PNP	S5N-SA-3-B00-PK	952301122	
Diffuse proximity		2m Cable		NPN	S5N-SA-2-C00-NK
			PNP	S5N-SA-2-C00-PK	952301022
Short Diffuse proximity Fixed Focus	Pig Tail M12		PNP	S5N-SA-3-C00-PK	952301132
			PNP	S5N-SA-3-C10-PK	952301142
Through beam receiver	M12 Connector		NPN	S5N-SA-3-D50-PK	952301541
			PNP	S5N-SA-3-F00-PK	952301152
Through beam emitter	M12 Connector		-	S5N-SA-3-G00-XG	952301212
			NPN	S5N-SA-5-M01-NK	952301351
Background suppression	M12 Connector		PNP	S5N-SA-5-M01-PK	952301271
			PNP	S5N-SA-5-T01-PK	952301241
Retroreflective for transparent	M12 Connector		NPN	S5N-SA-5-T01-NK	952301321

S5N - METAL HOUSING - NO/NC STANDARD OUTPUT & IO-LINK MODELS (S5N-MA...PP/NN/OZ)

Retroreflective	LED, Axial optic	2m Cable	NPN	S5N-MA-2-A00-NN	952022091		
		M12 Connector	PNP	S5N-MA-2-A00-PP	952022081		
NPN			S5N-MA-5-A00-NN	952022111			
Polarized retroreflective		LED, Axial optic	2m Cable	PNP	S5N-MA-5-A00-PP	952022101	
	NPN			S5N-MA-2-B01-NN	952021501		
	M12 Connector		PNP	S5N-MA-2-B01-PP	952021001		
			NPN	S5N-MA-5-B01-NN	952021661		
	LED, Radial optic	2m Cable	PNP	S5N-MA-5-B01-PP	952021201		
			 IO-Link	S5N-MA-5-B01-OZ	952022160		
		M12 Connector	NPN	S5N-MR-2-B01-NN	952021601		
			PNP	S5N-MR-2-B01-PP	952021141		
		2m Cable	NPN	S5N-MR-5-B01-NN	952021761		
			PNP	S5N-MR-5-B01-PP	952021341		
		LASER, Axial optic	2m Cable	NPN	S5N-ML-2-B01-NN	952021821	
				PNP	S5N-ML-2-B01-PP	952021401	
			M12 Connector	NPN	S5N-ML-5-B01-NN	952021851	
				PNP	S5N-ML-5-B01-PP	952021441	
		LASER, Radial optic	2m Cable	 IO-Link	S5N-ML-5-B01-OZ	952022180	
				NPN	S5N-MH-2-B01-NN	952021951	
	M12 Connector		PNP	S5N-MH-2-B01-PP	952021941		
			NPN	S5N-MH-5-B01-NN	952021971		
	2m Cable		PNP	S5N-MH-5-B01-PP	952021961		
			NPN	S5N-MA-2-C01-NN	952021511		
	Long Diffuse proximity		LED, Axial optic	2m Cable	PNP	S5N-MA-2-C01-PP	952021011
					NPN	S5N-MA-5-C01-NN	952021671
		M12 Connector		PNP	S5N-MA-5-C01-PP	952021211	
				 IO-Link	S5N-MA-5-C01-OZ	952022200	
LED, Radial optic		2m Cable	NPN	S5N-MR-2-C01-NN	952021611		
			PNP	S5N-MR-2-C01-PP	952021151		
		M12 Connector	NPN	S5N-MR-5-C01-NN	952021771		
			PNP	S5N-MR-5-C01-PP	952021351		
LASER, Axial optic		2m Cable	NPN	S5N-ML-2-C01-NN	952021831		
			PNP	S5N-ML-2-C01-PP	952021411		
		M12 Connector	NPN	S5N-ML-5-C01-NN	952021861		
			PNP	S5N-ML-5-C01-PP	952021451		
LASER, Radial optic		2m Cable	 IO-Link	S5N-ML-5-C01-OZ	952022190		
			NPN	S5N-MH-2-C01-NN	952021991		
		M12 Connector	PNP	S5N-MH-2-C01-PP	952021981		
			NPN	S5N-MH-5-C01-NN	952022011		
		2m Cable	PNP	S5N-MH-5-C01-PP	952022001		
			NPN	S5N-MA-2-C10-NN	952021521		
		Short Diffuse proximity	LED, Axial optic	2m Cable	PNP	S5N-MA-2-C10-PP	952021021
					NPN	S5N-MA-5-C10-NN	952021681
M12 Connector				PNP	S5N-MA-5-C10-PP	952021221	
				NPN	S5N-MR-2-C10-NN	952021621	
LED, Radial optic			2m Cable	PNP	S5N-MR-2-C10-PP	952021491	
				NPN	S5N-MR-5-C10-NN	952021781	
	M12 Connector		PNP	S5N-MR-5-C10-PP	952021481		
			NPN	S5N-MA-2-C21-NN	952022131		
Medium Diffuse proximity	LED, Axial optic		2m Cable	PNP	S5N-MA-2-C21-PP	952022121	
				NPN	S5N-MA-5-C21-NN	952022151	
			M12 Connector	PNP	S5N-MA-5-C21-PP	952022141	
				NPN	S5N-MA-2-D00-NN	952021531	
	Fixed focus	2m Cable	PNP	S5N-MA-2-D00-PP	952021031		
			NPN	S5N-MA-5-D00-NN	952021691		
		M12 Connector	PNP	S5N-MA-5-D00-PP	952021231		
			NPN	S5N-MR-2-D00-NN	952021631		
Fiber optic	LED, Axial optic	2m Cable	PNP	S5N-MR-2-D00-PP	952021161		
			NPN	S5N-MR-5-D00-NN	952021791		
		M12 Connector	PNP	S5N-MR-5-D00-PP	952021361		
			NPN	S5N-MA-2-E01-NN	952021881		
	Through beam receiver	LED, Axial optic	2m Cable	PNP	S5N-MA-2-E01-PP	952021041	
				NPN	S5N-MA-5-E01-NN	952021891	
			M12 Connector	PNP	S5N-MA-5-E01-PP	952021241	
				NPN	S5N-MA-2-F01-NN	952021541	
		LED, Radial optic	2m Cable	PNP	S5N-MA-2-F01-PP	952021051	
				NPN	S5N-MA-5-F01-NN	952021701	
			M12 Connector	PNP	S5N-MA-5-F01-PP	952021251	
				NPN	S5N-MR-2-F01-NN	952021641	
LASER, Axial optic	2m Cable	PNP	S5N-MR-2-F01-PP	952021171			
		NPN	S5N-MR-5-F01-NN	952021801			
	M12 Connector	PNP	S5N-MR-5-F01-PP	952021371			
		NPN	S5N-ML-2-F01-NN	952021841			
	LASER, Radial optic	2m Cable	PNP	S5N-ML-2-F01-PP	952021421		
			NPN	S5N-ML-5-F01-NN	952021871		
		M12 Connector	PNP	S5N-ML-5-F01-PP	952021461		
			NPN	S5N-MH-2-F01-NN	952022031		
2m Cable	PNP	S5N-MH-2-F01-PP	952022021				
	NPN	S5N-MH-5-F01-NN	952022051				
M12 Connector	PNP	S5N-MH-5-F01-PP	952022041				

S5N - METAL HOUSING - NO/NC STANDARD OUTPUT & IO-LINK MODELS (S5N-MA...PP/NN/OZ)

Through beam emitter	LED, Axial optic	2m Cable	-	S5N-MA-2-G00-XG	952021061
		M12 Connector	-	S5N-MA-5-G00-XG	952021261
	LED, Radial optic	2m Cable	-	S5N-MR-2-G00-XG	952021181
		M12 Connector	-	S5N-MR-5-G00-XG	952021381
	LASER, Axial optic	2m Cable	-	S5N-ML-2-G00-XG	952021431
		M12 Connector	-	S5N-ML-5-G00-XG	952021471
LASER, Radial optic	2m Cable	-	S5N-MH-2-G00-XG	952022061	
	M12 Connector	-	S5N-MH-5-G00-XG	952022071	
Background suppression	LED, Axial optic	2m Cable	NPN	S5N-MA-2-M03-NN	952021551
Background suppression			M12 Connector	PNP	S5N-MA-2-M03-PP
	LED, Radial optic	M12 Connector		 IO-Link	S5N-MA-5-M03-OZ
Retroreflective for transparent			LED, Axial optic	2m Cable	PNP
	M12 Connector	PNP			S5N-MS-5-M03-PP
Retroreflective for transparent		LED, Radial optic	2m Cable	PNP	S5N-MS-2-M03-PP
	M12 Connector			NPN	S5N-MA-2-T01-NN
Retroreflective for transparent		LED, Axial optic	2m Cable	PNP	S5N-MA-2-T01-PP
	M12 Connector			NPN	S5N-MA-5-T01-NN
Retroreflective for transparent		LED, Radial optic	2m Cable	PNP	S5N-MA-5-T01-PP
	M12 Connector			NPN	S5N-MR-2-T01-NN
Retroreflective for transparent		LED, Radial optic	2m Cable	PNP	S5N-MR-2-T01-PP
	M12 Connector			NPN	S5N-MR-5-T01-NN
Retroreflective for transparent		LED, Radial optic	2m Cable	PNP	S5N-MR-5-T01-PP
	M12 Connector			PNP	S5N-MA-5-U03-PP
Luminescence		LED, Axial optic	2m Cable	PNP	S5N-MA-2-W03-PP
Contrast	M12 Connector		NPN	S5N-MA-5-W03-NN	952021751
		Contrast	M12 Connector	PNP	S5N-MA-5-W03-PP

S5N - METAL HOUSING - L/D INPUT MODELS MODELS (S5N-MA...PK/NK)

Retroreflective		M12 Connector	NPN	S5N-MA-5-A00-NK	952701802
			PNP	S5N-MA-5-A00-PK	952701532
Polarized retroreflective		M12 Connector	NPN	S5N-MA-5-B01-NK	952701812
			PNP	S5N-MA-5-B01-PK	952701762
Diffuse proximity	LED, Axial optic	2m Cable	NPN	S5N-MA-2-C01-NK	952701622
			PNP	S5N-MA-2-C01-PK	952701562
		M12 Connector	NPN	S5N-MA-5-C01-NK	952701822
			PNP	S5N-MA-5-C01-PK	952701772
		2m Cable	NPN	S5N-MA-2-C10-NK	952701632
			PNP	S5N-MA-2-C10-PK	952701572
M12 Connector	NPN	S5N-MA-5-C10-NK	952701832		
	PNP	S5N-MA-5-C10-PK	952701522		
Through beam receiver		M12 Connector	NPN	S5N-MA-5-F00-NK	952701842
			PNP	S5N-MA-5-F00-PK	952701782
Through beam emitter	LED, Axial optic	2m Cable	-	S5N-MA-2-G00-XG	952021061
		M12 Connector	-	S5N-MA-5-G00-XG	952021261
	LED, Radial optic	2m Cable	-	S5N-MR-2-G00-XG	952021181
		M12 Connector	-	S5N-MR-5-G00-XG	952021381
	LED, Axial optic	2m Cable	-	S5N-ML-2-G00-XG	952021431
		M12 Connector	-	S5N-ML-5-G00-XG	952021471
	LED, Radial optic	2m Cable	-	S5N-MH-2-G00-XG	952022061
		M12 Connector	-	S5N-MH-5-G00-XG	952022071

S5N - INOX HOUSING - L/D INPUT MODELS MODELS (S5N-NA...)

Polarized retroreflective		M12 Connector	NPN	S5N-NA-5-B01-NK	952301461
			PNP	S5N-NA-5-B01-PK	952301381
Diffuse proximity Inox		M12 Connector	NPN	S5N-NA-5-C11-NK	952301481
			PNP	S5N-NA-5-C11-PK	952301401
Through beam receiver Inox		M12 Connector	NPN	S5N-NA-5-F01-NK	952301511
Through beam emitter inox			PNP	S5N-NA-5-F01-PK	952301431
Background suppression inox		M12 Connector	-	S5N-NA-5-G01-XG	952301441
			NPN	S5N-NA-5-M01-NK	952301501
Retroreflective for transparent inox		M12 Connector	PNP	S5N-NA-5-M01-PK	952301421
			NPN	S5N-NA-5-T01-NK	952301471
Retroreflective for transparent inox		M12 Connector	PNP	S5N-NA-5-T01-PK	952301391

ACCESSORIES

ST-5010

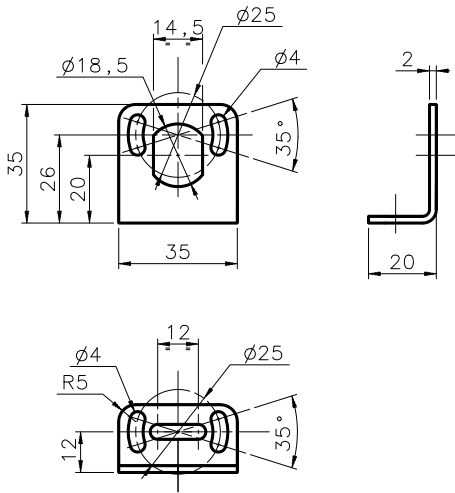

ST-5011

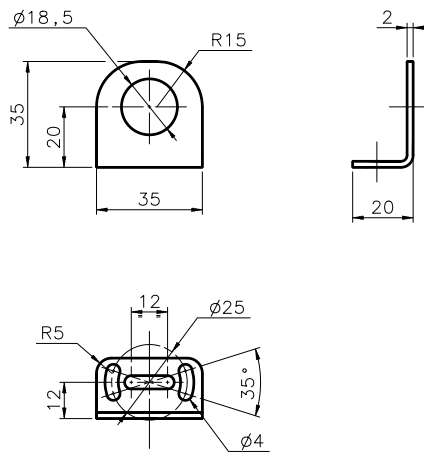

ST-5012

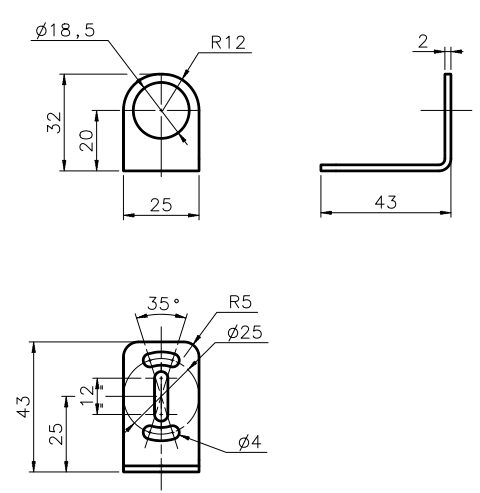

ST-5017

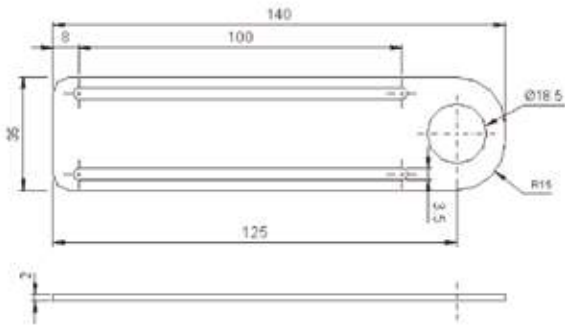

SWING-18

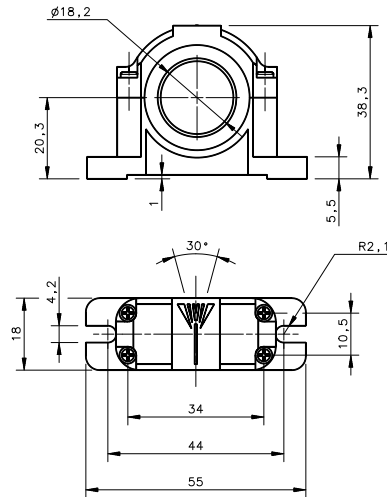

SP-40

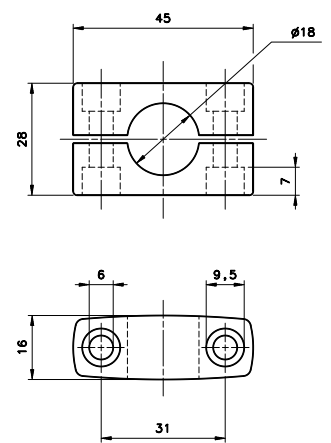

JOINT 18



MICRO 18



MHF



M18 FLARED PLASTIC NUT

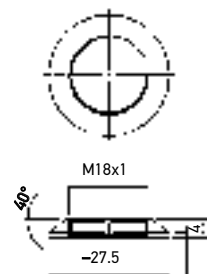

mm

MODEL	DESCRIPTION	ORDER No.
ST-5010	M18/14 mounting bracket	95ACC5230
ST-5011	M18 mounting bracket short	95ACC5240
ST-5012	M18 mounting bracket long	95ACC5250
ST-5017	M18 mounting bracket	95ACC5270
S50 EASY -IN	M18/14 EASY in™ adjustable mounting support	95ACC 5300
JOINT -18	M18 jointed support	95ACC 5220
MICRO -18	support with micrometric regulation for tubular M18 sensors	95ACC 1380
SP-40	mounting bracket tubular	95ACC1370
SWING-18	adjustable support for M18 tubular sensors	895000006
PLASTIC NUT	flared mounting nut	95ACC2630
M18 FLARED NUT	S5N mounting nut M18 flared nut (1 pc)	95ACC2630
M18 METAL NUT	S5N mounting nut M18 nut (1 pc)	G602000017
M18 PLASTIC NUT KIT	S5N mounting nut M18 nuts kit (100 pcs)	G602000008
MEK -PROOF	front protection (only for metal models)	G5000001

IO-LINK CONNECTIVITY

MODEL	DESCRIPTION	ORDER No.
CBX-8IOL-EIP	CBX-8IOL-EIP 8P IOL M12 EIP MASTER	95ACC8180
CBX-8IOL-PNIO	CBX-8IOL-PNIO 8P IOL M12 PROFINET MASTER	95ACC8190

CABLES

TYPE	DESCRIPTION	LENGTH	MODEL	ORDER No.
Axial M12 Connector	4-pole, grey, P.V.C.	3 m	CS-A1-02-G-03	95A251380
		5 m	CS-A1-02-G-05	95A251270
		7 m	CS-A1-02-G-07	95A251280
		10 m	CS-A1-02-G-10	95A251390
	4-pole, P.U.R.	2 m	CS-A1-02-R-02	95A251540
		5 m	CS-A1-02-R-05	95A251560
Radial M12 Connector	4-pole, grey, P.V.C.	3 m	CS-A2-02-G-03	95A251360
		5 m	CS-A2-02-G-05	95A251240
		7 m	CS-A2-02-G-07	95A251245
		10 m	CS-A2-02-G-10	95A251260
	4-pole, P.U.R.	2 m	CS-A2-02-R-02	95A251550
		5 m	CS-A2-02-R-05	95A251570
Radial M12 Connector with LED (for PNP N.O. sensors)	4-pole, grey, P.V.C.	3 m	CS-A2-12-G-03	95A251400
		5 m	CS-A2-12-G-05	95A251350
		10 m	CS-A2-12-G-10	95A251370
Axial M12 Connector	4-pole, shielded, black, P.V.C.	3 m	CV-A1-22-B-03	95ACC1480
		5 m	CV-A1-22-B-05	95ACC1490
		10 m	CV-A1-22-B-10	95ACC1500
		15 m	CV-A1-22-B-15	95ACC2070
		25 m	CV-A1-22-B-25	95ACC2090
Radial M12 Connector	4-pole, shielded, black, P.V.C.	3 m	CV-A2-22-B-03	95ACC1540
		5 m	CV-A2-22-B-05	95ACC1550
		10 m	CV-A2-22-B-10	95ACC1560
Axial M12 Connector	4-pole, U.L., black, P.V.C.	3 m	CS-A1-02-U-03	95ASE1120
		5 m	CS-A1-02-U-05	95ASE1130
		10 m	CS-A1-02-U-10	95ASE1140
		15 m	CS-A1-02-U-15	95ASE1150
		25 m	CS-A1-02-U-25	95ASE1160
	4-pole, black	Connector- not cabled	CS-A1-02-B-NC	G5085002
Radial M12 Connector	4-pole, black	Connector- not cabled	CS-A2-02-B-NC	G5085003
Axial M12 Connector	5-pole, L coded power cable	3 m	CS-M1-02-B-03	95ACC0007
Axial M12 F/M12 M Connector	4-pole, double headed	3 m	CS-I1-02-B-03	95ACC0009

00,11/2021

DATALOGIC PRODUCT OFFERING



Sensors



Hand Held scanners



Mobile Computers

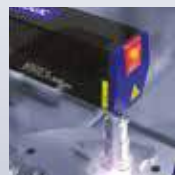

Laser Marking Systems



Safety Laser Scanner



Vision Systems



Stationary Industrial Scanners



Safety Light Curtains



S5N-PA/MA...U

Luminescence sensor

INSTRUCTION MANUAL

CONTROLS

OUTPUT LED

The yellow LED ON indicates that the N.O. (normally open) output status is closed.

READY/ERROR LED (bicolour)

When the bicoloured LED is continuously green, the sensor is operating in a normal condition and it is ready to function correctly (stability condition).

The red and green blinking of the LED indicates a wrong sensor setting. Please refer to the "SETTING" paragraph to get the correct setting procedure.

SET PUSHBUTTON

A long pressure on the pushbutton activates the self-setting procedure.

INSTALLATION

S5N-PA...U: The sensor can be fixed by means of the M18x1 threaded body through a \varnothing 18 mm hole, using the specific washer and the enclosed 24 mm nuts (maximum torque of tightening 1.5 Nm). Alternatively, the sensor can be mounted through the two housing's holes using two screws (M3x22 or longer) and nuts.

Amongst the various possible solutions, we suggest to choose the combination that offers the best visibility of the signalling LEDs and the easiest access to the SET pushbutton.

22 mm nuts, h=8 mm, (2 Nm maximum tightening torque) are available to guarantee an improved torque.

S5N-MA...U: The sensor can be fixed by means of the M18x1 threaded body through a \varnothing 18 mm hole, using the specific washer and the two CH.24 nuts enclosed (22 Nm maximum tightening torque).

For both plastic version and metallic version are available various orientable fixing brackets to ease the sensor positioning (please refer to the accessories listed in the general catalogue).

The operating distance is measured from the front surface of the sensor lens.

To detect luminescent marks on reflective surfaces, position the sensor axis at 10° ... 15° respect to the orthogonal line of the surface to detect.

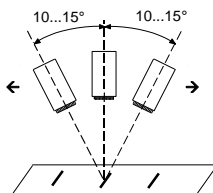

CONNECTIONS

The connections are compliant to the EN 60947-5-2 standard.

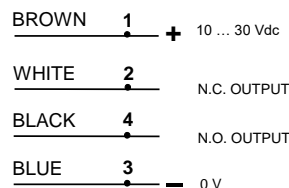

M12 CONNECTOR

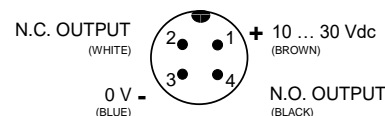

DIMENSIONS

S5N-PA VERSIONS

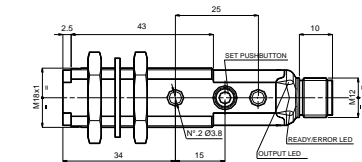
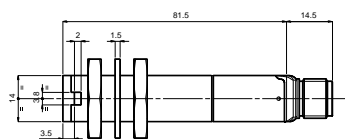

CABLE VERSION

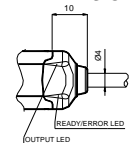

S50-MA VERSIONS

S5N-MA VERSIONS

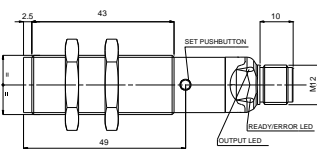
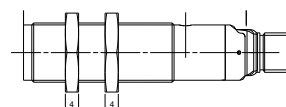

CABLE VERSION

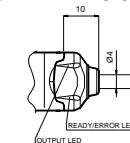

TECHNICAL DATA

	S5N-PA PLASTIC VERSIONS	S5N-MA METALLIC VERSIONS
Power supply:	10 ... 30 Vdc (limit values)	
Ripple:	2 Vpp max.	
Current consumption (output current excluded):	25 mA max.	
Outputs:	N.O. and N.C.; PNP or NPN (short-circuit protection)	
Output current:	100 mA max.	
Output saturation voltage:	2 V max.	
Response time:	500 μ s	
Switching frequency:	1 kHz	
Indicators:	OUTPUT LED (YELLOW) / READY/ERROR LED (GREEN/RED)	
Setting:	SET pushbutton	
Operating mode:	LIGHT mode on N.O. output / DARK mode on N.C. output	
Data retention:	non volatile EEPROM memory	
Operating temperature:	-10 ... 55 $^{\circ}$ C	
Storage temperature:	-20 ... 70 $^{\circ}$ C	
Insulating strength:	500 Vac 1 min., between electronics and housing	
Insulating resistance:	>20 M Ω 500 Vdc, between electronics and housing	
Operating distance (typical values):	8...20mm range, maximum signal at 10 mm	
Minimum spot dimension:	3mm	
Emission type:	LED UV (370 nm)	
Ambient light rejection:	according to EN 60947-5-2	
Vibrations:	0.5 mm amplitude, 10 ... 55 Hz frequency, for every axis (EN60068-2-6)	
Shock resistance:	11 ms (30 G) 6 shock for every axis (EN60068-2-27)	
Housing material:	PBT	Nickel plated brass
Lens material:	PMMA	
Mechanical protection:	IP67 Metal versions type 1 enclosure	
Connections:	2 m cable \varnothing 4 mm / M12 - 4 pole connector	
Weight:	75 g. max. cable vers. 25 g. max. connector vers.	110 g. max. cable vers. 60 g. max. connector vers.
AtEx 2014/34/EU	II 3D EX tc IIIC IP67 T85 $^{\circ}$ C	

SETTING

The supplied sensor is set at the maximum sensitivity, allowing the detection of the minimum luminescence intensity. No other setting procedure is necessary, unless luminescent objects placed on luminescence backgrounds have to be detected.

EASY TOUCH™

The sensor uses the patent-covered EASY TOUCH™ technology that allows a rapid and safe self-setting of the product.

Two different setting possibilities are available:

- **EASY TOUCH™**; a long pressure of the SET pushbutton allows self-setting.
- **FINE DETECTION**; to be used only in particularly critical conditions, this setting procedure is used only when the EASY TOUCH™ is not sufficient.

Setting of S5N-PA/MA...U

To achieve a correct sensor functioning, the luminescence mark or object to be detected has to be placed at the right reading distance.

- **EASY TOUCH™ (standard detection in the LIGHT mode)**

The EASY TOUCH™ technology allows the functioning in the LIGHT mode (mark presents a higher luminescence respect to the background).

The mark to detect has to be placed correctly at the right reading distance within the sensor spot.

Press the SET pushbutton until the READY/ERROR LED turns OFF. Release the SET pushbutton and wait for the READY/ERROR LED to turn green.

The sensor is now ready to detect the pre-set luminescent mark or object (output LED turns ON when the NO output is closed).

Note: The automatic EASY TOUCH™ setting has to be performed without any objects inside the sensor reading range (or using a non-luminescent object) in order to bring the sensor back to the maximum sensitivity condition.

- **Fine detection (DARK or LIGHT mode)**

This mode offers an improved detection precision and also allows the detection of luminescent marks or objects placed on luminescent backgrounds.

The operating mode is selected automatically by the sensor:

DARK operating mode (mark presents a lower luminescence respect to the background) or LIGHT operating mode (mark presents a higher luminescence respect to the background).

The mark to detect has to be placed correctly at the right reading distance within the sensor spot.

Press the SET pushbutton. The READY/ERROR LED turns OFF. Keep the SET pushbutton pressed until the READY/ERROR LED blinks green. Place the background under the sensor spot.

Press the SET pushbutton again until the READY/ERROR LED turns OFF. The sensor is now ready to detect, with a very high precision, the pre-set luminescent mark (output LED turns ON, READY/ERROR LED turns green).

Datalogic S.r.l.

Via S. Vitale 13 - 40012 Calderara di Reno - Italy
 Tel. +39 051 3147011 - Fax: +39 051 3147205 - www.datalogic.com

Helpful links at www.datalogic.com: **Contact Us, Terms and Conditions, Support.**



For information about the disposal of Waste Electrical and Electronic Equipment (WEEE), please refer to the website at www.datalogic.com

© 2007 - 2020 Datalogic S.p.A. and/or its affiliates • ALL RIGHTS RESERVED. • Without limiting the rights under copyright, no part of this documentation may be reproduced, stored in or introduced into a retrieval system, or transmitted in any form or by any means, or for any purpose, without the express written permission of Datalogic S.p.A. and/or its affiliates. Datalogic and the Datalogic logo are registered trademarks of Datalogic S.p.A. in many countries, including the U.S.A. and the E.U. All other trademarks and brands are property of their respective owners. Datalogic reserves the right to make modifications and improvements without prior notification.