





# PX

-  **Manometri e vuotometri a polmone bassa pressione cassa INOX**
-  Diaphragm gauges and vacuum gauges low pressure INOX case
-  Manometer und Vakuummeter niederdruck Edelstahl Gehäuse
-  Manomètres et vacuomètres avec réservoir basse pression INOX
-  Manómetros y vacuómetros con tanque de baja presión INOX





## PX54



## PX56



### **Dati tecnici di manometri e vuotometri a polmone bassa pressione cassa INOX**

-  Diaphragm gauges and vacuum gauges low pressure INOX case technical data
-  Technischen Daten der Manometer und Vakuummeter niederdruck Edelstahl Gehäuse
-  Données techniques des manomètres et vacuomètres avec réservoir basse pression INOX
-  Datos técnicos de los manómetros y vacuómetros con tanque de baja presión INOX

### **Applicazioni**

Misurano le basse pressioni dai 25 ai 600 mBar.

### **Applications**

Ils mesurent les basses pressions de 25 à 600 mbar.

### **Applications**

Casing gauge for low pressure from 25 to 600 mBar.

### **Aplicaciones**

Miden bajas presiones de 25 a 600 mBar.

### **Anwendungen**

Messung niedriger Drücke von 25 bis 600 mBar.

### **Caratteristiche principali**

Manometro costruito secondo le Norme UNI EN 873.3  
Cassa INOX AISI 304 dn 63  
Perno e movimento in OTTONE OT58 attacco POSTERIORE (ISO 228) quadrante in alluminio scale in mBar, lancetta in alluminio nera. Classe di precisione 1,6%.

### **Principales caractéristiques**

Manomètre construit selon les normes UNI EN 873.3.  
Acier inoxydable AISI 304 dn 63.  
Goupille et mouvement en face arrière de la balance en aluminium OTTONE OT58 REAR (ISO 228) en mBar, aiguille en aluminium noir. Classe de précision 1,6%.

### **Main features**

Pressure gauge built according to the UNI EN 873.3 Standards. Stainless steel AISI 304 dn 63.  
Pin and movement in OTTONE OT58 REAR attachment (ISO 228) aluminum scale face in mBar, black aluminum hand. Accuracy class 1.6%.

### **Características principales**

Manómetro construido según las normas UNI EN 873.3.  
Acero inoxidable AISI 304 dn 63.  
Pin y movimiento en OTTONE OT58 REAR accesorio (ISO 228) Cara de escala de aluminio en mBar, mano de aluminio negro. Clase de precisión del 1,6%.

### **Hauptmerkmale**

Manometer nach UNI EN 873.3 gebaut. Edelstahl AISI 304 dn 63.  
Stift und Uhrwerk in OTTONE OT58 HINTEN (ISO 228) Alu-Skala in mBar, schwarze Aluminiumhand. Genauigkeitsklasse 1,6%.

### **Esercizio**

Pressione esercizio MAX 75% VFS x 15 min  
Sovrapressione NON AMMESSA  
Temperatura d'esercizio -20°C / + 60°C

### **Exercice**

Pression de service MAX 75% VFS x 15 min  
Surpression NON ADMIS  
Température de fonctionnement -20°C / + 60°C

### **Working**

Max working pressure 75% FSV for 15 min.  
Overpressure NOT ADMITTED  
Working temperature -4°F / +140°F

### **Ejercicio**

Presión de funcionamiento MAX 75% VFS x 15 min  
Sobrepresión NO ADMITIDA  
Temperatura de funcionamiento -20°C / + 60°C

### **Ausüben**

Max. Betriebsdruck 75% VFS x 15 min  
Überdruck NICHT ZUGELASSEN  
Betriebstemperatur -20°C / + 60 °C

### **Varianti**

Scale Normalizzate Pressione o Vuoto 25; 60; 100; 160; 250; 400; 600 mBar

### **Variantes**

Échelles normalisées ou de pression 25; 60; 100; 160; 250; 400; 600 mBar

### **Variants**

Normalized range Pressure or Vacuum 25; 60; 100; 160; 250; 400; 600 mBar

### **Variantes**

Escalas normalizadas o de presión 25; 60; 100; 160; 250; 400; 600 mBar

### **Varianten**

Skala normalisiert Druck oder Vakuum 25; 60; 100; 160; 250; 400; 600 mBar

## Opzioni prodotto

Scale e/o attacchi personalizzati, loghi, settori colorati.  
Attacco Radiale ad ore 3/9/12.

## Options du produit

Balances et / ou pièces jointes personnalisées, logos, secteurs colorés.  
Attaque radiale au 3/9/12.

## Product options

Customize range, scale or logo; colored sector.  
Bottom connection at 3/9/12 hours.

## Opciones de productos

Escalas y / o adjuntos personalizados, logotipos, sectores coloreados.  
Ataque radial al 3/9/12.

## Produkt-Optionen

Skalen und / oder Anhänge individuelle Logos, farbigen Sektoren.  
Radial Anschluss an 3/9/12 Stunden.

## PX 54

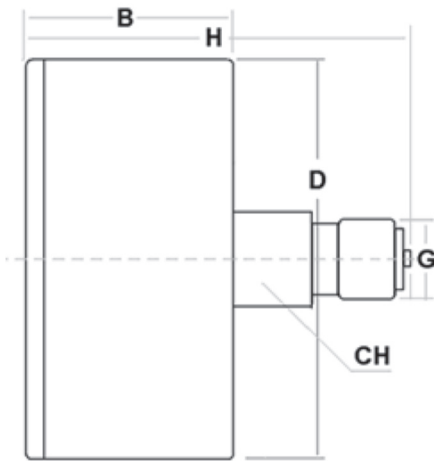

### Vuotometri a polmone bassa pressione attacco posteriore cassa INOX

- Vacuum gauges low pressure back connection INOX case
- Vakuummeter niederdruck zuruck Angriff Edelstahl Gehäuse
- Jauge à vide basse pression raccord arrière centré INOX
- Vacuómetro posterior INOX baja presión

CODICE/CODE	SCALA/RANGE	PRECISIONE/ACCURACY	PEZZI/PIECES
PX5463140400P	-400 / 0 mbar	C.L.1,6	1
PX5463140250P	-250 / 0 mbar	C.L.1,6	1
PX5463140160P	-160 / 0 mbar	C.L.1,6	1
PX5463140100P	-100 / 0 mbar	C.L.1,6	1

Ø	B	D	D1	H	G	CH
63	32	61,2	69	61	G1/4	14

## PX 56

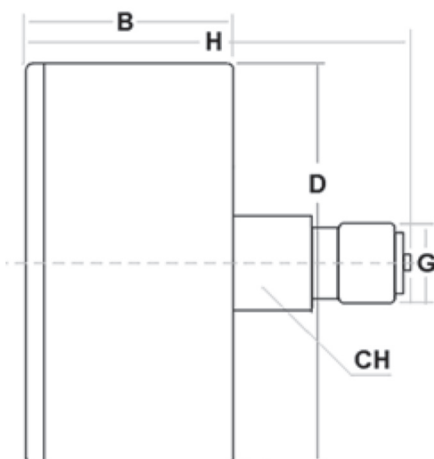

### Manometri a polmone bassa pressione attacco posteriore cassa INOX

- Diaphragm gauges low pressure back connection INOX case
- Manometer niederdruck zuruck Angriff Edelstahl Gehäuse
- Manomètre basse pression, raccord arrière centré INOX
- Manómetro posterior INOX baja presión

CODICE/CODE	SCALA/RANGE	PRECISIONE/ACCURACY	PEZZI/PIECES
PX5663140025P	0 / 25 mbar	C.L.1,6	1
PX5663140060P	0 / 60 mbar	C.L.1,6	1
PX5663140100P	0 / 100 mbar	C.L.1,6	1
PX5663140250P	0 / 250 mbar	C.L.1,6	1
PX5663140400P	0 / 400 mbar	C.L. 1,6	1
PX5663140600P	0 / 600 mbar	C.L. 1,6	1

Ø	B	D	D1	H	G	CH
63	32	61,2	69	61	G1/4	14