

MX



Manometri e vuotometri interamente INOX



Gauges and vacuum gauges complete INOX



Manometer und Vakuummeter vollständig Edelstahl



Manomètres et manomètres à vide entièrement INOX



Manómetros y vacuómetros completamente INOX

MX82



MX83



MX84



MX92



MX93



MX94



MX99



Dati tecnici di manometri e vuotometri interamente INOX



Gauges and vacuum gauges complete INOX technical data



Technischen Daten der Manometer und Vakuummeter vollständig Edelstahl



Données techniques des manomètres et manomètres à vide entièrement INOX



Datos técnicos de los manómetros y vacuómetros completamente INOX

• MX82



Applicazioni

Adatti per tutti gli impieghi dove esistono processi corrosivi. Tutte le applicazioni particolari (attacchi, quadranti, scale non normalizzate) possono essere risolte dalle nostre officine.

Ampla disponibilità di magazzino.



Applications

Convient à toutes les utilisations où des processus corrosifs existent. Toutes les applications spéciales (accessoires, cadrans, balances non normalisées) peuvent être résolues par nos ateliers.

Ample disponibilité des stocks.



Applications

Suitable for corrosive process gas or liquid. With liquid filled case for applications with high dynamic pressure pulsations or vibrations. Chemical/petrol-chemical, power stations, mining, on- and offshore, environmental technology, mechanical engineering and plant construction.

Our workshop is able to solve all your request.



Aplicaciones

Adecuado para todos los usos donde existan procesos corrosivos. Nuestros talleres pueden resolver todas las aplicaciones especiales (accesorios, cuadrantes, escalas no normalizadas).

Amplia disponibilidad de stock.



Anwendungen

Geeignet für alle Anwendungen, bei denen es korrosiven Prozessen. Alle spezielle Anwendungen (Ports, Zifferblätter, Skalen Nicht-Standard) können von unseren Workshops gelöst werden.

Die weite Verfügbarkeit von Lager.



Caratteristiche principali

Manometro costruito secondo Norme UNI EN 837.1 TUTTO INOX cassa AISI 304 IP65 dn 63 - 100 mm. Perno e movimento in AISI 316 attacco RADIALE (ISO 228). Per d63: trasparente in policarbonato, quadrante in alluminio fondo bianco scala BAR, nera e PSI rossa (doppia scala esclusi mano vuotometri). Classe di precisione 2,5 - 1,6% - Lancetta in Alluminio.

Per d100: trasparente in vetro stratificato di sicurezza, con tappo posteriore di sicurezza scala in BAR. Classe di precisione 1.0% - lancetta in alluminio micrometrica aggiustabile.



Principales caractéristiques

Manomètre construit selon les normes UNI EN 837.1 TOUT ACIER INOXYDABLE AISI 304 IP65 DN 63 - 100 mm. Broche et mouvement dans une connexion RADIAL AISI 316 (ISO 228).

Pour d63: polycarbonate transparent, cadran en aluminium avec échelle inférieure blanche, échelle BAR, noir et rouge en PSI (échelle double excluant les manomètres à vide). Classe de précision 2,5 - 1,6% - Main en aluminium.

Pour d100: verre de sécurité feuilleté transparent, avec capuchon de sécurité arrière Escalier BAR. Classe de précision 1,0% - aiguille micrométrique en aluminium ajustable.



Main features

All stainless steel pressure gauge made according UNI EN 837.1 norms case AISI 304 dial 63-100 mm. Stainless steel AISI 316 movement and pivot BOTTOM (ISO 228) connection.

For d63: - Aluminium dial White background Black BAR scale and Red PSI one (double scale except compound gauge) - Accuracy 2,5, 1,6% - Aluminium index.

For d100: safety glass window with back blow out cap, aluminum dial white background black BAR scale, accuracy 1.0% - Micrometric adjustable aluminum index.



Características principales

Manómetro fabricado según las normas UNI EN 837.1. TODO ACERO INOXIDABLE AISI 304 IP65 dn 63 - 100 mm. Pin y movimiento en la conexión AISI 316 RADIAL (ISO 228).

Para d63: policarbonato transparente, esfera de aluminio con fondo blanco. Escala BAR, PSI negro y rojo (doble escala, excluidos los manómetros de mano). Clase de precisión 2.5 - 1.6% - Manecilla de aluminio.

Para d100: vidrio laminado transparente de seguridad, con tapa de seguridad trasera. Escalera BAR. Clase de precisión 1.0% - Manecilla micrométrica ajustable de aluminio.







Hauptmerkmale

Gebaut nach UNI EN 837,1, komplett Edelstahl AISI 304 IP65 Gehäuse DN 63 bis 100 mm. Stift und Bewegung in AISI 316, RADIAL Angriff (ISO 228).

Für d63: aus transparentem Polycarbonat, Aluminium-Zifferblatt mit weißem Hintergrund, Maßstab BAR schwarz und rot PSI (zwei Skalen Vakuummeter ausgeschlossen). Genauigkeitsklasse 2,5 bis 1,6%, - Aluminium Hand.

Für d100: transparent VSG, mit Kappe posteriore Sicherheit, Skalierbarkeit BAR, Genauigkeitsklasse 1,0% - hand Aluminium Feineinstellung.

 Pressione e temperatura	 Pressure and Temperature	 Druck und Temperatur	 Pression et Température	 Presión y Temperatura
Costante 75% - Variabile 60% - Sovrapressione 25% fino a 60 bar, 15% oltre	Steady 75% - Variable 60% - Overpressure 25% until 60 bar, 15% over	Konstant 75% - Variable 60% - 25% Überdruck bis 60 bar, mehr als 15%	Constante 75% - Variable 60% - Surpression 25% jusqu'à 60 bar, 15% de plus	Constante 75% - Variable 60% - Sobre-presión 25% hasta 60 bar, 15% más
Temperatura ambiente: -30°C / +65°C	Temperature environment -22°F / +149°F	Temperatur Umwelt -30°C / +65°C	Température environnement: -30°C / +65°C	Temperatura medio ambiente: -30°C / +65°C
Temperatura processo: -40°C / +180°C	Temperature process: -40°F / +356°F	Temperatur prozess: -40°C / +180°C	Température processus: -40°C / +180°C	Temperatura proceso: -40°C / +180°C

Varianti

D63:
Scale Normalizzate:
Vuotometro -1 / 0 Bar+CmHg;
Manovuotometro -1+0,6; -1+1,5; -1+3; -1+5; -1+9; -1+15 solo Bar; 0,6; 1; 1,6; 2,5; 4; 6; 10; 12; 16; 25; 40; 60; 100; 160; 250; 315; 400 Bar + Psi

D100:
Scale Normalizzate: -1 / 0; -1+0,6; -1+1,5; -1+3; -1+5; -1+9; -1+15; 1; 1,6; 2,5; 4; 6; 10; 16; 25; 40; 60; 100; 160; 250; 400; 600; 1000; 1600 bar

Variantes

D63:
Échelles normalisées:
Vacuomètre -1 / 0 Bar + CmHg;
Manvuotometro -1 + 0,6; -1 + 1,5; -1 + 3; -1 + 5; -1 + 9; -1 + 15 bar seulement; 0,6; 1; 1,6; 2,5; 4; 6; 10; 12; 16; 25; 40; 60; 100; 160; 250; 315; 400 Bar + Psi

D100:
Échelles normalisées: -1 / 0; -1 + 0,6; -1 + 1,5; -1 + 3; -1 + 5; -1 + 9; -1 + 15; 1; 1,6; 2,5; 4; 6; 10; 16; 25; 40; 60; 100; 160; 250; 400; 600; 1000; 1600 bar

Variants

D63:
Normalized scales:
Vacuum meter -1 / 0 Bar + CmHg;
Manvuotometro -1 + 0,6; -1 + 1,5; -1 + 3; -1 + 5; -1 + 9; -1 + 15 Bar only; 0,6; 1; 1,6; 2,5; 4; 6; 10; 12; 16; 25; 40; 60; 100; 160; 250; 315; 400 Bar + Psi

D100:
Normalized scales: -1 / 0; -1 + 0,6; -1 + 1,5; -1 + 3; -1 + 5; -1 + 9; -1 + 15; 1; 1,6; 2,5; 4; 6; 10; 16; 25; 40; 60; 100; 160; 250; 400; 600; 1000; 1600 bar

Variantes

D63:
Escalas normalizadas:
Medidor de vacío -1 / 0 Bar + CmHg;
Manvuotometro -1 + 0,6; -1 + 1,5; -1 + 3; -1 + 5; -1 + 9; -1 + 15 Bar solamente; 0,6; 1; 1,6; 2,5; 4; 6; 10; 12; 16; 25; 40; 60; 100; 160; 250; 315; 400 Bar + Psi

D100:
Escalas normalizadas: -1 / 0; -1 + 0,6; -1 + 1,5; -1 + 3; -1 + 5; -1 + 9; -1 + 15; 1; 1,6; 2,5; 4; 6; 10; 16; 25; 40; 60; 100; 160; 250; 400; 600; 1000; 1600 bar

Varianten

D63:
Normalisierte Skalen:
Vakuummeter -1 / 0 Bar + CmHg;
Manvuotometro -1 + 0,6; -1 + 1,5; 1 + 3; -1 + 5; -1 + 9; -1 + 15 bar nur; 0,6; 1; 1,6; 2,5; 4; 6; 10; 12; 16; 25; 40; 60; 100; 160; 250; 315; 400 Bar + Psi

D100:
Normalisierte Skalen: -1 / 0; -1 + 0,6; -1 + 1,5; 1 + 3; -1 + 5; -1 + 9; -1 + 15; 1; 1,6; 2,5; 4; 6; 10; 16; 25; 40; 60; 100; 160; 250; 400; 600; 1000; 1600 bar

Opzioni prodotto

Filetto NPT ANSI B.1.20.1 con o senza glicerina, Sgrassatura uso ossigeno, scale e/o attacchi personalizzati, loghi, settori colorati, vetro di sicurezza (d100), esecuzione SOLID FRONT (d100), separatori (d100), contatti elettrici (d100), attacco radiale ad ore 3/9/12.

Options du produit

Filetage ANSI NPT B.1.20.1 avec ou sans glycérine, Dégraissage pour utilisation d'oxygène, balances et/ou accessoires personnalisés, logos, secteurs colorés, verre de sécurité (d100), SOLID FRONT (d100), séparateurs (d100), contacts électriques (d100), connexion radiale au 3/9/12.

Product options

NPT ANSI B.1.20.1 thread, With or without glycerine, OXYGENE SERVICE customize range, scale or logo; Colored sector; SAFETY glass, SOLID FRONT production, radial connection 3/9/12 hours.

Opciones de productos

ANSI NPT hilo B.1.20.1 con o sin glicerina, Desengrasante para uso de oxígeno, básculas y/o accesorios personalizados, logotipos, sectores coloreados, vidrio de seguridad (d100), FRENTE SÓLIDO (d100), separadores (d100), contactos eléctricos (d100), conexión radial al 3/9/12.

Produkt-Optionen

Gewinde NPT ANSI B.1.20.1 mit oder ohne Glycerin, Entfetten Verwendung Sauerstoff, Treppen Angriffen e70 individuelle Logos, farbige Einheiten, Sicherheitsglas (d100), läuft SOLID FRONT (d100), Abscheider (d100), elektrische Kontakte (d100), Stunden 3/9/12 Stunden.

MXX 82

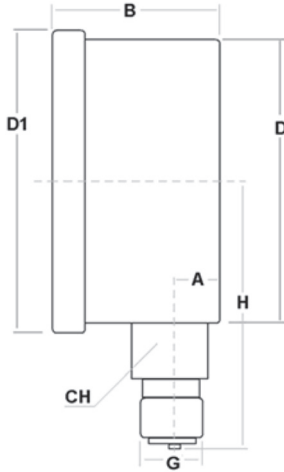

Manometri a secco attacco radiale

- Gauges bottom connection
- Manometer radial Angriff
- Manomètre, raccord vertical
- Manómetro radial

- Vuotometro** Vacuum Gauge Vakuummeter
 Vacuomètre Vacuómetro

CODICE/CODE	Ø	ATTACCO CONNECTION	SCALA RANGE	PRECISIONE ACCURACY	PEZZI PIECES
MXX826314099R	63	G1/4	-1 / 0	C.L.1,6	1

- Manometro** Gauges Manometer
 Manomètre Manómetro

CODICE/CODE	Ø	ATTACCO CONNECTION	SCALA RANGE	PRECISIONE ACCURACY	PEZZI PIECES
MXX826314Z06R	63	G1/4	0 / +0,6	C.L.1,6	1
MXX826314001R	63	G1/4	0 / +1	C.L.1,6	1
MXX826314106R	63	G1/4	0 / +1,6	C.L.1,6	1
MXX826314205R	63	G1/4	0 / +2,5	C.L.1,6	1
MXX826314004R	63	G1/4	0 / +4	C.L.1,6	1
MXX826314006R	63	G1/4	0 / +6	C.L.1,6	1
MXX826314010R	63	G1/4	0 / +10	C.L.1,6	1
MXX826314016R	63	G1/4	0 / +16	C.L.1,6	1
MXX826314025R	63	G1/4	0 / +25	C.L.1,6	1
MXX826314040R	63	G1/4	0 / +40	C.L.1,6	1
MXX826314060R	63	G1/4	0 / +60	C.L.1,6	1
MXX826314100R	63	G1/4	0 / +100	C.L.1,6	1
MXX826314160R	63	G1/4	0 / +160	C.L.1,6	1
MXX826314250R	63	G1/4	0 / +250	C.L.1,6	1
MXX826314400R	63	G1/4	0 / +400	C.L.1,6	1
MXX826314600R	63	G1/4	0 / +600	C.L.1,6	1

Ø	A	B	D	D1	H	G	CH	Kg
63	10	31	62	66	54	G1/4	14	0,136

MXX 82

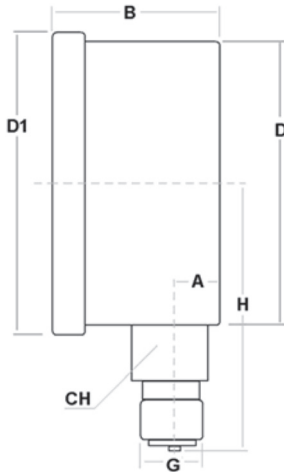

Manometri a secco attacco radiale

- Gauges bottom connection
- Manometer radial Angriff
- Manomètre, raccord vertical
- Manómetro radial

- Vuotometro**
- Vacuum Gauge
- Vakuummeter
- Vacuomètre
- Vacuómetro

CODICE/CODE	Ø	ATTACCO CONNECTION	SCALA RANGE	PRECISIONE ACCURACY	PEZZI PIECES
MXX821012099R	100	G1/2	-1 / 0	C.L.1,0	1

- Manovuotometro**
- Compound
- Manovakuummeter
- Manovacuumètre
- Manovacúometro

CODICE/CODE	Ø	ATTACCO CONNECTION	SCALA RANGE	PRECISIONE ACCURACY	PEZZI PIECES
MXX821012115R	100	G1/2	-1 / +1,5	C.L.1,0	1
MXX821012903R	100	G1/2	-1 / +3	C.L.1,0	1
MXX821012905R	100	G1/2	-1 / +5	C.L.1,0	1
MXX821012909R	100	G1/2	-1 / +9	C.L.1,0	1

- Manometro**
- Gauges
- Manometer
- Manomètre
- Manómetro

CODICE/CODE	Ø	ATTACCO CONNECTION	SCALA RANGE	PRECISIONE ACCURACY	PEZZI PIECES
MXX821012Z06R	100	G1/2	0 / +0,6	C.L.1,0	1
MXX821012001R	100	G1/2	0 / +1	C.L.1,0	1
MXX821012106R	100	G1/2	0 / +1,6	C.L.1,0	1
MXX821012205R	100	G1/2	0 / +2,5	C.L.1,0	1
MXX821012004R	100	G1/2	0 / +4	C.L.1,0	1
MXX821012006R	100	G1/2	0 / +6	C.L.1,0	1
MXX821012010R	100	G1/2	0 / +10	C.L.1,0	1
MXX821012016R	100	G1/2	0 / +16	C.L.1,0	1
MXX821012025R	100	G1/2	0 / +25	C.L.1,0	1
MXX821012040R	100	G1/2	0 / +40	C.L.1,0	1
MXX821012060R	100	G1/2	0 / +60	C.L.1,0	1
MXX821012100R	100	G1/2	0 / +100	C.L.1,0	1
MXX821012160R	100	G1/2	0 / +160	C.L.1,0	1
MXX821012250R	100	G1/2	0 / +250	C.L.1,0	1
MXX821012400R	100	G1/2	0 / +400	C.L.1,0	1
MXX821012600R	100	G1/2	0 / +600	C.L.1,0	1
MXX821012Z00R	100	G1/2	0 / +1000	C.L.1,0	1

Ø	A	B	D	D1	H	G	CH	Kg
100	28	59	101	110	86	G1/2	22	1

Dati tecnici di manometri e vuotometri interamente INOX

 Gauges and vacuum gauges complete INOX technical data

 Technischen Daten der Manometer und Vakuummeter vollständig Edelstahl

 Données techniques des manomètres et manomètres à vide entièrement INOX

 Datos técnicos de los manómetros y vacuómetros completamente INOX

• MXX 83

Applicazioni

Adatti per tutti gli impieghi dove esistono processi corrosivi. Tutte le applicazioni particolari (attacchi, quadranti, scale non normalizzate) possono essere risolte dalle nostre officine. Ampia disponibilità di magazzino.

Applications

Convient à toutes les utilisations où des processus corrosifs existent. Toutes les applications spéciales (accessoires, cadrans, balances non normalisées) peuvent être résolues par nos ateliers. Ample disponibilité des stocks.

Anwendungen

Suitable for corrosive process gas or liquid. With liquid filled case for applications with high dynamic pressure pulsations or vibrations. Chemical/petrol-chemical, power stations, mining, on- and offshore, environmental technology, mechanical engineering and plant construction. Our workshop is able to solve all your request.

Applications

Geeignet für alle Anwendungen, bei denen es korrosiven Prozessen. Alle spezielle Anwendungen (Ports, Zifferblätter, Skalen Nicht-Standard) können von unseren Workshops gelöst werden. Die weite Verfügbarkeit von Lager.

Aplicaciones

Adecuado para todos los usos donde existan procesos corrosivos. Nuestros talleres pueden resolver todas las aplicaciones especiales (accesorios, cuadrantes, escalas no normalizadas). Amplia disponibilidad de stock.

Caratteristiche principali

Manometro costruito secondo Norme UNI EN 837.1 TUTTO INOX cassa AISI 304 IP65 dn 63 mm trasparente in policarbonato. Perno e movimento in AISI 316 attacco POSTERIORE (ISO228). Quadrante in alluminio fondo bianco scala BAR nera e PSI rossa (doppia scala esclusi mano vuotometri). Classe di precisione 2,5 - 1,6% - Lancetta in Alluminio.

Principales características

Manomètre construit selon les normes UNI EN 837.1 TOUT EN AISI 304 IP65 dn Boitier en polycarbonate transparent de 63 mm. Goupille et mouvement dans l'attache ARRIÈRE AISI 316 (ISO228). Cadran en aluminium échelle inférieure blanche BAR noir et rouge PSI (échelle double excluant les manomètres à vide). Classe de précision 2,5 - 1,6% - Main en aluminium.

Main features





Pressure gauge made according UNI EN 837.1 norms Stainless steel case AISI 304 dial 63 mm. BRASS movement and pivot BACK (ISO 228) connection - Aluminium dial White background Black BAR scale and Red PSI one (double scale except compoud gauge). Accuracy 2,5, 1,6% - Aluminum index.

Características principales

Manómetro fabricado según las normas UNI EN 837.1 TODO AISI 304 IP65 dn caja de policarbonato transparente de 63 mm. Pin y movimiento en el accesorio AISI 316 REAR (ISO228). Esfera de aluminio, escala inferior blanca, BAR, negro y rojo, PSI (doble escala, excluidos los manómetros de vacío manuales). Clase de precisión 2.5 - 1.6% - Manecilla de aluminio.

Hauptmerkmale

Gebaut nach UNI EN 837,1, komplett Edelstahl AISI 304 Gehäuse IP65 dn 63 mm. Stift und Bewegung in AISI 316, ZURÜCK (ISO 228) Angriff, transparentem Polycarbonat, Aluminium-Zifferblatt mit weißem Hintergrund, Maßstab BAR schwarz und rot PSI (zwei Skalen Vakuummeter ausgeschlossen). Genauigkeitsklasse 2,5 bis 1,6%, Aluminium Hand.

 Pressione e temperatura	 Pressure and Temperature	 Druck und Temperatur	 Pression et Température	 Presión y Temperatura
Costante 75% - Variabile 60% Sovrappressione 25% fino a 60 bar, 15% oltre	Steady 75% - Variable 60% Overpressure 25% until 60 bar, 15% over	Konstant 75% - Variable 60% Überdruck bis 60 bar, mehr als 15%	Constante 75% - Variable 60% Surpression 25% jusqu'à 60 bar, 15% de plus	Constante 75% - Variable 60% Sobrepresión 25% hasta 60 bar, 15% más.
Temperatura ambiente: -30°C / +65°C	Temperature environment -22°F / +149°F	Temperatur Umwelt -30°C / +65°C	Température environnement: -30°C / +65°C	Temperatura medio ambiente: -30°C / +65°C
Temperatura processo: -40°C / +180°C	Temperature process: -40°F / +356°F	Temperatur prozess: -40°C / +180°C	Température processus: -40°C / +180°C	Temperatura proceso: -40°C / +180°C

Varianti

Scale Normalizzate:

Vuotometro -1 / 0 Bar+CmHg;

Manovuotometro -1+0,6; -1+1,5; -1+3; -1+5; -1+9; -1+15 solo Bar; 0,6; 1; 1,6; 2,5; 4; 6; 10; 12; 16; 25; 40; 60; 100; 160; 250; 315; 400 Bar + Psi

Variantes

Échelles normalisées:

Vacuomètre -1 / 0 Bar + CmHg;

Manvuotometro -1 + 0,6; -1 + 1,5; -1 + 3; -1 + 5; -1 + 9; -1 + 15 bar seulement; 0,6; 1; 1,6; 2,5; 4; 6; 10; 12; 16; 25; 40; 60; 100; 160; 250; 315; 400 Bar + Psi

Variants

Normalized scale:

gauge compound -1 / 0 Bar+CmHg;

Water pressure gauge -1+0,6; -1+1,5; -1+3; -1+5; -1+9; -1+15 solo Bar; 0,6; 1; 1,6; 2,5; 4; 6; 10; 12; 16; 25; 40; 60; 100; 160; 250; 315; 400 Bar + Psi

Variantes

Escalas normalizadas:

Medidor de vacío -1 / 0 Bar + CmHg;

Manvuotometro -1 + 0,6; -1 + 1,5; -1 + 3; -1 + 5; -1 + 9; -1 + 15 Bar solamente; 0,6; 1; 1,6; 2,5; 4; 6; 10; 12; 16; 25; 40; 60; 100; 160; 250; 315; 400 Bar + Psi

Varianten

Maßstab normalisierten

Vakuummeter -1 / 0 Bar+CmHg;

Mano-Vakuummeter -1+0,6; -1+1,5; -1+3; -1+5; -1+9; -1+15 nur Bar; 0,6; 1; 1,6; 2,5; 4; 6; 10; 12; 16; 25; 40; 60; 100; 160; 250; 315; 400 Bar + Psi

Opzioni prodotto

Filetto NPT ANSI B.1.20.1 con o senza glicerina, sgrassatura uso ossigeno, scale e/o attacchi personalizzati, loghi, settori colorati.

Options du produit

Filetage ANSI NPT B.1.20.1 avec ou sans glycérine, utilisation d'oxygène de dégraissage, échelles et / ou accessoires personnalisés, logos, secteurs colorés.

Product options

NPT ANSI B.1.20.1 thread, With or without glycerine, OXYGEN SERVICE, customize range, Scale or logo; Colored sector.

Opciones de productos

ANSI NPT hilo B.1.20.1 con o sin glicerina, Desengrase del uso de oxígeno, escalas y / o accesorios personalizados, logos, sectores coloreados.

Produkt-Optionen

Gewinde NPT ANSI B.1.20.1 mit oder ohne Glycerin, Entfetten Verwendung Sauerstoff, greift Treppen und/oder individuelle Logos, farbigen Sektoren.

MXX 83

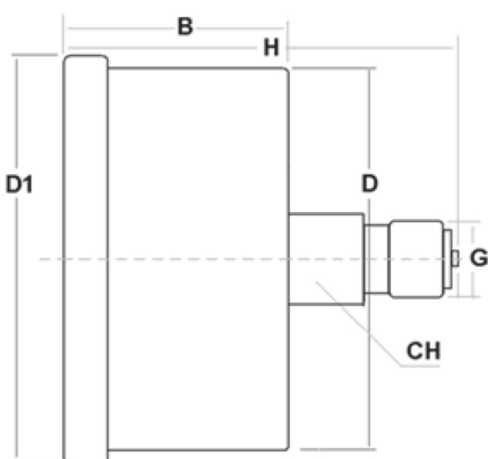

Manometri a secco attacco posteriore

- Gauges back connection
- Manometer zuruck Angriff
- Manomètre, raccord arrière centré
- Manómetro posterior

- Vuotometro
- Vacuum Gauge
- Vakuummeter
- Vacuomètre
- Vacuómetro

CODICE/CODE	Ø	ATTACCO CONNECTION	SCALA RANGE	PRECISIONE ACCURACY	PEZZI PIECES
MXX836314099P	63	G1/4	-1 / 0	C.L.1,6	1

- Manometro
- Gauges
- Manometer
- Manomètre
- Manómetro

CODICE/CODE	Ø	ATTACCO CONNECTION	SCALA RANGE	PRECISIONE ACCURACY	PEZZI PIECES
MXX836314001P	63	G1/4	0 / +1	C.L.1,6	1
MXX836314106P	63	G1/4	0 / +1,6	C.L.1,6	1
MXX836314205P	63	G1/4	0 / +2,5	C.L.1,6	1
MXX836314004P	63	G1/4	0 / +4	C.L.1,6	1
MXX836314006P	63	G1/4	0 / +6	C.L.1,6	1
MXX836314010P	63	G1/4	0 / +10	C.L.1,6	1
MXX836314016P	63	G1/4	0 / +16	C.L.1,6	1
MXX836314025P	63	G1/4	0 / +25	C.L.1,6	1
MXX836314040P	63	G1/4	0 / +40	C.L.1,6	1
MXX836314060P	63	G1/4	0 / +60	C.L.1,6	1
MXX836314100P	63	G1/4	0 / +100	C.L.1,6	1
MXX836314160P	63	G1/4	0 / +160	C.L.1,6	1
MXX836314250P	63	G1/4	0 / +250	C.L.1,6	1
MXX836314400P	63	G1/4	0 / +400	C.L.1,6	1

Ø	B	D	D1	H	G	CH	Kg
63	29	62	68	56	G1/4	14	0,109

Dati tecnici di manometri e vuotometri interamente INOX

 Gauges and vacuum gauges complete INOX technical data

 Technischen Daten der Manometer und Vakuummeter vollständig Edelstahl

 Données techniques des manomètres et manomètres à vide entièrement INOX

 Datos técnicos de los manómetros y vacuómetros completamente INOX

• MXX 84

Applicazioni

Adatti per tutti gli impieghi dove esistono processi corrosivi. Tutte le applicazioni particolari (attacchi, quadranti, scale non normalizzate) possono essere risolte dalle nostre officine.

Ampla disponibilità di magazzino.

Applications

Convient à toutes les utilisations où des processus corrosifs existent. Toutes les applications spéciales (accessoires, cadrans, balances non normalisées) peuvent être résolues par nos ateliers.

Ample disponibilité des stocks.

Applications

Suitable for corrosive process gas or liquid. With liquid filled case for applications with high dynamic pressure pulsations or vibrations. Chemical/petrol-chemical, power stations, mining, on- and offshore, environmental technology, mechanical engineering and plant construction.

Our workshop is able to solve all your request.

Aplicaciones

Adecuado para todos los usos donde existan procesos corrosivos. Nuestros talleres pueden resolver todas las aplicaciones especiales (accesorios, cuadrantes, escalas no normalizadas).

Amplia disponibilidad de stock.

Anwendungen

Geeignet für alle Anwendungen, bei denen es korrosiven Prozessen. Alle spezielle Anwendungen (Ports, Zifferblätter, Skalen Nicht-Standard) können von unseren Workshops gelöst werden.

Die weite Verfügbarkeit von Lager.

Caratteristiche principali

Manometro costruito secondo Norme UNI EN 837.1 TUTTO INOX cassa AISI 304 IP65 dn 63 mm trasparente in policarbonato. Perno e movimento in AISI 316 attacco POSTERIORE con FLANGIA (ISO 228). Quadrante in alluminio fondo bianco scala BAR nera e PSI rossa (doppia scala esclusi mano vuotometri). Classe di precisione 2,5 - 1,6% - Lancetta in Alluminio

Principales caractéristiques

Manomètre construit selon les normes UNI EN 837.1 TOUT EN AISI 304 IP65 dn Boitier en polycarbonate transparent de 63 mm. Goupille et mouvement dans l'attache ARRIÈRE AISI 316 avec BRIDE (ISO 228). Cadran en aluminium échelle inférieure blanche BAR noir et rouge PSI (échelle double excluant les manomètres à vide). Classe de précision 2,5 - 1,6% - Main en aluminium

Main features





All stainless steel pressure gauge made according UNI EN 837.1 norms case AISI 304 dial 63 mm. Stainless steel AISI 316 movement and pivot BACK (ISO 228) connection with panel FLANGE - Aluminum dial White background Black BAR scale and Red PSI one (double scale except compound gauge) Accuracy 2,5, 1,6% - Aluminum index

Características principales

Manómetro fabricado según las normas UNI EN 837.1 TODO AISI 304 IP65 dn caja de policarbonato transparente de 63 mm. Pin y movimiento en el accesorio AISI 316 REAR con FLANGE (ISO 228). Esfera de aluminio, escala inferior blanca, BAR, negro y rojo, PSI (doble escala, excluidos los manómetros de vacío manuales). Clase de precisión 2.5 - 1.6% - Mano de aluminio.

Hauptmerkmale

Gebaut nach UNI EN 837.1, komplett Edelstahl AISI 304 Gehäuse IP65 dn 63 mm. Stift und Bewegung in AISI 316, ZURÜCK (ISO 228). Angriff mit Frontring, transparentem Polycarbonat, Aluminium-Zifferblatt mit weißem Hintergrund, Maßstab BAR schwarz und rot PSI (zwei Skalen Vakuummeter ausgeschlossen). Genauigkeitsklasse 2,5 bis 1,6%, - Aluminium Hand

 Pressione e temperatura	 Pressure and Temperature	 Druck und Temperatur	 Pression et Température	 Presión y Temperatura
Costante 75% - Variabile 60% Sovrappressione 25% fino a 60 bar, 15% oltre	Steady 75% - Variable 60% Overpressure 25% until 60 bar, 15% over	Konstant 75% - Variable 60% Überdruck bis 60 bar, mehr als 15%	Constante 75% - Variable 60% Surpression 25% jusqu'à 60 bar, 15% de plus	Constante 75% - Variable 60% Sobrepresión 25% hasta 60 bar, 15% más.
Temperatura ambiente: -30°C / +65°C	Temperature environment -22°F / +149°F	Temperatur Umwelt -30°C / +65°C	Température environnement: -30°C / +65°C	Temperatura medio ambiente: -30°C / +65°C
Temperatura processo: -40°C / +180°C	Temperature process: -40°F / +356°F	Temperatur prozess: -40°C / +180°C	Température processus: -40°C / +180°C	Temperatura proceso: -40°C / +180°C

Varianti

Scale Normalizzate:

Vuotometro -1 / 0 Bar+CmHg;

Manovuotometro -1+0,6; -1+1,5; -1+3; -1+5; -1+9; -1+15 solo Bar; 0,6; 1; 1,6; 2,5; 4; 6; 10; 12; 16; 25; 40; 60; 100; 160; 250; 315; 400 Bar + Psi

Variantes

Échelles normalisées:

Vacuomètre -1 / 0 Bar + CmHg;

Manvuotometro -1 + 0,6; -1 + 1,5; -1 + 3; -1 + 5; -1 + 9; -1 + 15 bar seulement; 0,6; 1; 1,6; 2,5; 4; 6; 10; 12; 16; 25; 40; 60; 100; 160; 250; 315; 400 Bar + Psi

Variants

Normalized scale:

gauge compound -1 / 0 Bar+CmHg;

Water pressure gauge -1+0,6; -1+1,5; -1+3; -1+5; -1+9; -1+15 solo Bar; 0,6; 1; 1,6; 2,5; 4; 6; 10; 12; 16; 25; 40; 60; 100; 160; 250; 315; 400 Bar + Psi

Variantes

Escalas normalizadas:

Medidor de vacío -1 / 0 Bar + CmHg;

Manvuotometro -1 + 0,6; -1 + 1,5; -1 + 3; -1 + 5; -1 + 9; -1 + 15 Bar solamente; 0,6; 1; 1,6; 2,5; 4; 6; 10; 12; 16; 25; 40; 60; 100; 160; 250; 315; 400 Bar + Psi

Varianten

Maßstab normalisierten

Vakuummeter -1 / 0 Bar+CmHg;

Mano-Vakuummeter -1+0,6; -1+1,5; -1+3; -1+5; -1+9; -1+15 nur Bar; 0,6; 1; 1,6; 2,5; 4; 6; 10; 12; 16; 25; 40; 60; 100; 160; 250; 315; 400 Bar + Ps

Opzioni prodotto

Filetto NPT ANSI B.1.20.1 - Sgrassatura uso ossigeno, scale e/o attacchi personalizzati, loghi, settori colorati.

Options du produit

Filetage ANSI NPT B.1.20.1 - Dégraissage pour utilisation d'oxygène, balances et/ou accessoires personnalisés, logos, secteurs colorés.

Product options

NPT ANSI B.1.20.1 thread, With or without glycerine, OXYGENE SERVICE customize range, scale or logo; Colored sector.

Opciones de productos

Rosca NPT ANSI B.1.20.1 - Desengrasante para uso de oxígeno, básculas y/o accesorios personalizados, logotipos, sectores coloreados.

Produkt-Optionen

Gewinde NPT ANSI B.1.20.1 mit oder ohne Glycerin, Entfetten Verwendung Sauerstoff, greift Treppen und/oder individuelle Logos, farbigen Sektoren.

MXX 84

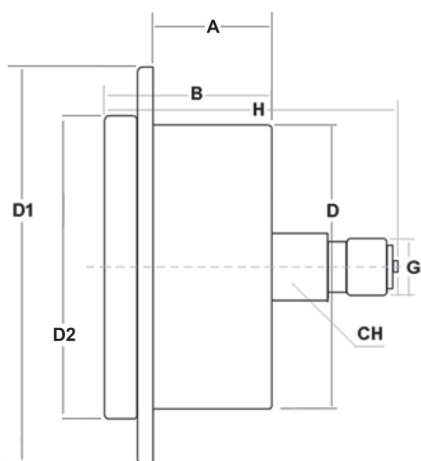

Manometri a secco attacco posteriore flangia 3 fori

Gauges back connection with 3 holes flange

Manometer zuruck Angriff mit Paneelring

Manomètre, raccord arrière centré, encastrable

Manómetro posterior, brida a 3 taladros

Vuotometro

Vacuum Gauge

Vakuummeter

Vacuomètre

Vacuómetro

CODICE/CODE	Ø	ATTACCO CONNECTION	SCALA RANGE	PRECISIONE ACCURACY	PEZZI PIECES
MXX846314099F	63	G1/4	-1 / 0	C.L.1,6	1

Manometro

Gauges

Manometer

Manomètre

Manómetro

CODICE/CODE	Ø	ATTACCO CONNECTION	SCALA RANGE	PRECISIONE ACCURACY	PEZZI PIECES
MXX846314001F	63	G1/4	0 / +1	C.L.1,6	1
MXX846314106F	63	G1/4	0 / +1,6	C.L.1,6	1
MXX846314205F	63	G1/4	0 / +2,5	C.L.1,6	1
MXX846314004F	63	G1/4	0 / +4	C.L.1,6	1
MXX846314006F	63	G1/4	0 / +6	C.L.1,6	1
MXX846314010F	63	G1/4	0 / +10	C.L.1,6	1
MXX846314016F	63	G1/4	0 / +16	C.L.1,6	1
MXX846314025F	63	G1/4	0 / +25	C.L.1,6	1
MXX846314040F	63	G1/4	0 / +40	C.L.1,6	1
MXX846314060F	63	G1/4	0 / +60	C.L.1,6	1
MXX846314100F	63	G1/4	0 / +100	C.L.1,6	1
MXX846314160F	63	G1/4	0 / +160	C.L.1,6	1
MXX846314250F	63	G1/4	0 / +250	C.L.1,6	1
MXX846314400F	63	G1/4	0 / +400	C.L.1,6	1

Ø	A	B	D	D1	D2	H	G	CH	Kg
63	22,5	29	62	83	68	56	G1/4	14	0,153

Dati tecnici di manometri e vuotometri interamente INOX

 Gauges and vacuum gauges complete INOX technical data

 Technischen Daten der Manometer und Vakuummeter vollständig Edelstahl

 Données techniques des manomètres et manomètres à vide entièrement INOX

 Datos técnicos de los manómetros y vacuómetros completamente INOX

• MXX 92

Applicazioni

Adatti per tutti gli impieghi dove esistono processi corrosivi. Tutte le applicazioni particolari (attacchi, quadranti, scale non normalizzate) possono essere risolte dalle nostre officine.

Ampla disponibilità di magazzino.

Applications

Convient à toutes les utilisations où des processus corrosifs existent. Toutes les applications spéciales (accessoires, cadrans, balances non normalisées) peuvent être résolues par nos ateliers.

Ample disponibilité des stocks.

Applications

Suitable for corrosive process gas or liquid. With liquid filled case for applications with high dynamic pressure pulsations or vibrations. Chemical/petrol-chemical, power stations, mining, on- and offshore, environmental technology, mechanical engineering and plant construction.

Our workshop is able to solve all your request.

Aplicaciones

Adecuado para todos los usos donde existan procesos corrosivos. Nuestros talleres pueden resolver todas las aplicaciones especiales (accesorios, cuadrantes, escalas no normalizadas).

Amplia disponibilidad de stock.

Anwendungen

Geeignet für alle Anwendungen, bei denen es korrosiven Prozessen. Alle spezielle Anwendungen (Ports, Zifferblätter, Skalen Nicht-Standard) können von unseren Workshops gelöst werden.

Die weite Verfügbarkeit von Lager.

Caratteristiche principali

Manometro costruito secondo Norme UNI EN 837.1 TUTTO INOX cassa AISI 304 IP65 dn 63 - 100 mm. Perno e movimento in AISI 316 attacco RADIALE (ISO 228). Per d63: trasparente in policarbonato, quadrante in alluminio fondo bianco scala BAR, nera e PSI rossa (doppia scala esclusi mano vuotometri). Classe di precisione 2,5 - 1,6% Lancetta in Alluminio; Per d100: trasparente in vetro stratificato di sicurezza, con tappo posteriore di sicurezza scala in BAR classe di precisione 1.0% - lancetta in alluminio micrometrica aggiustabile.

Principales caractéristiques

Manomètre construit selon les normes UNI EN 837.1 TOUT ACIER INOXYDABLE AISI 304 IP65 DN 63 - 100 mm. Broche et mouvement dans une connexion RADIAL AISI 316 (ISO 228). Pour d63: polycarbonate transparent, cadran en aluminium avec échelle inférieure blanche, échelle BAR, noir et rouge en PSI (échelle double excluant les vacuomètres à main). Classe de précision 2,5 - 1,6% Main en aluminium; Pour d100: verre de sécurité feuilleté transparent, avec capuchon de sécurité arrière Échelle BAR échelle de précision classe 1,0% - lancette micrométrique en aluminium réglable.

Main features





All stainless steel pressure gauge made according UNI EN 837.1 norms case AISI 304 dial 63-100 mm. Stainless steel AISI 316 movement and pivot BOTTOM (ISO 228) connection. For d63: - Aluminum dial White background Black BAR scale and Red PSI one (double scale except compound gauge) - Accuracy 2,5, 1,6% - Aluminum index. For d100: safety glass window with back blow out cap, aluminum dial white background black BAR scale, accuracy 1.0% - Micrometric adjustable aluminum index.

Características principales

Manómetro fabricado según las normas UNI EN 837.1. TODO ACERO INOXIDABLE AISI 304 IP65 dn 63 - 100 mm. Pin y movimiento en la conexión AISI 316 RADIAL (ISO 228). Para d63: policarbonato transparente, esfera de aluminio con fondo blanco. Escala BAR, PSI negro y rojo (doble escala, excluidos los manómetros de mano). Clase de precisión 2,5 - 1,6% Mano de aluminio; Para d100: vidrio de seguridad laminado transparente, con tapa de seguridad trasera Escala BAR clase de precisión 1,0% - lanceta micrométrica de aluminio ajustable.

Hauptmerkmale

Gebaut nach UNI EN 837.1, komplett Edelstahl AISI 304 Gehäuse IP65 dn 63 - 100 mm. Stift und Bewegung in AISI 316, RADIAL Angriff (ISO 228). Für d63: aus transparentem Polycarbonat, Aluminium-Zifferblatt mit weißem Hintergrund, Maßstab BAR schwarz und rot PSI (zwei Skalen Vakuummeter ausgeschlossen). Genauigkeitsklasse 2,5 bis 1,6%, Aluminium Hand; Für d100: transparent VSG, mit Zurückkappe Sicherheit, Skalierbarkeit BAR, Genauigkeitsklasse 1,0% - hand Aluminium Feineinstellung.

 Pressione e temperatura	 Pressure and Temperature	 Druck und Temperatur	 Pression et Température	 Presión y Temperatura
Costante 75% - Variabile 60% Sovrappressione 25% fino a 60 bar, 15% oltre	Steady 75% - Variable 60% Overpressure 25% until 60 bar, 15% over	Konstant 75% - Variable 60% Überdruck bis 60 bar, mehr als 15%	Constante 75% - Variable 60% Surpression 25% jusqu'à 60 bar, 15% de plus	Constante 75% - Variable 60% Sobrepresión 25% hasta 60 bar, 15% más.
Temperatura ambiente: -30°C / +65°C	Temperature environment -22°F / +149°F	Temperatur Umwelt -30°C / +65°C	Température environnement: -30°C / +65°C	Temperatura medio ambiente: -30°C / +65°C
Temperatura processo: -40°C / +180°C	Temperature process: -40°F / +356°F	Temperatur prozess: -40°C / +180°C	Température processus: -40°C / +180°C	Temperatura proceso: -40°C / +180°C

Varianti

D63:
Scale Normalizzate:
Vuotometro -1 / 0 Bar + CmHg;
Manvuotometro -1+0,6; -1+1,5; -1+3; -1+5; -1+9; -1+15 solo Bar; 0,6; 1; 1,6; 2,5; 4; 6; 10; 12; 16; 25; 40; 60; 100; 160; 250; 315; 400 Bar + Psi

D100:
Scale Normalizzate: -1 / 0; -1+0,6; -1+1,5; -1+3; -1+5; -1+9; -1+15; 1; 1,6; 2,5; 4; 6; 10; 12; 16; 25; 40; 60; 100; 160; 250; 400; 600; 1000; 1600 bar

Variantes

D63:
Échelles normalisées:
Vacuomètre -1 / 0 Bar + CmHg;
Manvuotometro -1 + 0,6; -1 + 1,5; -1 + 3; -1 + 5; -1 + 9; -1 + 15 bar seulement; 0,6; 1; 1,6; 2,5; 4; 6; 10; 12; 16; 25; 40; 60; 100; 160; 250; 315; 400 Bar + Psi

D100:
Échelles normalisées: -1 / 0; -1 + 0,6; -1 + 1,5; -1 + 3; -1 + 5; -1 + 9; -1 + 15; 1; 1,6; 2,5; 4; 6; 10; 12; 16; 25; 40; 60; 100; 160; 250; 400; 600; 1000; 1600 bar

Variants

D63:
Normalized scales:
Vacuum meter -1 / 0 Bar + CmHg;
Manvuotometro -1 + 0,6; -1 + 1,5; -1 + 3; -1 + 5; -1 + 9; -1 + 15 Bar only; 0,6; 1; 1,6; 2,5; 4; 6; 10; 12; 16; 25; 40; 60; 100; 160; 250; 315; 400 Bar + Psi

D100:
Normalized scales: -1 / 0; -1 + 0,6; -1 + 1,5; -1 + 3; -1 + 5; -1 + 9; -1 + 15; 1; 1,6; 2,5; 4; 6; 10; 12; 16; 25; 40; 60; 100; 160; 250; 400; 600; 1000; 1600 bar

Variantes

D63:
Escalas normalizadas:
Medidor de vacío -1 / 0 Bar + CmHg;
Manvuotometro -1 + 0,6; -1 + 1,5; -1 + 3; -1 + 5; -1 + 9; -1 + 15 Bar solamente; 0,6; 1; 1,6; 2,5; 4; 6; 10; 12; 16; 25; 40; 60; 100; 160; 250; 315; 400 Bar + Psi

D100:
Escalas normalizadas: -1 / 0; -1 + 0,6; -1 + 1,5; -1 + 3; -1 + 5; -1 + 9; -1 + 15; 1; 1,6; 2,5; 4; 6; 10; 12; 16; 25; 40; 60; 100; 160; 250; 400; 600; 1000; 1600 bar

Varianten

D63:
Normalisierte Skalen:
Vakuummeter -1 / 0 Bar + CmHg;
Manvuotometro -1 + 0,6; -1 + 1,5; 1 + 3; -1 + 5; -1 + 9; -1 + 15 bar nur; 0,6; 1; 1,6; 2,5; 4; 6; 10; 12; 16; 25; 40; 60; 100; 160; 250; 315; 400 Bar + Psi

D100:
Normalisierte Skalen: -1 / 0; -1 + 0,6; -1 + 1,5; 1 + 3; -1 + 5; -1 + 9; -1 + 15; 1; 1,6; 2,5; 4; 6; 10; 12; 16; 25; 40; 60; 100; 160; 250; 400; 600; 1000; 1600 bar

Opzioni prodotto

Filetto NPT ANSI B.1.20.1 con o senza glicerina, Sgrassatura uso ossigeno, scale e/o attacchi personalizzati, loghi, settori colorati, vetro di sicurezza (d100), esecuzione SOLID FRONT (d100), separatori (d100), contatti elettrici (d100), attacco radiale ad ore 3/9/12.

Options du produit

Filetage ANSI NPT B.1.20.1 avec ou sans glycérine, Dégraissage pour utilisation d'oxygène, balances et/ou accessoires personnalisés, logos, secteurs colorés, verre de sécurité (d100), SOLID FRONT (d100), séparateurs (d100), contacts électriques (d100), connexion radiale au 3/9/12.

Product options

NPT ANSI B.1.20.1 thread, With or without glycerine, OXYGENE SERVICE customize range, scale or logo; Colored sector; SAFETY glass, SOLID FRONT production, radial connection 3/9/12 hours.

Opciones de productos





ANSI NPT hilo B.1.20.1 con o sin glicerina, Desengrasante para uso de oxígeno, básculas y/o accesorios personalizados, logotipos, sectores coloreados, vidrio de seguridad (d100), FRENTE SÓLIDO (d100), separadores (d100), contactos eléctricos (d100), conexión radial al 3/9/12.



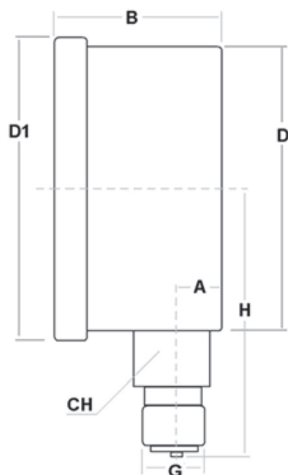

Produkt-Optionen

Gewinde NPT ANSI B.1.20.1 mit oder ohne Glycerin, Entfetten Verwendung Sauerstoff, Treppen Angriffen und/oder individuelle Logos, farbige Einheiten, Sicherheitsglas (d100), läuft SOLID FRONT (d100), Abscheider (d100), elektrische Kontakte (d100), 3/9/12 Stunden.

MXX 92



-  **Manometri glicerina attacco radiale**
-  Gauges liquid fillable bottom connection
-  Manometer Glycerin radial Angriff
-  Manomètre à bain de glycérine, raccord vertical
-  Manómetro radial con glicerina

-  **Vuotometro**
-  Vacuum Gauge
-  Vakuummeter
-  Vacuomètre
-  Vacuómetro

CODICE/CODE	Ø	ATTACCO CONNECTION	SCALA RANGE	PRECISIONE ACCURACY	PEZZI PIECES
MXX926314099R	63	G1/4	-1 / 0	C.L.1,6	1





-  **Manometro**
-  Gauges
-  Manometer
-  Manomètre
-  Manómetro



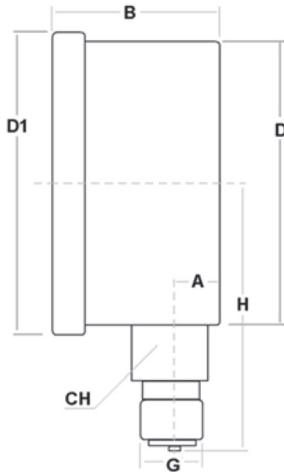

CODICE/CODE	Ø	ATTACCO CONNECTION	SCALA RANGE	PRECISIONE ACCURACY	PEZZI PIECES
MXX926314Z06R	63	G1/4	0 / +0,6	C.L.1,6	1
MXX926314001R	63	G1/4	0 / +1	C.L.1,6	1
MXX926314106R	63	G1/4	0 / +1,6	C.L.1,6	1
MXX926314205R	63	G1/4	0 / +2,5	C.L.1,6	1
MXX926314004R	63	G1/4	0 / +4	C.L.1,6	1
MXX926314006R	63	G1/4	0 / +6	C.L.1,6	1
MXX926314010R	63	G1/4	0 / +10	C.L.1,6	1
MXX926314016R	63	G1/4	0 / +16	C.L.1,6	1
MXX926314025R	63	G1/4	0 / +25	C.L.1,6	1
MXX926314040R	63	G1/4	0 / +40	C.L.1,6	1
MXX926314060R	63	G1/4	0 / +60	C.L.1,6	1
MXX926314100R	63	G1/4	0 / +100	C.L.1,6	1
MXX926314160R	63	G1/4	0 / +160	C.L.1,6	1
MXX926314250R	63	G1/4	0 / +250	C.L.1,6	1
MXX926314400R	63	G1/4	0 / +400	C.L.1,6	1
MXX926314600R	63	G1/4	0 / +600	C.L.1,6	1

Ø	A	B	D	D1	H	G	CH	Kg
63	10	31	62	66	54	G1/4	14	0,136

MXX 92



-  **Manometri glicerina attacco radiale**
-  Gauges liquid fillable bottom connection
-  Manometer Glycerin radial Angriff
-  Manomètre à bain de glycérine, raccord vertical
-  Manómetro radial con glicerina

-  **Vuotometro**
-  Vacuum Gauge
-  Vakuummeter
-  Vacuomètre
-  Vacuómetro

CODICE/CODE	Ø	ATTACCO CONNECTION	SCALA RANGE	PRECISIONE ACCURACY	PEZZI PIECES
MXX921012099R	100	G1/2	-1 / 0	C.L.1,0	1

-  **Manovuotometro**
-  Compound
-  Manovakuummeter
-  Manovacuumètre
-  Manovacuómetro

CODICE/CODE	Ø	ATTACCO CONNECTION	SCALA RANGE	PRECISIONE ACCURACY	PEZZI PIECES
MXX921012115R	100	G1/2	-1 / +1,5	C.L.1,0	1
MXX921012903R	100	G1/2	-1 / +3	C.L.1,0	1
MXX921012905R	100	G1/2	-1 / +5	C.L.1,0	1
MXX921012909R	100	G1/2	-1 / +9	C.L.1,0	1

-  **Manometro**
-  Gauges
-  Manometer
-  Manomètre
-  Manómetro

CODICE/CODE	Ø	ATTACCO CONNECTION	SCALA RANGE	PRECISIONE ACCURACY	PEZZI PIECES
MXX921012Z06R	100	G1/2	0 / +0,6	C.L.1,0	1
MXX921012001R	100	G1/2	0 / +1	C.L.1,0	1
MXX921012106R	100	G1/2	0 / +1,6	C.L.1,0	1
MXX921012205R	100	G1/2	0 / +2,5	C.L.1,0	1
MXX921012004R	100	G1/2	0 / +4	C.L.1,0	1
MXX921012006R	100	G1/2	0 / +6	C.L.1,0	1
MXX921012010R	100	G1/2	0 / +10	C.L.1,0	1
MXX921012016R	100	G1/2	0 / +16	C.L.1,0	1
MXX921012025R	100	G1/2	0 / +25	C.L.1,0	1
MXX921012040R	100	G1/2	0 / +40	C.L.1,0	1
MXX921012060R	100	G1/2	0 / +60	C.L.1,0	1
MXX921012100R	100	G1/2	0 / +100	C.L.1,0	1
MXX921012160R	100	G1/2	0 / +160	C.L.1,0	1
MXX921012250R	100	G1/2	0 / +250	C.L.1,0	1
MXX921012400R	100	G1/2	0 / +400	C.L.1,0	1
MXX921012600R	100	G1/2	0 / +600	C.L.1,0	1
MXX921012M00R	100	G1/2	0 / +1000	C.L.1,0	1

Ø	A	B	D	D1	H	G	CH	Kg
100	28	59	101	110	86	G1/2	22	1

Dati tecnici di manometri e vuotometri interamente INOX

 Gauges and vacuum gauges complete INOX technical data

 Technischen Daten der Manometer und Vakuummeter vollständig Edelstahl

 Données techniques des manomètres et manomètres à vide entièrement INOX

 Datos técnicos de los manómetros y vacuómetros completamente INOX

• MXX 93

Applicazioni

Adatti per tutti gli impieghi dove esistono processi corrosivi. Tutte le applicazioni particolari (attacchi, quadranti, scale non normalizzate) possono essere risolte dalle nostre officine.

Ampla disponibilità di magazzino.

Applications

Convient à toutes les utilisations où des processus corrosifs existent. Toutes les applications spéciales (accessoires, cadrans, balances non normalisées) peuvent être résolues par nos ateliers.

Ample disponibilité des stocks.

Anwendungen

Suitable for corrosive process gas or liquid. With liquid filled case for applications with high dynamic pressure pulsations or vibrations. Chemical/petrol-chemical, power stations, mining, on- and offshore, environmental technology, mechanical engineering and plant construction.

Our workshop is able to solve all your request.

Aplicaciones

Adecuado para todos los usos donde existan procesos corrosivos. Nuestros talleres pueden resolver todas las aplicaciones especiales (accesorios, cuadrantes, escalas no normalizadas).

Amplia disponibilidad de stock.

Hauptmerkmale

Geeignet für alle Anwendungen, bei denen es korrosiven Prozessen. Alle spezielle Anwendungen (Ports, Zifferblätter, Skalen Nicht-Standard) können von unseren Workshops gelöst werden.

Die weite Verfügbarkeit von Lager.

Caratteristiche principali

Manometro costruito secondo Norme UNI EN 837.1 TUTTO INOX cassa AISI 304 IP65 dn 63 mm trasparente in policarbonato. Perno e movimento in AISI 316 attacco POSTERIORE (ISO228). Quadrante in alluminio fondo bianco scala BAR nera e PSI rossa (doppia scala esclusi mano vuotometri).

Classe di precisione 2,5 - 1,6% - Lancetta in Alluminio.

Principales características

Manomètre construit selon les normes UNI EN 837.1 TOUT EN AISI 304 IP65 dn Boitier en polycarbonate transparent de 63 mm. Goupille et mouvement dans l'attache ARRIÈRE AISI 316 (ISO228). Cadran en aluminium échelle inférieure blanche BAR noir et rouge PSI (échelle double excluant les manomètres à vide).

Classe de précision 2,5 - 1,6% - Main en aluminium.

Main features

Pressure gauge made according UNI EN 837.1 norms Stainless steel case AISI 304 dial 63 mm. BRASS movement and pivot BACK (ISO 228) connection - Aluminium dial White background Black BAR scale and Red PSI one (double scale except compound gauge).

Accuracy 2,5, 1,6% - Aluminium index.

Características principales

Manómetro fabricado según las normas UNI EN 837.1 TODO AISI 304 IP65 dn caja de policarbonato transparente de 63 mm. Pin y movimiento en el accesorio AISI 316 REAR (ISO228). Esfera de aluminio, escala inferior blanca, BAR, negro y rojo, PSI (doble escala, excluidos los manómetros de vacío manuales).

Clase de precisión 2.5 - 1.6% - Manecilla de aluminio.

Pressione e temperatura

Costante 75% - Variabile 60%
Sovrappressione 25% fino a 60 bar, 15% oltre

Temperatura ambiente:
-30°C / +65°C

Temperatura processo:
0°C / +75°C

Pressure and Temperature

Steady 75% - Variable 60%
Overpressure 25% until 60 bar, 15% over

Temperature environment:
-22°F / +149°F

Temperature process:
+32°F / +167°F

Druck und Temperatur

Konstant 75% - Variable 60%
Überdruck bis 60 bar, mehr als 15%

Temperatur Umwelt:
-30°C / +65°C

Temperatur prozess:
0°C / +75°C

Pression et Température

Constante 75% - Variable 60%
Surpression 25% jusqu'à 60 bar, 15% de plus

Température environnement:
-30°C / +65°C





Température processus:
0°C / +75°C

Presión y Temperatura

Constante 75% - Variable 60%
Sobrepresión 25% hasta 60 bar, 15% más.

Temperatura medio ambiente:
-30°C / +65°C

Temperatura proceso:
0°C / +75°C

 Pressione e temperatura	 Pressure and Temperature	 Druck und Temperatur	 Pression et Température	 Presión y Temperatura
Costante 75% - Variabile 60% Sovrappressione 25% fino a 60 bar, 15% oltre	Steady 75% - Variable 60% Overpressure 25% until 60 bar, 15% over	Konstant 75% - Variable 60% Überdruck bis 60 bar, mehr als 15%	Constante 75% - Variable 60% Surpression 25% jusqu'à 60 bar, 15% de plus	Constante 75% - Variable 60% Sobrepresión 25% hasta 60 bar, 15% más.
Temperatura ambiente: -30°C / +65°C	Temperature environment: -22°F / +149°F	Temperatur Umwelt: -30°C / +65°C	Température environnement: -30°C / +65°C	Temperatura medio ambiente: -30°C / +65°C
Temperatura processo: 0°C / +75°C	Temperature process: +32°F / +167°F	Temperatur prozess: 0°C / +75°C	Température processus: 0°C / +75°C	Temperatura proceso: 0°C / +75°C

Varianti

Scale Normalizzate:

Vuotometro -1 / 0 Bar+CmHg;

Manovuotometro -1+0,6; -1+1,5; -1+3; -1+5; -1+9; -1+15 solo Bar; 0,6; 1; 1,6; 2,5; 4; 6; 10; 12; 16; 25; 40; 60; 100; 160; 250; 315; 400 Bar + Psi

Variantes

Échelles normalisées:

Vacuomètre -1 / 0 Bar + CmHg;

Manvuotometro -1 + 0,6; -1 + 1,5; -1 + 3; -1 + 5; -1 + 9; -1 + 15 bar seulement; 0,6; 1; 1,6; 2,5; 4; 6; 10; 12; 16; 25; 40; 60; 100; 160; 250; 315; 400 Bar + Psi

Variants

Normalized scale:

gauge compound -1 / 0 Bar+CmHg;

Water pressure gauge -1+0,6; -1+1,5; -1+3; -1+5; -1+9; -1+15 solo Bar; 0,6; 1; 1,6; 2,5; 4; 6; 10; 12; 16; 25; 40; 60; 100; 160; 250; 315; 400 Bar + Psi

Variantes

Escalas normalizadas:

Medidor de vacío -1 / 0 Bar + CmHg;

Manvuotometro -1 + 0,6; -1 + 1,5; -1 + 3; -1 + 5; -1 + 9; -1 + 15 Bar solamente; 0,6; 1; 1,6; 2,5; 4; 6; 10; 12; 16; 25; 40; 60; 100; 160; 250; 315; 400 Bar + Psi

Varianten

Maßstab normalisierten

Vakuummeter -1 / 0 Bar+CmHg;

Mano-Vakuummeter -1+0,6; -1+1,5; -1+3; -1+5; -1+9; -1+15 nur Bar; 0,6; 1; 1,6; 2,5; 4; 6; 10; 12; 16; 25; 40; 60; 100; 160; 250; 315; 400 Bar + Ps

Opzioni prodotto

Filetto NPT ANSI B.1.20.1 con o senza glicerina, sgrassatura uso ossigeno, scale e/o attacchi personalizzati, loghi, settori colorati.

Options du produit

Filetage ANSI NPT B.1.20.1 avec ou sans glycérine, dégraissage à l'oxygène, balances et / ou accessoires personnalisés, logos, secteurs colorés.

Product options

NPT ANSI B.1.20.1 thread, With or without glycerin, OXYGEN SERVICE, customize range, Scale or logo; Colored sector.

Opciones de productos

ANSI NPT hilo B.1.20.1 con o sin glicerina, desengrasado a base de oxígeno, escalas y / o accesorios personalizados, logotipos, sectores coloreados.

Produkt-Optionen

Gewinde NPT ANSI B.1.20.1 mit oder ohne Glycerin, Entfetten Verwendung Sauerstoff, greift Treppen und/oder individuelle Logos, farbigen Sektoren.

MXX 93

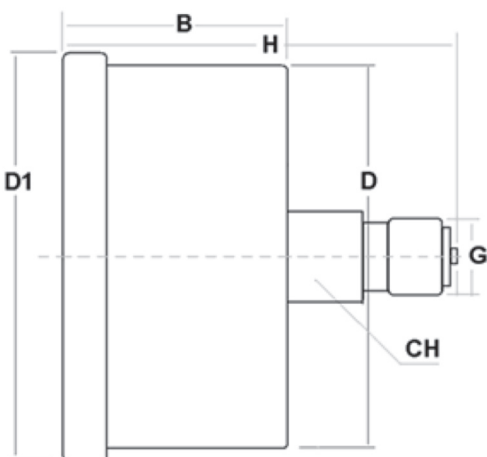

Manometri glicerina attacco posteriore

- Gauges liquid fillable back connection
- Manometer Glycerin zurück Angriff
- Manomètre à bain de glycérine, raccord arrière centré
- Manómetro posterior con glicerina

Vuotometro Vacuum Gauge Vakuummeter
 Vacuomètre Vacuómetro

CODICE/CODE	Ø	ATTACCO CONNECTION	SCALA RANGE	PRECISIONE ACCURACY	PEZZI PIECES
MXX936314099P	63	G1/4	-1 / 0	C.L.1,6	1

Manometro Gauges Manometer
 Manomètre Manómetro

CODICE/CODE	Ø	ATTACCO CONNECTION	SCALA RANGE	PRECISIONE ACCURACY	PEZZI PIECES
MXX936314001P	63	G1/4	0 / +1	C.L.1,6	1
MXX936314106P	63	G1/4	0 / +1,6	C.L.1,6	1
MXX936314205P	63	G1/4	0 / +2,5	C.L.1,6	1
MXX936314004P	63	G1/4	0 / +4	C.L.1,6	1
MXX936314006P	63	G1/4	0 / +6	C.L.1,6	1
MXX936314010P	63	G1/4	0 / +10	C.L.1,6	1
MXX936314016P	63	G1/4	0 / +16	C.L.1,6	1
MXX936314025P	63	G1/4	0 / +25	C.L.1,6	1
MXX936314040P	63	G1/4	0 / +40	C.L.1,6	1
MXX936314060P	63	G1/4	0 / +60	C.L.1,6	1
MXX936314100P	63	G1/4	0 / +100	C.L.1,6	1
MXX936314160P	63	G1/4	0 / +160	C.L.1,6	1
MXX936314250P	63	G1/4	0 / +250	C.L.1,6	1
MXX936314400P	63	G1/4	0 / +400	C.L.1,6	1

Ø	B	D	D1	H	G	CH	Kg
63	29	62	68	56	G1/4	14	0,109

Dati tecnici di manometri e vuotometri interamente INOX

 Gauges and vacuum gauges complete INOX technical data

 Technischen Daten der Manometer und Vakuummeter vollständig Edelstahl

 Données techniques des manomètres et manomètres à vide entièrement INOX

 Datos técnicos de los manómetros y vacuómetros completamente INOX

• MXX 94

Applicazioni

Adatti per tutti gli impieghi dove esistono processi corrosivi. Tutte le applicazioni particolari (attacchi, quadranti, scale non normalizzate) possono essere risolte dalle nostre officine.

Ampla disponibilità di magazzino.

Applications

Convient à toutes les utilisations où des processus corrosifs existent. Toutes les applications spéciales (accessoires, cadrans, balances non normalisées) peuvent être résolues par nos ateliers.

Ample disponibilité des stocks.

Applications

Suitable for corrosive process gas or liquid. With liquid filled case for applications with high dynamic pressure pulsations or vibrations. Chemical/petrol-chemical, power stations, mining, on- and offshore, environmental technology, mechanical engineering and plant construction.

Our workshop is able to solve all your request.

Aplicaciones

Adecuado para todos los usos donde existan procesos corrosivos. Nuestros talleres pueden resolver todas las aplicaciones especiales (accesorios, cuadrantes, escalas no normalizadas).

Amplia disponibilidad de stock.

Anwendungen

Geeignet für alle Anwendungen, bei denen es korrosiven Prozessen. Alle spezielle Anwendungen (Ports, Zifferblätter, Skalen Nicht-Standard) können von unseren Workshops gelöst werden.

Die weite Verfügbarkeit von Lager.

Caratteristiche principali

Manometro costruito secondo Norme UNI EN 837.1 TUTTO INOX cassa AISI 304 IP65 dn 63 mm trasparente in policarbonato. Perno e movimento in AISI 316 attacco POSTERIORE con FLANGIA (ISO 228). Quadrante in alluminio fondo bianco scala BAR nera e PSI rossa (doppia scala esclusi mano vuotometri).

Classe di precisione 2,5 - 1,6% - Lancetta in Alluminio

Principales características

Manomètre construit selon les normes UNI EN 837.1 TOUT EN AISI 304 IP65 dn Boîtier en polycarbonate transparent de 63 mm. Goupille et mouvement dans l'attachement ARRIÈRE AISI 316 avec BRIDE (ISO 228). Cadran en aluminium échelle inférieure blanche BAR noir et rouge PSI (échelle double excluant les manomètres à vide).

Classe de précision 2,5 - 1,6% - Main en aluminium

Main features

All stainless steel pressure gauge made according UNI EN 837.1 norms case AISI 304 dial 63 mm. Stainless steel AISI 316 movement and pivot BACK (ISO 228) connection with panel FLANGE - Aluminium dial White background Black BAR scale and Red PSI one (double scale except compound gauge)

Accuracy 2,5, 1,6% - Aluminium index

Características principales





Manómetro fabricado según las normas UNI EN 837.1 TODO AISI 304 IP65 dn caja de policarbonato transparente de 63 mm. Pin y movimiento en el accesorio AISI 316 REAR con FLANGIA (ISO 228). Esfera de aluminio, escala inferior blanca, BAR, negro y rojo, PSI (doble escala, excluidos los manómetros de vacío manuales).

Clase de precisión 2.5 - 1.6% - Mano de aluminio.

Hauptmerkmale

Gebaut nach UNI EN 837.1, komplett Edelstahl AISI 304 Gehäuse IP65 dn 63 mm. Stift und Bewegung in AISI 316, ZURÜCK (ISO 228) Angriff mit Frontring, transparentem Polycarbonat, Aluminium-Zifferblatt mit weißem Hintergrund, Maßstab BAR schwarz und rot PSI (zwei Skalen Vakuummeter ausgeschlossen).

Genauigkeitsklasse 2,5 bis 1,6%, Aluminium Hand.

 Pressione e temperatura	 Pressure and Temperature	 Druck und Temperatur	 Pression et Température	 Presión y Temperatura
Costante 75% - Variabile 60% Sovrappressione 25% fino a 60 bar, 15% oltre	Steady 75% - Variable 60% Overpressure 25% until 60 bar, 15% over	Konstant 75% - Variable 60% Überdruck bis 60 bar, mehr als 15%	Constante 75% - Variable 60% Surpression 25% jusqu'à 60 bar, 15% de plus	Constante 75% - Variable 60% Sobrepresión 25% hasta 60 bar, 15% más.
Temperatura ambiente: -30°C / +65°C	Temperature environment -22°F / +149°F	Temperatur Umwelt -30°C / +65°C	Température environnement: -30°C / +65°C	Temperatura medio ambiente: -30°C / +65°C
Temperatura processo: 0°C / +75°C	Temperature process: +32°F / +167°F	Temperatur prozess: 0°C / +75°C	Température processus: 0°C / +75°C	Temperatura proceso: 0°C / +75°C

Varianti

Scale Normalizzate:

Vuotometro -1 / 0 Bar + CmHg;

Manovuotometro -1+0,6; -1+1,5; -1+3; -1+5; -1+9; -1+15 solo Bar; 0,6; 1; 1,6; 2,5; 4; 6; 10; 12; 16; 25; 40; 60; 100; 160; 250; 315; 400 Bar + Psi

Variantes

Échelles normalisées:

Vacuomètre -1 / 0 Bar + CmHg;

Manvuotometro -1 + 0,6; -1 + 1,5; -1 + 3; -1 + 5; -1 + 9; -1 + 15 bar seulement; 0,6; 1; 1,6; 2,5; 4; 6; 10; 12; 16; 25; 40; 60; 100; 160; 250; 315; 400 Bar + Psi

Variants

Normalized scale:

gauge compound -1 / 0 Bar + CmHg;

Water pressure gauge -1+0,6; -1+1,5; -1+3; -1+5; -1+9; -1+15 solo Bar; 0,6; 1; 1,6; 2,5; 4; 6; 10; 12; 16; 25; 40; 60; 100; 160; 250; 315; 400 Bar + Psi

Variantes

Escalas normalizadas:

Medidor de vacío -1 / 0 Bar + CmHg;

Manvuotometro -1 + 0,6; -1 + 1,5; -1 + 3; -1 + 5; -1 + 9; -1 + 15 Bar solamente; 0,6; 1; 1,6; 2,5; 4; 6; 10; 12; 16; 25; 40; 60; 100; 160; 250; 315; 400 Bar + Psi

Varianten

Maßstab normalisierten

Vakuummeter -1 / 0 Bar + CmHg;

Mano-Vakuummeter -1+0,6; -1+1,5; -1+3; -1+5; -1+9; -1+15 nur Bar; 0,6; 1; 1,6; 2,5; 4; 6; 10; 12; 16; 25; 40; 60; 100; 160; 250; 315; 400 Bar + Ps

Opzioni prodotto

Filetto NPT ANSI B.1.20.1 - Sgrassatura uso ossigeno, scale e/o attacchi personalizzati, loghi, settori colorati.

Options du produit

Filetage ANSI NPT B.1.20.1 - Dégraissage pour utilisation d'oxygène, balances et/ou accessoires personnalisés, logos, secteurs colorés.

Product options

NPT ANSI B.1.20.1 thread, With or without glycerine, OXYGENE SERVICE customize range, scale or logo; Colored sector.

Opciones de productos

Rosca NPT ANSI B.1.20.1 - Desengrasante para uso de oxígeno, básculas y/o accesorios personalizados, logotipos, sectores coloreados.

Produkt-Optionen

Gewinde NPT ANSI B.1.20.1, Entfetten Verwendung Sauerstoff, greift Treppen und/oder individuelle Logos, farbigen Sektoren.

MXX 94

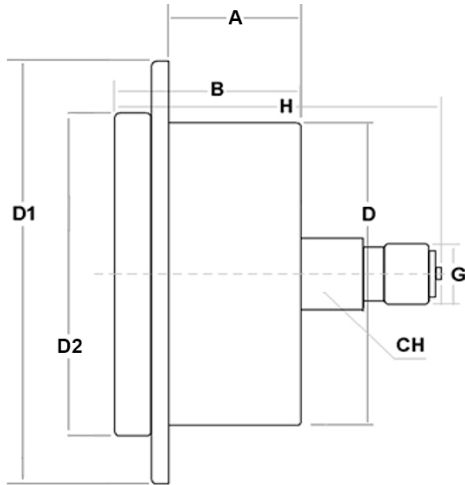

Manometri glicerina attacco posteriore flangia 3 fori

Gauges liquid fillable back connection with 3 holes flange

Manometer Glycerin zurück Angriff mit Paneelring

Manomètre à bain de glycérine, raccord arrière centré, encastrable

Manómetro posterior con glicerina, brida a 3 taladros

Vuotometro Vacuum Gauge **Vakuummeter**
Vacuomètre **Vacuómetro**

CODICE/CODE	Ø	ATTACCO CONNECTION	SCALA RANGE	PRECISIONE ACCURACY	PEZZI PIECES
MXX946314099F	63	G1/4	-1 / 0	C.L.1,6	1

Manometro Gauges **Manometer**
Manomètre **Manómetro**

CODICE/CODE	Ø	ATTACCO CONNECTION	SCALA RANGE	PRECISIONE ACCURACY	PEZZI PIECES
MXX946314001F	63	G1/4	0 / +1	C.L.1,6	1
MXX946314106F	63	G1/4	0 / +1,6	C.L.1,6	1
MXX946314205F	63	G1/4	0 / +2,5	C.L.1,6	1
MXX946314004F	63	G1/4	0 / +4	C.L.1,6	1
MXX946314006F	63	G1/4	0 / +6	C.L.1,6	1
MXX946314010F	63	G1/4	0 / +10	C.L.1,6	1
MXX946314016F	63	G1/4	0 / +16	C.L.1,6	1
MXX946314025F	63	G1/4	0 / +25	C.L.1,6	1
MXX946314040F	63	G1/4	0 / +40	C.L.1,6	1
MXX946314060F	63	G1/4	0 / +60	C.L.1,6	1
MXX946314100F	63	G1/4	0 / +100	C.L.1,6	1
MXX946314160F	63	G1/4	0 / +160	C.L.1,6	1
MXX946314250F	63	G1/4	0 / +250	C.L.1,6	1
MXX946314400F	63	G1/4	0 / +400	C.L.1,6	1

Ø	B	D	D1	D2	H	G	CH	Kg
63	29	62	83	68	56	G1/4	14	0,153

MXX 99



Staffa posteriore per manometri glicerina tutto INOX

Back clamp for inox gauges liquid fillable back connection

Paneelblech für Manometer Glycerin INOX

Équerre de fixation INOX pour manomètre à bain de glycérine

Soporte de fijación INOX para manómetro con glicerina

CODICE/CODE	MISURA/SIZE	PEZZI/PIECES
MXx990063P	Ø50 / Ø60	1