



## Manometri e vuotometri cassa INOX



Gauges and vacuum gauges INOX case



Manometer und Vakuummeter Edelstahl Gehäuse



Manomètres et vacuomètres boîtier en acier inoxydable



Manómetros y vacuómetros caja de acero inoxidable

### MX70



### MX71



### MX72



### MX99



### MX72PF



## Dati tecnici di manometri e vuotometri cassa INOX



Gauges and vacuum gauges INOX case technical data



Technischen Daten der Manometer und Vakuummeter Edelstahl Gehäuse



Données techniques des manomètres et vacuomètres boîtier en acier inoxydable



Datos técnicos de los manómetros y vacuómetros caja de acero inoxidable

## • MX70



### Applicazioni

Cassa INOX a tenuta stagna o a bagno di glicerina adatti per l'esterno o dove ci sono vibrazioni. Tutte le applicazioni particolari (attacchi, quadranti, scale non normalizzate) possono essere risolte dalle nostre officine. Ampia disponibilità di magazzino.



### Applications

Bain en ACIER INOXYDABLE ou à la glycérine approprié pour les activités en extérieur ou en présence de vibrations. Toutes les applications spéciales (accessoires, cadrans, balances non normalisées) peuvent être résolues par nos ateliers. Ample disponibilité des stocks.



### Applications

Suitable for all process gaseous and liquid that don't attack copper alloy parts. Intended for adverse service conditions where pulsating or vibration exists. Hydraulics, Compressors.



### Aplicaciones

Baño de ACERO INOXIDABLE o glicerina adecuado para exteriores o donde haya vibraciones. Nuestros talleres pueden resolver todas las aplicaciones especiales (accesorios, cuadrantes, escalas no normalizadas). Amplia disponibilidad de stock.



### Anwendungen

SST Fall wasserdicht oder Glycerinbad, geeignet für den Außenbereich oder wo es Vibrationen. Alle spezielle Anwendungen (Ports, Zifferblätter, Skalen Nicht-Standard) können von unseren Workshops gelöst werden. Umfangreiches Lager.



### Caratteristiche principali

Manometro costruito secondo Norme UNI EN 837.1 Cassa INOX IP65 AISI 304 dn 63 - 100 mm trasparente in policarbonato. Perno e movimento in OTTONE attacco RADIALE (ISO 228). Quadrante in alluminio fondo bianco scala BAR nera e PSI rossa (doppia scala esclusi mano vuotometri). Classe di precisione 2,5 - 1,0%. Lancetta in Alluminio.



### Principales caractéristiques

Manomètre construit conformément à la norme UNI EN 837.1 Normes IP65 Boîtier en acier inoxydable AISI 304, polycarbonate transparent de 63 - 100 mm. Broche et mouvement en liaison RADIAL LAITON (ISO 228). Cadran en aluminium échelle inférieure blanche BAR noir et rouge PSI (échelle double excluant les manomètres à vide). Classe de précision 2,5 - 1,0%. Main en aluminium.



### Main features

Pressure gauge made according UNI EN 837.1 norms Stainless steel case AISI 304 dial 63 - 100 mm. BRASS movement and pivot BOTTOM (ISO 228) connection - Aluminum dial White background Black BAR scale and Red PSI one (double scale except compound gauge). Accuracy 2,5 - 1,0% - Aluminum index.



### Características principales

Manómetro fabricado según la norma UNI EN 837.1 Normas IP65 AISI 304 caja de acero inoxidable Policarbonato transparente de 63 - 100 mm. Pin y movimiento en la conexión BRASS RADIAL (ISO 228). Esfera de aluminio, escala inferior blanca, BAR, negro y rojo, PSI (doble escala, excluidos los manómetros de vacío manuales). Clase de precisión 2.5 - 1.0%. Mano de aluminio.



### Hauptmerkmale

Gebaut nach UNI EN 837.1, Bei IP65 Edelstahl AISI 304 dn 63-100 mm, transparentem Polycarbonat. Stift und Bewegung MESSING Angriff RADIAL (ISO 228). Wählen Aluminium weiß, Maßstab BAR schwarz, rot für PSI (zwei Skalen Vakuummeter ausgeschlossen). Genauigkeitsklasse 2,5 auf 1,6% - Hand aus Aluminium.

## 🇮🇹 Esercizio

Temperatura d'esercizio -10°C / +65°C  
Costante 75% - Variabile 60%  
Sovrappressione 25% fino a 60 bar, 15% oltre

## 🇫🇷 Exercice

Température de fonctionnement -10°C / +65°C  
Constante 75% - Variable 60%  
Surpression 25% jusqu'à 60 bar, 15% de plus

## 🇬🇧 Working

Operating temperature +14°F / +149°F  
Steady 75% - Variable 60%  
Overpressure 25% until 60 bar, 15% over

## 🇪🇸 Ejercicio

Temperatura de funcionamiento -10°C / +65°C  
Constante 75% - Variable 60%  
Sobrepresión 25% hasta 60 bar, 15% más.

## 🇩🇪 Ausüben

Betriebstemperatur -10°C / +65°C  
Constant 75% - 60% Variable  
Überdruck bis 60 bar, mehr als 15%

## 🇮🇹 Varianti

Scale Normalizzate: Vuotometro -1 / 0 Bar+CmHg;  
Manovuotometro -1+0,6; -1+1; 5; -1+3; -1+5; -1+9; -1+15  
solo Bar; 0,6; 1; 1,6; 2,5; 4; 6; 10; 12; 16; 25; 40; 60; 100;  
160; 250; 315; 400 Bar + Psi

## 🇫🇷 Variantes

Escalas normalizadas: Medidor de vacío -1 / 0 Bar +  
CmHg; Manvuotometro -1 +0,6; -1 +1,5; -1 +3; -1 +5;  
-1 +9; -1 +15 Bar solamente; 0,6; 1; 1,6; 2,5; 4; 6; 10; 12;  
16; 25; 40; 60; 100; 160; 250; 315; 400 Bar + Psi

## 🇬🇧 Variants

Normalized scale: gauge compound -1 / 0 Bar+CmHg;  
Water pressure gauge -1+0,6; -1+1,5; -1+3; -1+5; -1+9;  
-1+15 solo Bar; 0,6; 1; 1,6; 2,5; 4; 6; 10; 12; 16; 25; 40; 60;  
100; 160; 250; 315; 400 Bar + Psi

## 🇪🇸 Variantes

Balances normalisées: vacuomètre -1 / 0 Bar + CmHg;  
Manvuotometro -1 + 0,6; -1 + 1; 5; -1 + 3; -1 + 5; -1 + 9;  
-1 + 15 bar seulement; 0,6; 1; 1,6; 2,5; 4; 6; 10; 12; 16; 25;  
40; 60; 100; 160; 250; 315; 400 Bar + Psi

## 🇩🇪 Varianten

Maßstab normalisierten Vakuummeter -1 / 0 Bar+CmHg;  
Mano-Vakuummeter -1+0,6; -1+1,5; -1+3; -1+5; -1+9;  
-1+15 nur Bar; 0,6; 1; 1,6; 2,5; 4; 6; 10; 12; 16; 25; 40; 60;  
100; 160; 250; 315; 400 Bar + Psi

## 🇮🇹 Opzioni prodotto

Filetto NPT ANSI B.1.20.1 con o senza glicerina, Sgrasatura uso ossigeno, scale e/o attacchi personalizzati, loghi, settori colorati.  
Attacco radiale ad ore 3/9/12.

## 🇫🇷 Options du produit

Filetage ANSI NPT B.1.20.1 avec ou sans glycérine, dégraissage à l'oxygène, balances et / ou accessoires personnalisés, logos, secteurs colorés.  
Attaque radiale au 3/9/12.

## 🇬🇧 Product options

NPT ANSI B.1.20.1 thread, With or without glycerine, OXYGEN SERVICE, customize range, scale or logo; Colored sector.  
Bottom connection at 3/9/12 hours.

## 🇪🇸 Opciones de productos

ANSI NPT hilo B.1.20.1 con o sin glicerina, desengrasado a base de oxígeno, escalas y / o accesorios personalizados, logotipos, sectores coloreados.  
Ataque radial al 3/9/12.

## 🇩🇪 Produkt-Optionen

Gewinde NPT ANSI B.1.20.1 mit oder ohne Glycerin, Entfetten Verwendung Sauerstoff, Treppen und / oder Anhänge individuelle Logos, farbigen Sektoren. Radial Angriff 3/9/12 Stunden.

# MX 70

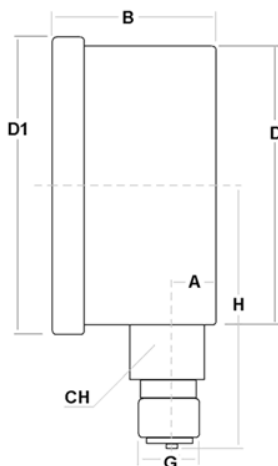

## 🇮🇹 Manometri glicerina attacco radiale

🇬🇧 Gauges liquid fillable bottom connection

🇩🇪 Manometer Glycerin radial Angriff

🇫🇷 Manomètre à bain de glycérine, raccord vertical

🇪🇸 Manómetro radial con glicerina

## 🇮🇹 Vuotometro

🇬🇧 Vacuum Gauge

🇩🇪 Vakuummeter

🇫🇷 Vacuomètre

🇪🇸 Vacuómetro

CODICE/CODE	Ø	ATTACCO CONNECTION	SCALA RANGE	PRECISIONE ACCURACY	PEZZI PIECES
<b>MX706314099R</b>	63	G1/4	-1 / 0	C.L.1,6	1

## 🇮🇹 Manovuotometro

🇬🇧 Compound

🇩🇪 Manovakuummeter

🇫🇷 Manovacuumètre

🇪🇸 Manovacuumetro

CODICE/CODE	Ø	ATTACCO CONNECTION	SCALA RANGE	PRECISIONE ACCURACY	PEZZI PIECES
<b>MX706314906R</b>	63	G1/4	-1 / +0,6	C.L.1,6	1
<b>MX706314115R</b>	63	G1/4	-1 / +1,5	C.L.1,6	1
<b>MX706314903R</b>	63	G1/4	-1 / +3	C.L.1,6	1
<b>MX706314905R</b>	63	G1/4	-1 / +5	C.L.1,6	1
<b>MX706314909R</b>	63	G1/4	-1 / +9	C.L.1,6	1
<b>MX706314915R</b>	63	G1/4	-1 / +15	C.L.1,6	1

Ø	A	B	D	D1	H	G	CH	Kg
63	10	29	62	68	57	G1/4	14	0,207

# MX 70

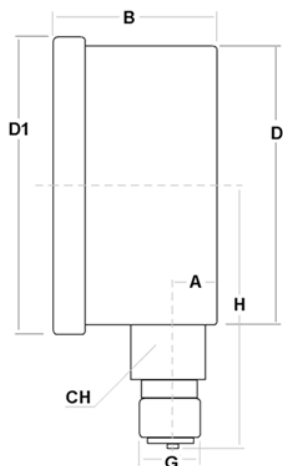

- Manometri glicerina attacco radiale**
- Gauges liquid fillable bottom connection
- Manometer Glycerin radial Angriff
- Manomètre à bain de glycérine, raccord vertical
- Manómetro radial con glicerina

- Manometro**
- Gauges
- Manometer
- Manomètre
- Manómetro

CODICE/CODE	Ø	ATTACCO CONNECTION	SCALA RANGE	PRECISIONE ACCURACY	PEZZI PIECES
<b>MX706314Z06R</b>	63	G1/4	0 / +0,6	C.L.1,6	1
<b>MX706314001R</b>	63	G1/4	0 / +1	C.L.1,6	1
<b>MX706314106R</b>	63	G1/4	0 / +1,6	C.L.1,6	1
<b>MX706314205R</b>	63	G1/4	0 / +2,5	C.L.1,6	1
<b>MX706314004R</b>	63	G1/4	0 / +4	C.L.1,6	1
<b>MX706314006R</b>	63	G1/4	0 / +6	C.L.1,6	1
<b>MX706314010R</b>	63	G1/4	0 / +10	C.L.1,6	1
<b>MX706314012R</b>	63	G1/4	0 / +12	C.L.1,6	1
<b>MX706314016R</b>	63	G1/4	0 / +16	C.L.1,6	1
<b>MX706314025R</b>	63	G1/4	0 / +25	C.L.1,6	1
<b>MX706314040R</b>	63	G1/4	0 / +40	C.L.1,6	1
<b>MX706314060R</b>	63	G1/4	0 / +60	C.L.1,6	1
<b>MX706314100R</b>	63	G1/4	0 / +100	C.L.1,6	1
<b>MX706314160R</b>	63	G1/4	0 / +160	C.L.1,6	1
<b>MX706314250R</b>	63	G1/4	0 / +250	C.L.1,6	1
<b>MX706314315R</b>	63	G1/4	0 / +315	C.L.1,6	1
<b>MX706314400R</b>	63	G1/4	0 / +400	C.L.1,6	1
<b>MX706314600R</b>	63	G1/4	0 / +600	C.L.1,6	1
<b>MX7063141000R</b>	63	G1/4	0 / +1000	C.L.1,6	1

- Vuotometro**
- Vacuum Gauge
- Vakuummeter
- Vacuomètre
- Vacuómetro

CODICE/CODE	Ø	ATTACCO CONNECTION	SCALA RANGE	PRECISIONE ACCURACY	PEZZI PIECES
<b>MX701012099R</b>	100	G1/2	-1 / 0	C.L.1,0	1





- Manovuotometro**
- Compound
- Manovakuummeter
- Manovacuumètre
- Manovacuumetro

CODICE/CODE	Ø	ATTACCO CONNECTION	SCALA RANGE	PRECISIONE ACCURACY	PEZZI PIECES
<b>MX701012906R</b>	100	G1/2	-1 / +0,6	C.L.1,0	1
<b>MX701012115R</b>	100	G1/2	-1 / +1,5	C.L.1,0	1
<b>MX701012903R</b>	100	G1/2	-1 / +3	C.L.1,0	1
<b>MX701012905R</b>	100	G1/2	-1 / +5	C.L.1,0	1
<b>MX701012909R</b>	100	G1/2	-1 / +9	C.L.1,0	1
<b>MX701012915R</b>	100	G1/2	-1 / +15	C.L.1,0	1

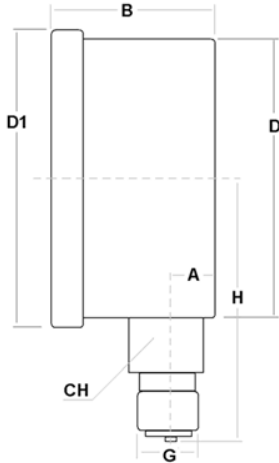
Ø	A	B	D	D1	H	G	CH	Kg
63	10	29	62	68	57	G1/4	14	0,207
100	10	38	98,5	110	82	G1/2	22	0,645

# MX 70







-  **Manometri glicerina attacco radiale**
-  Gauges liquid fillable bottom connection
-  Manometer Glycerin radial Angriff
-  Manomètre à bain de glycérine, raccord vertical
-  Manómetro radial con glicerina

-  **Manometro**
-  Gauges
-  Manometer
-  Manomètre
-  Manómetro

CODICE/CODE	Ø	ATTACCO CONNECTION	SCALA RANGE	PRECISIONE ACCURACY	PEZZI PIECES
MX701012001R	100	G1/2	0 / +1	C.L.1,0	1
MX701012106R	100	G1/2	0 / +1,6	C.L.1,0	1
MX701012205R	100	G1/2	0 / +2,5	C.L.1,0	1
MX701012004R	100	G1/2	0 / +4	C.L.1,0	1
MX701012006R	100	G1/2	0 / +6	C.L.1,0	1
MX701012010R	100	G1/2	0 / +10	C.L.1,0	1
MX701012016R	100	G1/2	0 / +16	C.L.1,0	1
MX701012025R	100	G1/2	0 / +25	C.L.1,0	1
MX701012040R	100	G1/2	0 / +40	C.L.1,0	1
MX701012060R	100	G1/2	0 / +60	C.L.1,0	1
MX701012100R	100	G1/2	0 / +100	C.L.1,0	1
MX701012160R	100	G1/2	0 / +160	C.L.1,0	1
MX701012250R	100	G1/2	0 / +250	C.L.1,0	1
MX701012400R	100	G1/2	0 / +400	C.L.1,0	1
MX701012600R	100	G1/2	0 / +600	C.L.1,0	1
MX7010121000R	100	G1/2	0 / +1000	C.L.1,0	1

Ø	A	B	D	D1	H	G	CH	Kg
100	10	38	98,5	110	82	G1/2	22	0,645

-  **Dati tecnici di manometri e vuotometri cassa INOX**
-  Gauges and vacuum gauges INOX case technical data
-  Technischen Daten der Manometer und Vakuummeter Edelstahl Gehäuse
-  Données techniques des manomètres et vacuomètres boîtier en acier inoxydable
-  Datos técnicos de los manómetros y vacuómetros caja de acero inoxidable

## • MX71 - MX72

### Applicazioni

Cassa INOX a tenuta stagna o a bagno di glicerina adatti per l'esterno o dove ci sono vibrazioni. Tutte le applicazioni particolari (attacchi, quadranti, scale non normalizzate) possono essere risolte dalle nostre officine. Ampia disponibilità di magazzino.

### Applications

Bain en ACIER INOXYDABLE ou à la glycérine approprié pour les activités en extérieur ou en présence de vibrations. Toutes les applications spéciales (accessoires, cadrans, balances non normalisées) peuvent être résolues par nos ateliers. Ample disponibilité des stocks.

### Applications

Stainless steel case sealed or glycerine suitable for outdoor use or where there are vibrations. All applications (attacks, dials, scales non-standard) can be solved by our workshops. Wide availability of stock.

### Aplicaciones

Baño de ACERO INOXIDABLE o glicerina adecuado para exteriores o donde haya vibraciones. Nuestros talleres pueden resolver todas las aplicaciones especiales (accesorios, cuadrantes, escalas no normalizadas). Amplia disponibilidad de stock.

### Anwendungen

SST Fall wasserdicht oder Glycerinbad, geeignet für den Außenbereich oder wo es Vibrationen. Alle spezielle Anwendungen (Ports, Zifferblätter, Skalen Nicht-Standard) können von unseren Workshops gelöst werden. Umfangreiches Lager.

## Caratteristiche principali

Manometro costruito secondo Norme UNI EN 837.1  
Cassa INOX IP65 AISI 304 dn 40 - 50 - 63 mm trasparente  
in policarbonato. Perno e movimento in OTTONE attacco  
POSTERIORE (ISO 228 - ISO 7/1) Quadrante in alluminio  
fondo bianco scala BAR nera e PSI rossa (doppia scala  
esclusi mano vuotometri).

Classe di precisione 2,5 - 1,6%. Lancetta in Alluminio.

## Principales caractéristiques

Manomètre construit selon la norme UNI EN 837.1  
Normes IP65 Boîtier en polycarbonate transparent  
dn 40 - 50 - 63 mm. Goupille et mouvement dans la  
fixation ARRIÈRE EN LAITON (ISO 228 - ISO 7/1) Cadran  
en aluminium échelle inférieure blanche BAR noir et  
rouge PSI (échelle double excluant les vacuomètres à  
main).

Classe de précision 2,5 - 1,6%. Main en aluminium.

## Main features

Pressure gauge made according UNI EN 837.1 norms  
Stainless steel case AISI 304 dial 40 - 50 - 63 mm. BRASS  
movement and pivot BACK (ISO 228 - ISO 7/1)  
connection - Aluminum dial White background Black  
BAR scale and Red PSI one (double scale except com-  
pound gauge).

Accuracy 2,5 - 1,6% - Aluminum index.

## Características principales

Manómetro fabricado según la norma UNI EN 837.1  
Normas IP65 AISI 304 dn 40 - 50 - 63 mm Caja de  
policarbonato transparente. Pasador y movimiento en  
el accesorio BRASS REAR (ISO 228 - ISO 7/1) Escala de  
aluminio con fondo blanco BAR negro y rojo PSI (escala  
doble, excluyendo manómetros de mano).

Clase de precisión 2.5 - 1.6%. Mano de aluminio.

## Hauptmerkmale

Gebaut nach UNI EN 837.1, Bei IP65 Edelstahl AISI 304 dn  
40 - 50 - 63 mm, transparentem Polycarbonat. Stift und  
Bewegung MESSING Angriff ZURÜCK (ISO 228 - ISO 7/1).  
Wählen Aluminium weiß, Maßstab BAR schwarz, rot für  
PSI (zwei Skalen Vakuummeter ausgeschlossen).  
Genauigkeitsklasse 2,5 auf 1,6%. Hand aus Aluminium.

## Esercizio

Temperatura d'esercizio -10°C / +65°C

Costante 75% - Variabile 60%

Sovrappressione 25% fino a 60 bar, 15% oltre

## Exercice

Température de fonctionnement -10°C / +65°C

Constante 75% - Variable 60%

Surpression 25% jusqu'à 60 bar, 15% de plus

## Working

Operating temperature +14°F / +149 °F

Steady 75% - Variable 60%

Overpressure 25% until 60 bar, 15% over

## Ejercicio

Temperatura de funcionamiento -10°C / +65°C

Constante 75% - Variable 60%

Sobrepresión 25% hasta 60 bar, 15% más.

## Ausüben

Betriebstemperatur -10°C / +65°C

Constant 75% - 60% Variable

Überdruck bis 60 bar, mehr als 15%

## Varianti

Scale Normalizzate: Vuotometro -1 / 0 Bar+CmHg;  
Manovuotometro -1+0,6; -1+1,5; -1+3; -1+5; -1+9; -1+15  
solo Bar; 0,6; 1; 1,6; 2,5; 4; 6; 10; 12; 16; 25; 40; 60; 100;  
160; 250; 315; 400 Bar + Psi

## Variantes

Balances normalisées: vacuomètre -1 / 0 Bar + CmHg;  
Manvuotometro -1 + 0,6; -1 + 1,5; -1 + 3; -1 + 5; -1 + 9;  
-1 + 15 bar seulement; 0,6; 1; 1,6; 2,5; 4; 6; 10; 12; 16; 25;  
40; 60; 100; 160; 250; 315; 400 Bar + Psi

## Variants

Normalized scale: gauge compound -1 / 0 Bar+CmHg;  
Water pressure gauge -1+0,6; -1+1,5; -1+3; -1+5; -1+9;  
-1+15 solo Bar; 0,6; 1; 1,6; 2,5; 4; 6; 10; 12; 16; 25; 40; 60;  
100; 160; 250; 315; 400 Bar + Psi

## Variantes

Escalas normalizadas: Medidor de vacío -1 / 0 Bar + CmHg;  
Manvuotometro -1 + 0,6; -1 + 1,5; -1 + 3; -1 + 5; -1 + 9; -1 +  
15 Bar solamente; 0,6; 1; 1,6; 2,5; 4; 6; 10; 12; 16; 25; 40; 60;  
100; 160; 250; 315; 400 Bar + Psi

## Varianten

Maßstab normalisierten Vakuummeter -1 / 0 Bar+CmHg;  
Mano-Vakuummeter -1+0,6; -1+1,5; -1+3; -1+5; -1+9;  
-1+15 nur Bar; 0,6; 1; 1,6; 2,5; 4; 6; 10; 12; 16; 25; 40; 60;  
100; 160; 250; 315; 400 Bar + Psi

## Opzioni prodotto

Filetto NPT ANSI B.1.20.1 con o senza glicerina,  
Sgrassatura uso ossigeno, scale e/o attacchi  
personalizzati, loghi, settori colorati.  
Attacco radiale ad ore 3/9/12.

## Options du produit

Filetage ANSI NPT B.1.20.1 avec ou sans glycérine,  
Dégraissage à l'oxygène, balance et / ou accessoires  
personnalisés, logos, secteurs colorés.  
Attaque radiale au 3/9/12.

## Product options

NPT ANSI B.1.20.1 thread, With or without glycerine,  
OXYGEN SERVICE, customize range, scale or logo;  
Colored sector.  
Bottom connection at 3/9/12 hours.

## Opciones de productos

ANSI NPT hilo B.1.20.1 con o sin glicerina,  
Desengrasado con oxígeno, escalas y / o accesorios  
personalizados, logos, sectores coloreados.  
Ataque radial al 3/9/12.

## Produkt-Optionen

Gewinde NPT ANSI B.1.20.1 mit oder ohne Glycerin,  
Entfetten Verwendung Sauerstoff, Treppen und / oder  
Anhänge individuelle Logos, farbigen Sektoren.  
Radial Angriff 3/9/12 Stunden.

# MX 71

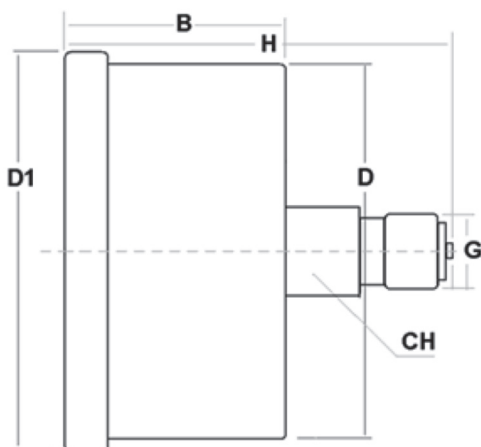

**Manometri glicerina attacco posteriore**

Gauges liquid fillable back connection

Manometer Glycerin zuruck Angriff

Manomètre à bain de glycérine, raccord arrière centré

Manómetro posterior con glicerina

**Vuotometro**

Vacuum Gauge

Vakuummeter

Vacuomètre

Vacuómetro

CODICE/CODE	∅	ATTACCO CONNECTION	SCALA RANGE	PRECISIONE ACCURACY	PEZZI PIECES
<b>MX714018099P</b>	40	G1/8	-1 / 0	C.L.2,5	1

**Manometro**

Gauges

Manometer

Manomètre

Manómetro

CODICE/CODE	∅	ATTACCO CONNECTION	SCALA RANGE	PRECISIONE ACCURACY	PEZZI PIECES
<b>MX714018001P</b>	40	G1/8	0 / +1	C.L.2,5	1
<b>MX714018205P</b>	40	G1/8	0 / +2,5	C.L.2,5	1
<b>MX714018006P</b>	40	G1/8	0 / +6	C.L.2,5	1
<b>MX714018010P</b>	40	G1/8	0 / +10	C.L.2,5	1
<b>MX714018016P</b>	40	G1/8	0 / +16	C.L.2,5	1
<b>MX714018025P</b>	40	G1/8	0 / +25	C.L.2,5	1
<b>MX714018040P</b>	40	G1/8	0 / +40	C.L.2,5	1
<b>MX714018100P</b>	40	G1/8	0 / +100	C.L.2,5	1
<b>MX714018160P</b>	40	G1/8	0 / +160	C.L.2,5	1
<b>MX714018250P</b>	40	G1/8	0 / +250	C.L.2,5	1
<b>MX714018400P</b>	40	G1/8	0 / +400	C.L.2,5	1

**Vuotometro**

Vacuum Gauge

Vakuummeter

Vacuomètre

Vacuómetro

CODICE/CODE	∅	ATTACCO CONNECTION	SCALA RANGE	PRECISIONE ACCURACY	PEZZI PIECES
<b>MX715018099P</b>	50	G1/4	-1 / 0	C.L.1,6	1

**Manometro**

Gauges

Manometer

Manomètre

Manómetro

CODICE/CODE	∅	ATTACCO CONNECTION	SCALA RANGE	PRECISIONE ACCURACY	PEZZI PIECES
<b>MX715014205P</b>	50	G1/4	0 / +2,5	C.L.1,6	1
<b>MX715014004P</b>	50	G1/4	0 / +4	C.L.1,6	1
<b>MX715014006P</b>	50	G1/4	0 / +6	C.L.1,6	1
<b>MX715014010P</b>	50	G1/4	0 / +10	C.L.1,6	1
<b>MX715014016P</b>	50	G1/4	0 / +16	C.L.1,6	1
<b>MX715014025P</b>	50	G1/4	0 / +25	C.L.1,6	1
<b>MX715014100P</b>	50	G1/4	0 / +100	C.L.1,6	1
<b>MX715014250P</b>	50	G1/4	0 / +250	C.L.1,6	1
<b>MX715014400P</b>	50	G1/4	0 / +400	C.L.1,6	1

∅	B	D	D1	H	G	CH	Kg
40	25	40,5	44	43	G1/8	11	0,110
50	28	51	56	50	G1/4	14	0,145

# MX 71

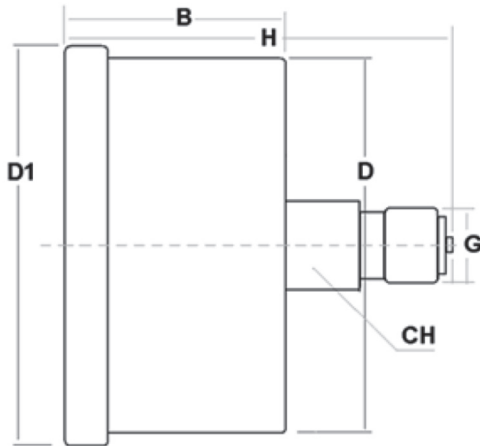

**Manometri glicerina attacco posteriore**

Gauges liquid fillable back connection

Manometer Glycerin zuruck Angriff

Manomètre à bain de glycérine, raccord arrière centré

Manómetro posterior con glicerina

**Vuotometro**

Vacuum Gauge

Vakuummeter

Vacuomètre

Vacuómetro

CODICE/CODE	Ø	ATTACCO CONNECTION	SCALA RANGE	PRECISIONE ACCURACY	PEZZI PIECES
<b>MX716314099P</b>	63	G1/4	-1 / 0	C.L.1,6	1

**Manovuotometro**

Compound

Manovakuummeter

Manovacuumètre

Manovacuómetro

CODICE/CODE	Ø	ATTACCO CONNECTION	SCALA RANGE	PRECISIONE ACCURACY	PEZZI PIECES
<b>MX716314906P</b>	63	G1/4	-1 / +0,6	C.L.1,6	1
<b>MX716314115P</b>	63	G1/4	-1 / +1,5	C.L.1,6	1
<b>MX716314903P</b>	63	G1/4	-1 / +3	C.L.1,6	1
<b>MX716314905P</b>	63	G1/4	-1 / +5	C.L.1,6	1
<b>MX716314909P</b>	63	G1/4	-1 / +9	C.L.1,6	1

**Manometro**

Gauges

Manometer

Manomètre

Manómetro

CODICE/CODE	Ø	ATTACCO CONNECTION	SCALA RANGE	PRECISIONE ACCURACY	PEZZI PIECES
<b>MX716314001P</b>	63	G1/4	0 / +1	C.L.1,6	1
<b>MX716314106P</b>	63	G1/4	0 / +1,6	C.L.1,6	1
<b>MX716314205P</b>	63	G1/4	0 / +2,5	C.L.1,6	1
<b>MX716314004P</b>	63	G1/4	0 / +4	C.L.1,6	1
<b>MX716314006P</b>	63	G1/4	0 / +6	C.L.1,6	1
<b>MX716314010P</b>	63	G1/4	0 / +10	C.L.1,6	1
<b>MX716314012P</b>	63	G1/4	0 / +12	C.L.1,6	1
<b>MX716314016P</b>	63	G1/4	0 / +16	C.L.1,6	1
<b>MX716314025P</b>	63	G1/4	0 / +25	C.L.1,6	1
<b>MX716314040P</b>	63	G1/4	0 / +40	C.L.1,6	1
<b>MX716314060P</b>	63	G1/4	0 / +60	C.L.1,6	1
<b>MX716314100P</b>	63	G1/4	0 / +100	C.L.1,6	1
<b>MX716314160P</b>	63	G1/4	0 / +160	C.L.1,6	1
<b>MX716314250P</b>	63	G1/4	0 / +250	C.L.1,6	1
<b>MX716314315P</b>	63	G1/4	0 / +315	C.L.1,6	1
<b>MX716314400P</b>	63	G1/4	0 / +400	C.L.1,6	1
<b>MX716314600P</b>	63	G1/4	0 / +600	C.L.1,6	1
<b>MX7163141000P</b>	63	G1/4	0 / +1000	C.L.1,6	1

Ø	B	D	D1	H	G	CH	Kg
63	29	62	68	53	G1/4	14	0,188

# MX 71

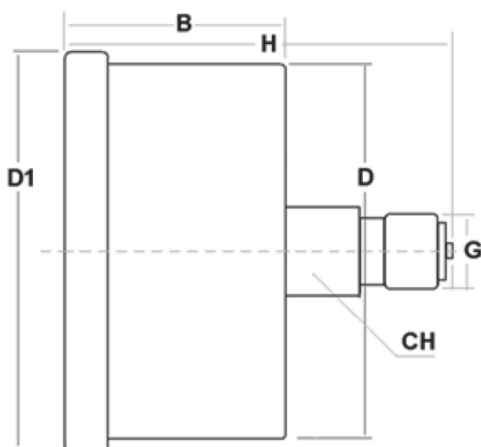

**Manometri glicerina attacco posteriore**

Gauges liquid fillable back connection

Manometer Glycerin zuruck Angriff

Manomètre à bain de glycérine, raccord arrière centré

Manómetro posterior con glicerina

**Vuotometro**

Vacuum Gauge

Vakuummeter

Vacuomètre

Vacuómetro

CODICE/CODE	∅	ATTACCO CONNECTION	SCALA RANGE	PRECISIONE ACCURACY	PEZZI PIECES
<b>MX711012099P</b>	100	G1/2	-1 / 0	C.L.1,0	1

**Manovuotometro**

Compound

Manovakuummeter

Manovacuumètre

Manovacuómetro

CODICE/CODE	∅	ATTACCO CONNECTION	SCALA RANGE	PRECISIONE ACCURACY	PEZZI PIECES
<b>MX711012906P</b>	100	G1/2	-1 / +0,6	C.L.1,0	1
<b>MX711012115P</b>	100	G1/2	-1 / +1,5	C.L.1,0	1
<b>MX711012903P</b>	100	G1/2	-1 / +3	C.L.1,0	1
<b>MX711012905P</b>	100	G1/2	-1 / +5	C.L.1,0	1
<b>MX711012909P</b>	100	G1/2	-1 / +9	C.L.1,0	1

**Manometro**

Gauges

Manometer

Manomètre

Manómetro

CODICE/CODE	∅	ATTACCO CONNECTION	SCALA RANGE	PRECISIONE ACCURACY	PEZZI PIECES
<b>MX711012001P</b>	100	G1/2	0 / +1	C.L.1,0	1
<b>MX711012106P</b>	100	G1/2	0 / +1,6	C.L.1,0	1
<b>MX711012205P</b>	100	G1/2	0 / +2,5	C.L.1,0	1
<b>MX711012004P</b>	100	G1/2	0 / +4	C.L.1,0	1
<b>MX711012006P</b>	100	G1/2	0 / +6	C.L.1,0	1
<b>MX711012010P</b>	100	G1/2	0 / +10	C.L.1,0	1
<b>MX711012016P</b>	100	G1/2	0 / +16	C.L.1,0	1
<b>MX711012025P</b>	100	G1/2	0 / +25	C.L.1,0	1
<b>MX711012040P</b>	100	G1/2	0 / +40	C.L.1,0	1
<b>MX711012060P</b>	100	G1/2	0 / +60	C.L.1,0	1
<b>MX711012100P</b>	100	G1/2	0 / +100	C.L.1,0	1
<b>MX711012160P</b>	100	G1/2	0 / +160	C.L.1,0	1
<b>MX711012250P</b>	100	G1/2	0 / +250	C.L.1,0	1
<b>MX711012400P</b>	100	G1/2	0 / +400	C.L.1,0	1
<b>MX711012600P</b>	100	G1/2	0 / +600	C.L.1,0	1

∅	B	D	D1	H	G	CH	Kg
100	39	98,5	110	82	G1/2	22	0,750



# MX 72

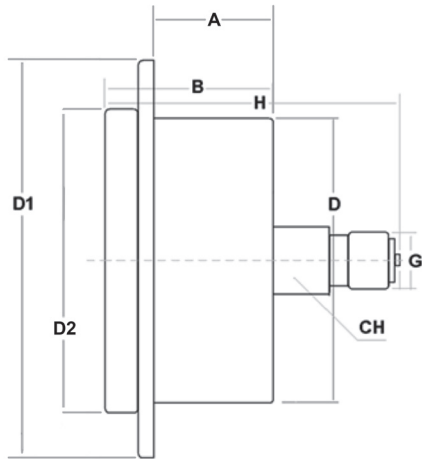

**Manometri glicerina attacco posteriore con flangia 3 fori**

Gauges liquid fillable back connection with 3 holes flange

Manometer Glycerin zurück Angriff für Paneelmontage

Manomètre à bain de glycérine, raccord arrière centré, encastrable

Manómetro posterior con glicerina, brida a 3 taladros

**Vuotometro** Vacuum Gauge Vakuummeter  
 Vacuomètre Vacuómetro

CODICE/CODE	Ø	ATTACCO CONNECTION	SCALA RANGE	PRECISIONE ACCURACY	PEZZI PIECES
<b>MX724018099PF</b>	40	G1/8	-1 / 0	C.L.2,5	1

**Manometro** Gauges Manometer  
 Manomètre Manómetro

CODICE/CODE	Ø	ATTACCO CONNECTION	SCALA RANGE	PRECISIONE ACCURACY	PEZZI PIECES
<b>MX724018001PF</b>	40	G1/8	0 / +1	C.L.2,5	1
<b>MX724018205PF</b>	40	G1/8	0 / +2,5	C.L.2,5	1
<b>MX724018006PF</b>	40	G1/8	0 / +6	C.L.2,5	1
<b>MX724018010PF</b>	40	G1/8	0 / +10	C.L.2,5	1
<b>MX724018016PF</b>	40	G1/8	0 / +16	C.L.2,5	1
<b>MX724018025PF</b>	40	G1/8	0 / +25	C.L.2,5	1
<b>MX724018040PF</b>	40	G1/8	0 / +40	C.L.2,5	1
<b>MX724018100PF</b>	40	G1/8	0 / +100	C.L.2,5	1
<b>MX724018160PF</b>	40	G1/8	0 / +160	C.L.2,5	1
<b>MX724018250PF</b>	40	G1/8	0 / +250	C.L.2,5	1
<b>MX724018400PF</b>	40	G1/8	0 / +400	C.L.2,5	1

**Vuotometro** Vacuum Gauge Vakuummeter  
 Vacuomètre Vacuómetro

CODICE/CODE	Ø	ATTACCO CONNECTION	SCALA RANGE	PRECISIONE ACCURACY	PEZZI PIECES
<b>MX725014099PF</b>	50	G1/4	-1 / 0	C.L.2,5	1

**Manometro** Gauges Manometer  
 Manomètre Manómetro

CODICE/CODE	Ø	ATTACCO CONNECTION	SCALA RANGE	PRECISIONE ACCURACY	PEZZI PIECES
<b>MX725014001PF</b>	50	G1/4	0 / +1	C.L.2,5	1
<b>MX725014205PF</b>	50	G1/4	0 / +2,5	C.L.2,5	1
<b>MX725014004PF</b>	50	G1/4	0 / +4	C.L.2,5	1
<b>MX725014006PF</b>	50	G1/4	0 / +6	C.L.2,5	1
<b>MX725014010PF</b>	50	G1/4	0 / +10	C.L.2,5	1
<b>MX725014016PF</b>	50	G1/4	0 / +16	C.L.2,5	1
<b>MX725014025PF</b>	50	G1/4	0 / +25	C.L.2,5	1
<b>MX725014100PF</b>	50	G1/4	0 / +100	C.L.2,5	1
<b>MX725014250PF</b>	50	G1/4	0 / +250	C.L.2,5	1
<b>MX725014400PF</b>	50	G1/4	0 / +400	C.L.2,5	1

Ø	A	B	D	D1	D2	H	G	CH	Kg
40	22	25	40,5	61	47	43	G1/8	11	0,110
50	22,5	28	51	72	57,5	50	G1/4	14	0,145

# MX 72

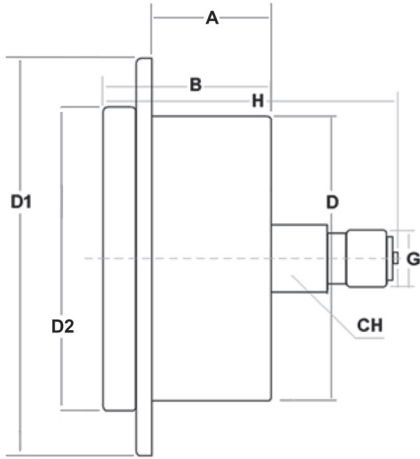

**Manometri glicerina attacco posteriore con flangia 3 fori**

Gauges liquid fillable back connection with 3 holes flange

Manometer Glycerin zurück Angriff für Paneelmontage

Manomètre à bain de glycérine, raccord arrière centré, encastrable

Manómetro posterior con glicerina, brida a 3 taladros

**Vuotometro** Vacuum Gauge Vakuummeter

Vacuomètre Vacuómetro

CODICE/CODE	∅	ATTACCO CONNECTION	SCALA RANGE	PRECISIONE ACCURACY	PEZZI PIECES
<b>MX726314099PF</b>	63	G1/4	-1 / 0	C.L.1,6	1

**Manovuotometro** Compound Manovakuummeter

Manovacuumètre Manovacómetro

CODICE/CODE	∅	ATTACCO CONNECTION	SCALA RANGE	PRECISIONE ACCURACY	PEZZI PIECES
<b>MX726314906PF</b>	63	G1/4	-1 / +0,6	C.L.1,6	1
<b>MX726314115PF</b>	63	G1/4	-1 / +1,5	C.L.1,6	1
<b>MX726314903PF</b>	63	G1/4	-1 / +3	C.L.1,6	1
<b>MX726314905PF</b>	63	G1/4	-1 / +5	C.L.1,6	1
<b>MX726314909PF</b>	63	G1/4	-1 / +9	C.L.1,6	1

**Manometro** Gauges Manometer

Manomètre Manómetro

CODICE/CODE	∅	ATTACCO CONNECTION	SCALA RANGE	PRECISIONE ACCURACY	PEZZI PIECES
<b>MX726314001PF</b>	63	G1/4	0 / +1	C.L.1,6	1
<b>MX726314106PF</b>	63	G1/4	0 / +1,6	C.L.1,6	1
<b>MX726314205PF</b>	63	G1/4	0 / +2,5	C.L.1,6	1
<b>MX726314004PF</b>	63	G1/4	0 / +4	C.L.1,6	1
<b>MX726314006PF</b>	63	G1/4	0 / +6	C.L.1,6	1
<b>MX726314010PF</b>	63	G1/4	0 / +10	C.L.1,6	1
<b>MX726314012PF</b>	63	G1/4	0 / +12	C.L.1,6	1
<b>MX726314016PF</b>	63	G1/4	0 / +16	C.L.1,6	1
<b>MX726314025PF</b>	63	G1/4	0 / +25	C.L.1,6	1
<b>MX726314040PF</b>	63	G1/4	0 / +40	C.L.1,6	1
<b>MX726314060PF</b>	63	G1/4	0 / +60	C.L.1,6	1
<b>MX726314100PF</b>	63	G1/4	0 / +100	C.L.1,6	1
<b>MX726314160PF</b>	63	G1/4	0 / +160	C.L.1,6	1
<b>MX726314250PF</b>	63	G1/4	0 / +250	C.L.1,6	1
<b>MX726314315PF</b>	63	G1/4	0 / +315	C.L.1,6	1
<b>MX726314400PF</b>	63	G1/4	0 / +400	C.L.1,6	1
<b>MX726314600PF</b>	63	G1/4	0 / +600	C.L.1,6	1
<b>MX726314M00PF</b>	63	G1/4	0 / +1000	C.L.1,6	1

∅	A	B	D	D1	D2	H	G	CH	Kg
63	23	29	62	83	68	53	G1/4	14	0,188

# MX 72

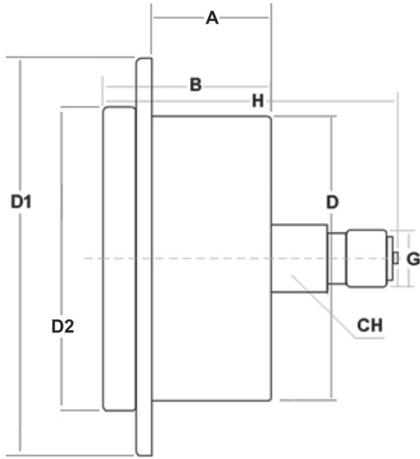

**Manometri glicerina attacco posteriore con flangia 3 fori**

Gauges liquid fillable back connection with 3 holes flange

Manometer Glycerin zurück Angriff für Paneelmontage

Manomètre à bain de glycérine, raccord arrière centré, encastrable

Manómetro posterior con glicerina, brida a 3 taladros

**Vuotometro**

Vacuum Gauge

Vakuummeter

Vacuomètre

Vacuómetro

CODICE/CODE	∅	ATTACCO CONNECTION	SCALA RANGE	PRECISIONE ACCURACY	PEZZI PIECES
<b>MX721012099PF</b>	100	G1/2	-1 / 0	C.L.1,6	1

**Manovuotometro**

Compound

Manovakuummeter

Manovacuumètre

Manovacuómetro

CODICE/CODE	∅	ATTACCO CONNECTION	SCALA RANGE	PRECISIONE ACCURACY	PEZZI PIECES
<b>MX721012906PF</b>	100	G1/2	-1 / +0,6	C.L.1,6	1
<b>MX721012115PF</b>	100	G1/2	-1 / +1,5	C.L.1,6	1
<b>MX721012903PF</b>	100	G1/2	-1 / +3	C.L.1,6	1
<b>MX721012905PF</b>	100	G1/2	-1 / +5	C.L.1,6	1
<b>MX721012909PF</b>	100	G1/2	-1 / +9	C.L.1,6	1

**Manometro**

Gauges

Manometer

Manomètre

Manómetro





CODICE/CODE	∅	ATTACCO CONNECTION	SCALA RANGE	PRECISIONE ACCURACY	PEZZI PIECES
<b>MX721012001PF</b>	100	G1/2	0 / +1	C.L.1,6	1
<b>MX721012106PF</b>	100	G1/2	0 / +1,6	C.L.1,6	1
<b>MX721012205PF</b>	100	G1/2	0 / +2,5	C.L.1,6	1
<b>MX721012004PF</b>	100	G1/2	0 / +4	C.L.1,6	1
<b>MX721012006PF</b>	100	G1/2	0 / +6	C.L.1,6	1
<b>MX721012010PF</b>	100	G1/2	0 / +10	C.L.1,6	1
<b>MX721012016PF</b>	100	G1/2	0 / +16	C.L.1,6	1
<b>MX721012025PF</b>	100	G1/2	0 / +25	C.L.1,6	1
<b>MX721012040PF</b>	100	G1/2	0 / +40	C.L.1,6	1
<b>MX721012060PF</b>	100	G1/2	0 / +60	C.L.1,6	1
<b>MX721012100PF</b>	100	G1/2	0 / +100	C.L.1,6	1
<b>MX721012160PF</b>	100	G1/2	0 / +160	C.L.1,6	1
<b>MX721012250PF</b>	100	G1/2	0 / +250	C.L.1,6	1
<b>MX721012400PF</b>	100	G1/2	0 / +400	C.L.1,6	1
<b>MX721012600PF</b>	100	G1/2	0 / +600	C.L.1,6	1

∅	A	B	D	D1	D2	H	G	CH	Kg
100	27	39	98,5	128	108	82	G1/2	22	0,790

## MX 99



### **Staffa posteriore per manometri glicerina INOX**

-  Back clamp for INOX gauges liquid fillable back connection
-  Paneelblech für Manometer Glycerin INOX
-  Équerre de fixation INOX pour manomètre à bain de glycérine
-  Soporte de fijación INOX para manómetro con glicerina





CODICE/CODE	MISURA/SIZE	PEZZI/PIECES
-------------	-------------	--------------

<b>MX990040P</b>	Ø40	1
<b>MX990063P</b>	Ø50 / Ø63	1
<b>MX990100P</b>	Ø100	1

## MX 72PF



### **Flangia 3 fori per manometri glicerina INOX**

-  3 Holes flange for INOX gauges liquid fillable
-  Paneelring für Manometer Glycerin INOX
-  Équerre de fixation INOX pour manomètre à bain de glycérine
-  Soporte de fijación INOX para manómetro con glicerina

CODICE/CODE	MISURA/SIZE	PEZZI/PIECES
-------------	-------------	--------------

<b>MX720040PF</b>	Ø40	1
<b>MX720050PF</b>	Ø50	1
<b>MX720063PF</b>	Ø63	1
<b>MX720100PF</b>	Ø100	1