





MP

-  **Manometri e vuotometri a polmone bassa pressione**
-  Diaphragm gauges and vacuum gauges low pressure
-  Manometer und Vakuummeter niederdruck
-  Manomètres et vacuomètres avec réservoir basse pression
-  Manómetros y vacuómetros con tanque de baja presión

MP50







pag. 6.4

MP52



pag. 6.4

Dati tecnici di manometri e vuotometri a polmone bassa pressione

-  Diaphragm gauges and vacuum gauges low pressure technical data
-  Technischen Daten der Manometer und Vakuummeter niederdruck
-  Données techniques des manomètres et vacuomètres avec réservoir basse pression
-  Datos técnicos de los manómetros y vacuómetros con tanque de baja presión

Applicazioni

Misurano le basse pressioni dai 25 ai 1000 mBar.

Applications

Ils mesurent les basses pressions de 25 à 1000 mbar.

Applications

Casing gauge for low pressure from 25 to 1000 mBar.

Aplicaciones

Miden bajas presiones de 25 a 1000 mBar.

Anwendungen

Messung niedriger Drücke von 25 bis 1000 mBar.

Caratteristiche principali

Manometro costruito secondo Norme UNI EN 837.3
Cassa Cromata IP32 secondo IEC 529 dn 63 - 80 - 100 - 150 mm. Perno e movimento in OTTONE OT58 attacco RADIALE (ISO 228) quadrante in alluminio scale in mBar, lancetta in alluminio nera. Classe di precisione 1,6%.

Principales caractéristiques

Manomètre construit selon les normes UNI EN 837.3.
Chrome IP32 Boîtier selon CEI 529 DN 63 - 80 - 100 - 150 mm. Tige et mouvement en OTTONE OT58 connexion RADIAL (ISO 228) cadran échelle en aluminium en mBar, aiguille en aluminium noir. Classe de précision 1,6%.

Main features

Made according UNI EN 837.3 Steel Chromed plated case Casing gauge dial 63 - 80 - 100 - 150 mm. OT58 BRASS movement and pivot BOTTOM connection scale in mBar aluminum dial and index. Accuracy 1,6%.

Características principales

Manómetro fabricado según las normas UNI EN 837.3.
Caja de cromo IP32 según IEC 529 dn 63 - 80 - 100 - 150 mm. Pin y movimiento en la conexión de OTTONE OT58 RADIAL (ISO 228) Escala de aluminio en mBar, manecilla de aluminio negro. Clase de precisión del 1,6%.

Hauptmerkmale

Nach UNI EN 837,3 Bargeld Chrome IP32 nach IEC 529 dn gebaut Gauge 63 - 80 - 100 - 150 mm. OT58 Messingstift und Bewegung in Angriff RADIAL (ISO 228) wählen Aluminium-Leitern in mBar, Hand in schwarzem Aluminium. Genauigkeitsklasse 1,6%.

Esercizio

Pressione esercizio MAX 75% VFS x 15 min
Sovrapressione NON AMMESSA
Temperatura d'esercizio -10°C / + 60°C

Exercice

Pression de service MAX 75% VFS x 15 min
Surpression NON ADMIS
Température de fonctionnement -10°C / + 60°C

Working

Max working pressure 75% FSV for 15 min.
Overpressure NOT ADMITTED
Working temperature +14°F / +140°F

Ejercicio

Presión de funcionamiento MAX 75% VFS x 15 min
Sobrepresión NO ADMITIDA
Temperatura de funcionamiento -10°C / + 60°C

Ausüben

Max. Betriebsdruck 75% VFS x 15 min
Überdruck NICHT ZUGELASSEN
Betriebstemperatur -10°C / + 60°C

Varianti

Scale Normalizzate Pressione o Vuoto 25; 40; 60; 100; 160; 250; 400; 600; 1000 mBar

Variantes

Échelles normalisées ou de pression 25; 40; 60; 100; 160; 250; 400; 600; 1000 mBar

Variants

Normalized range Pressure or Vacuum 25; 40; 60; 100; 160; 250; 400; 600; 1000 mBar

Variantes

Escalas normalizadas o de presión 25; 40; 60; 100; 160; 250; 400; 600; 1000 mBar

Varianten

Skala normalisiert Druck oder Vakuum 25; 40; 60; 100; 160; 250; 400; 600; 1000 mBar

Opzioni prodotto

Scale e/o attacchi personalizzati, loghi, settori colorati.
Attacco Radiale ad ore 3/9/12.

Options du produit

Balances et / ou pièces jointes personnalisées, logos, secteurs colorés.
Attaque radiale au 3/9/12.

Product options

Customize range, scale or logo; colored sector.
Bottom connection at 3/9/12 hours.

Opciones de productos

Escalas y / o adjuntos personalizados, logotipos, sectores coloreados.
Ataque radial al 3/9/12.

Produkt-Optionen

Skalen und / oder Anhänge individuelle Logos, farbigen Sektoren.
Radial Anschluss an 3/9/12 Stunden.

MP 50

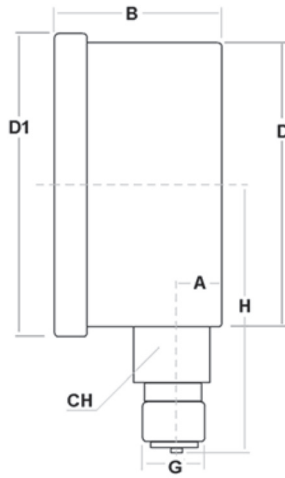

Vuotometri a polmone bassa pressione

- Vacuum casing gauges
- Vakuummeter
- Jauges de vide pulmonaire à basse pression
- Medidores de vacío de pulmón de baja presión

CODICE/CODE	Ø	ATTACCO CONNECTION	SCALA RANGE	PRECISIONE ACCURACY	PEZZI PIECES
MP5063141000R	63	G1/4	-1000 / 0 mbar	C.L.1,6	1
MP5063140600R	63	G1/4	-600 / 0 mbar	C.L.1,6	1
MP5063140400R	63	G1/4	-400 / 0 mbar	C.L.1,6	1
MP5063140250R	63	G1/4	-250 / 0 mbar	C.L.1,6	1
MP5063140160R	63	G1/4	-160 / 0 mbar	C.L.1,6	1
MP5063140100R	63	G1/4	-100 / 0 mbar	C.L.1,6	1
MP5063140060R	63	G1/4	-60 / 0 mbar	C.L.1,6	1
MP5063140040R	63	G1/4	-40 / 0 mbar	C.L.1,6	1
MP5063140025R	63	G1/4	-25 / 0 mbar	C.L.1,6	1

Ø	A	B	D	D1	H	G	CH
63	8,5	32	61,2	69	61	G1/4	14

MP 52

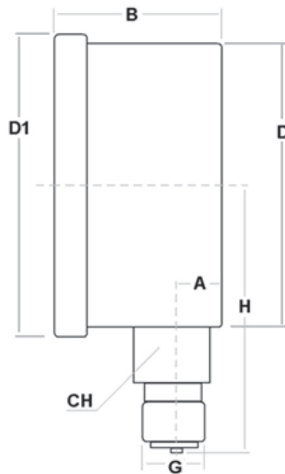

Manometri a polmone bassa pressione

- Casing gauges
- Manometer
- Manomètres pulmonaires à basse pression
- Manómetros de pulmón de baja presión

CODICE/CODE	Ø	ATTACCO CONNECTION	SCALA RANGE	PRECISIONE ACCURACY	PEZZI PIECES
MP5263140025R	63	G1/4	0 - 25 mbar	C.L.1,6	1
MP5263140040R	63	G1/4	0 - 40 mbar	C.L.1,6	1
MP5263140060R	63	G1/4	0 - 60 mbar	C.L.1,6	1
MP5263140100R	63	G1/4	0 - 100 mbar	C.L.1,6	1
MP5263140160R	63	G1/4	0 - 160 mbar	C.L.1,6	1
MP5263140250R	63	G1/4	0 - 250 mbar	C.L.1,6	1
MP5263140400R	63	G1/4	0 - 400 mbar	C.L.1,6	1
MP5263140600R	63	G1/4	0 - 600 mbar	C.L.1,6	1
MP5263141000R	63	G1/4	0 - 1000 mbar	C.L.1,6	1

Ø	A	B	D	D1	H	G	CH
63	8,5	32	61,2	69	61	R1/4	14