







-  **Giunti universali**
-  Universal couplings
-  Universal Kupplungen
-  Raccords à coiffe universel
-  Enchufe universal

### GU10



### GU20



### GU30







### GU40



### GU50



### **Dati tecnici di giunti universali**

-  Universal couplings technical data
-  Technischen Daten der Universal Kupplungen
-  Données techniques des raccords à coiffe universel
-  Datos técnicos de los enchufe universal

### **Caratteristiche principali**

1. Gamma completa 1/8 - 1/2"
2. Filettatura BSPP cilindrica UNI-ISO228, BSPT conica UNI-ISO 7
3. Vasta gamma
4. Robustezza meccanica

### **Principales caractéristiques**

1. Gamme complète 1/8 - 1/2"
2. Filetage cylindrique BSPP UNI-ISO 228, conique BSPT UNI-ISO 7
3. Large gamme
4. Résistance mécanique

### **Main features**

1. Complete Range 1/8 - 1/2"
2. BSPP cylindrical thread UNI-ISO 228, conical BSPT UNI-ISO 7
3. Wide range
4. Mechanical Resistance

### **Características principales**

1. Gama completa 1/8-1/2"
2. BSPP rosca cilíndrica UNI-ISO 228, cónica BSPT UNI-ISO 7
3. Amplia gama
4. Robustez mecánica

### **Hauptmerkmale**

1. Vollständiges Sortiment 1/8 - 1/2"
2. BSPP-zylindrisches Gewinde UNI-ISO 228, konisch BSPT UNI-ISO 7
3. Große Auswahl
4. Mechanische Festigkeit

### **Applicazioni**

1. Aria Compressa
2. Impianti per automazione pneumatica
3. Gas inerti
4. Vuoto

### **Applications**

1. Air comprimé
2. Installations pour l'automatisation pneumatique
3. Gaz neutres
4. Vide

### **Applications**

1. Compressed Air
2. Systems for pneumatic automation
3. Inert Gases
4. Vacuum

### **Aplicaciones**

1. Aire comprimido
2. Instalaciones para automación neumática
3. Gases inertes
4. Vacío

### **Anwendungen**

1. Druckluft
2. Systeme für die pneumatische Automatisierung
3. Inertgase
4. Leer

### **Fluido**

Aria compressa

### **Fluid**

Compressed air

### **Fluid**

Druckluft

### **Fluide**

Air comprimé

### **Fluido**

Aire comprimido

### **Filettatura**

BSPP cilindrica UNI-ISO228

### **Thread types**

BSPP parallel UNI-ISO228

### **Gewinde**

BSPP zylindrisch UNI-ISO228

### **Filetage**

BSPP cylindrique UNI-ISO228

### **Roscado**

BSPP cilíndrico UNI-ISO 228

### **Filetti**

Filettature da 1/8 a 1/2"

### **Threads**

Threads from 1/8 to 1/2"

### **Gewinde**

Gewinde von 1/8 bis 1/2"

### **Filets**

Filetages de 1/8 à 1/2"

### **Roscas**

Roscas de 1/8 a 1/2"

## Materiali

Ottone e acciaio

## Matériels

Laiton et acier

## Materials

Brass and steel

## Materiales

Latón y acero

## Werkstoffen

Messing und Stahl

Pressione	Pressure	Druck	Pression	Presión
Pressione: <b>12 Bar</b>	Pressure: <b>12 Bar</b>	Druck: <b>12 Bar</b>	Pression: <b>12 bar</b>	Presión: <b>12 Bar</b>

Portata max	Max Flow	Max Mengstrom	Débit max	Caudal max
Portata: 2000 l/min.	Flow: 2000 l/min.	Mengstrom: 2000 l/min.	Débit: 2000 l/min.	Caudal: 2000 l/min.

## GU 10

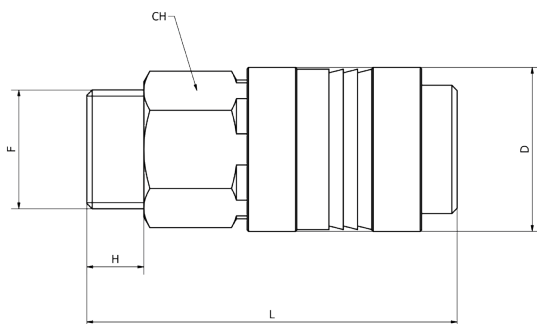

### Giunto universale maschio

Universal male quick coupler

Universal Kupplungen

Coupleurs mâle universel

Enchufe macho universal

CODICE/CODE	F	H	D	L	CH	PEZZI/PIECES
<b>GU100018</b>	G1/8	6,5	23	51	19	10
<b>GU100014</b>	G1/4	8	23	52,5	19	10
<b>GU100038</b>	G3/8	8	23	52,5	19	10
<b>GU100012</b>	G1/2	9,5	23	55,5	22	10

## GU 20

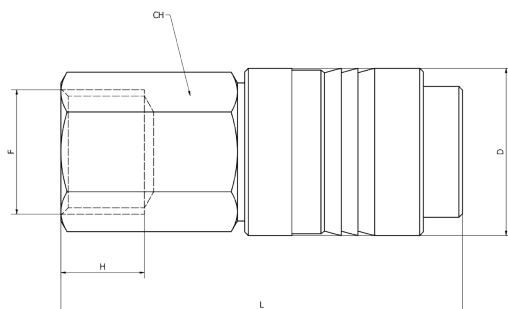

### Giunto universale femmina

Universal female quick coupler

Universal Kupplungen

Coupleurs femelle universel

Enchufe hembra universal

CODICE/CODE	F	H	D	L	CH	PEZZI/PIECES
<b>GU200018</b>	G1/8	8	23	52,5	19	10
<b>GU200014</b>	G1/4	11	23	52,5	19	10
<b>GU200038</b>	G3/8	11	23	55,5	19	10
<b>GU200012</b>	G1/2	12,5	23	56	25	10

## GU 30

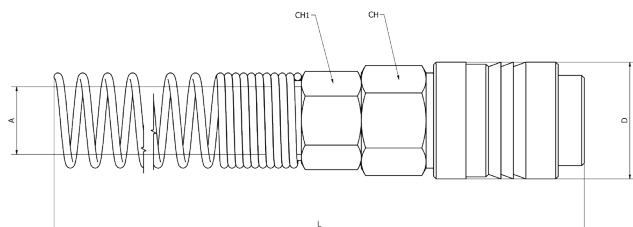

**Giunto universale con molla**

Universal quick coupler with spring

Universal Kupplungen mit Feder

Coupleurs universel avec ressort

Enchufe universal con muelle

CODICE/CODE	A	D	L	CH	CH1	PEZZI/PIECES
<b>GU300406</b>	04x06	23	128,5	19	12	10
<b>GU300508</b>	05x08	23	140,5	19	13	10
<b>GU300608</b>	06x08	23	141	19	13	10
<b>GU306510</b>	6,5x10	23	140	19	15	10
<b>GU300810</b>	08x10	23	140	19	15	10
<b>GU300812</b>	08x12	23	143	19	17	10
<b>GU301012</b>	10x12	23	140,5	19	17	10

## GU 40

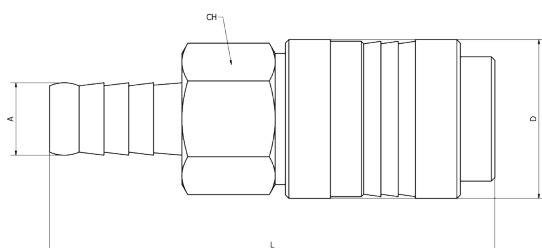

**Giunto universale con resca**

Universal quick coupler with tail

Universal Kupplungen mit Abschluss

Coupleurs universel barbillon

Enchufe universal con espiga

CODICE/CODE	A	D	L	CH	PEZZI/PIECES
<b>GU400006</b>	6	23	62	19	10
<b>GU400008</b>	8	23	64	19	10
<b>GU400009</b>	9	23	64,5	19	10
<b>GU400010</b>	10	23	64,5	19	10
<b>GU400011</b>	11	23	64,5	19	10
<b>GU400012</b>	12	23	64,5	19	10

## GU 50

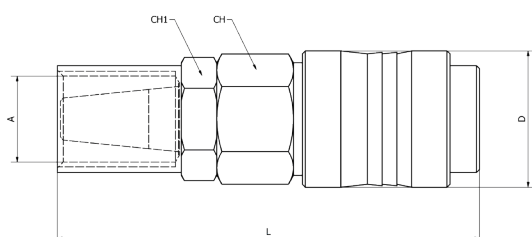

**Giunto universale portagomma**

Universal quick coupler for rubber tube

Schlauchtulle Universal Kupplungen

Coupleurs universel pour tuyau

Enchufe universal para tubo

CODICE/CODE	A	D	L	CH	CH1	PEZZI/PIECES
<b>GU500610</b>	06X10	23	71	19	15	10
<b>GU500612</b>	06X12	23	71	19	15	10
<b>GU500614</b>	06X14	23	71	19	17	10
<b>GU500812</b>	08X12	23	71,5	19	15	10
<b>GU500813</b>	08X13	23	71,5	19	16	10
<b>GU500815</b>	08X15	23	71,5	19	18	10
<b>GU500817</b>	08X17	23	71,5	19	20	10
<b>GU501015</b>	10X15	23	73,5	19	18	10
<b>GU501017</b>	10X17	23	73,5	19	20	10
<b>GU501019</b>	10X19	23	76,5	19	22	10