











-  **Giunti ed innesti Germania**
-  Germany couplings and plugs
-  Kupplungen Deutschland
-  Raccords à coiffe Allemagne
-  Enchufe Alemania

GD10**GD20****GD30****GD40****GD50****GD60****GD60T****GD70****GD80****GD85****GD90****GD95****GD97**** Dati tecnici di giunti ed innesti Italia**

-  Italy couplings and plugs technical data
-  Technischen Daten der Kupplungen Italien
-  Données techniques des raccords à coiffe Italie
-  Datos técnicos de los enchufe Italia

 Caratteristiche principali

1. Gamma completa 1/8 – 1/2"
2. Filettatura BSPP cilindrica UNI-ISO228, BSPT conica UNI-ISO 7
3. Vasta gamma
4. Robustezza meccanica

 Principales caractéristiques

1. Gamme complète 1/8 - 1/2"
2. Filetage cylindrique BSPP UNI-ISO 228, conique BSPT UNI-ISO 7
3. Large gamme
4. Résistance mécanique

 Main features

1. Complete Range 1/8 - 1/2"
2. BSPP cylindrical thread UNI-ISO 228, conical BSPT UNI-ISO 7
3. Wide range
4. Mechanical Resistance

 Características principales

1. Gama completa 1/8-1/2"
2. BSPP rosca cilíndrica UNI-ISO 228, cónica BSPT UNI-ISO 7
3. Amplia gama
4. Robustez mecánica

 Hauptmerkmale

1. Vollständiges Sortiment 1/8 - 1/2"
2. BSPP-zylindrisches Gewinde UNI-ISO 228, konisch BSPT UNI-ISO 7
3. Große Auswahl
4. Mechanische Festigkeit

 Applicazioni

1. Aria Compressa
2. Impianti per automazione pneumatica
3. Gas inerti
4. Vuoto

 Applications

1. Air comprimé
2. Installations pour l'automatisation pneumatique
3. Gaz neutres
4. Vide

 Applications

1. Compressed Air
2. Systems for pneumatic automation
3. Inert Gases
4. Vacuum

 Aplicaciones

1. Aire comprimido
2. Instalaciones para automación neumática
3. Gases inertes
4. Vacío

 Anwendungen

1. Druckluft
2. Systeme für die pneumatische Automatisierung
3. Inertgase
4. Leer

Fluid
Acqua, olio, aria compressa

Fluid
Water, oils, compressed air

Fluid
Wasser, oel, druckluft

Fluide
Eau, huile, air comprimé

Fluido
Agua, aceite, aire comprimido

Filettatura
BSPP cilindrica UNI-ISO228

Thread types
BSPP parallel UNI-ISO228

Gewinde
BSPP zylindrisch UNI-ISO228

Filetage
BSPP cylindrique UNI-ISO228

Roscado
BSPP cilindrico UNI-ISO 228

Filetti
Filettature da 1/4 a 1/2"

Threads
Threads from 1/4 to 1/2"

Gewinde
Gewinde von 1/4 bis 1/2"

Filets
Filetages de 1/4 à 1/2"

Roscas
Roscas de 1/4 a 1/2"

Pressione e temperatura	Pressure and Temperature	Druck und Temperatur	Pression et Température	Presión y Temperatura
Pressione: 12 Bar	Pressure: 12 Bar	Druck: 12 Bar	Pression: 12 bar	Presión: 12 Bar
Temperatura: -18°C / +80°C	Temperature: 0°F / +176°F	Temperatur: -18°C / +80°C	Température: -18°C / +80°C	Temperatura: -18°C / +80°C

Portata	Flow	Mengenstrom	Débit	Caudal
Portata: 2000 l/min.	Flow: 2000 l/min.	Mengenstrom: 2000 l/min.	Débit: 2000 l/min.	Caudal: 2000 l/min.

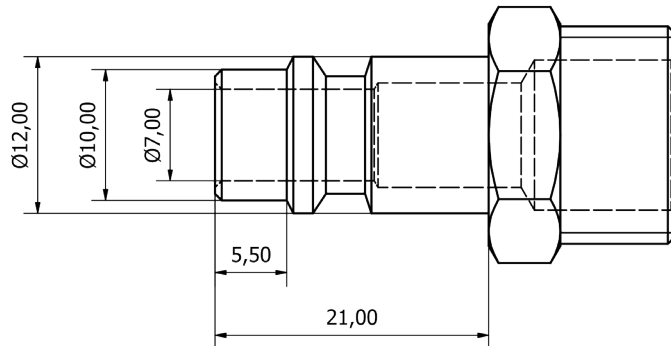

GD 10

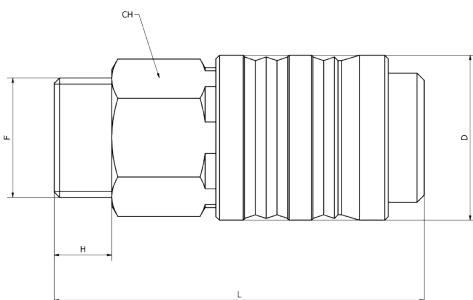



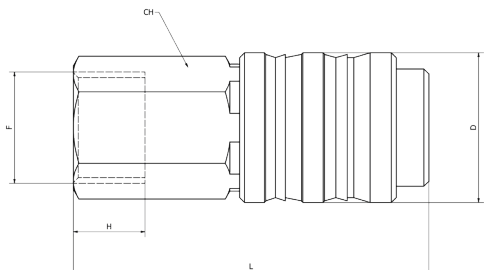

Giunto Germania maschio
German male quick coupler
Kupplungen Deutschland
Coupleurs mâle Allemagne
Enchufe macho Alemania

CODICE/CODE	F	H	D	L	CH	PEZZI/PIECES
GD100014	G1/4	8	23	51,5	19	10
GD100038	G3/8	8	23	51,5	19	10
GD100012	G1/2	9,5	23	55	22	10

GD 20





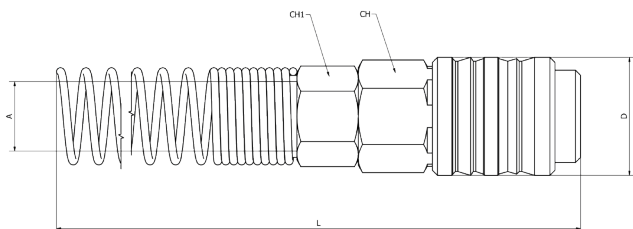

-  **Giunto Germania femmina**
-  German female quick coupler
-  Kupplungen Deutschland
-  Coupleurs femelle Allemagne
-  Enchufe hembra Alemania

CODICE/CODE	F	H	D	L	CH	PEZZI/PIECES
GD200014	G1/4	9	23	51,5	19	10
GD200038	G3/8	11	23	54	19	10
GD200012	G1/2	12,5	23	55	25	10

GD 30





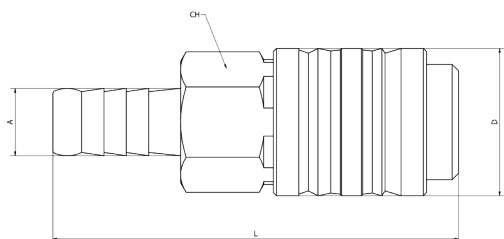

-  **Giunto Germania con molla**
-  German female quick coupler with spring
-  Kupplungen Deutschland mit Feder
-  Coupleurs Allemagne avec ressort
-  Enchufe Alemania con muelle

CODICE/CODE	A	D	L	CH	CH1	PEZZI/PIECES
GD300406	04x06	23	130	19	12	10
GD300508	05x08	23	139,5	19	13	10
GD300608	06x08	23	139,5	19	13	10
GD306510	6,5x10	23	140	19	15	10
GD300810	08x10	23	140	19	15	10
GD300812	08x12	23	143	19	17	10
GD301012	10x12	23	143	19	17	10

GD 40



-  **Giunto Germania con resca**
-  German quick coupler with tail
-  Kupplungen Deutschland mit Abschluss
-  Coupleurs Allemagne barbillon
-  Enchufe Alemania con espiga

CODICE/CODE	A	D	L	CH	PEZZI/PIECES
GD400006	6	23	61,5	19	10
GD400007	7	23	61,5	19	10
GD400008	8	23	63,5	19	10
GD400009	9	23	63,5	19	10
GD400010	10	23	63,5	19	10
GD400012	12	23	63,5	19	10

GD 50

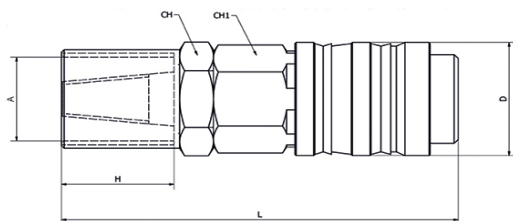

Giunto Germania portagomma

- German quick coupler for rubber hose
- Schlauchtulle Kupplungen Deutschland
- Coupleurs Allemagne pour tuyau
- Enchufe Alemania para tubo

CODICE/CODE	A	D	L	CH	CH1	PEZZI/PIECES
GD500610	06x10	23	69	15	19	10
GD500612	06x12	23	70	15	19	10
GD500614	06x14	23	70	17	19	10
GD500812	08x12	23	70	15	19	10
GD500817	08x17	23	70,5	20	19	10
GD501019	10x19	23	75,5	22	19	10

GD 60

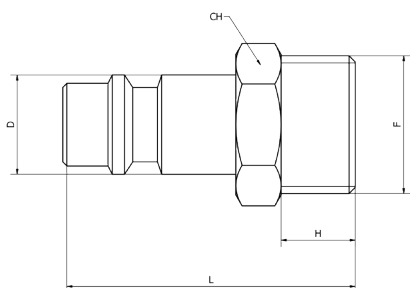

Innesto maschio Germania

- German male connection
- Kupplungen Deutschland
- Embout mâle Allemagne
- Adaptador macho Alemania

CODICE/CODE	F	H	D	L	CH	PEZZI/PIECES
GD600014	G1/4	8,5	12	35	14	10
GD600038	G3/8	9	12	35,5	17	10
GD600012	G1/2	11	12	38	22	10

GD 60T

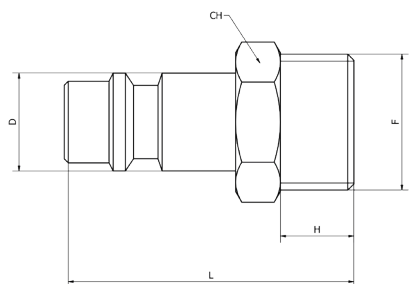

Innesto maschio Germania (acciaio temperato)

- German male connection (tempered steel)
- Kupplungen Deutschland (Gehärtete Edelstahl)
- Embout mâle Allemagne (acier trempé)
- Adaptador macho Alemania (acero templado)

CODICE/CODE	F	H	D	L	CH	PEZZI/PIECES
GD600014T	G1/4	8,5	12	35	14	10
GD600038T	G3/8	9	12	35,5	17	10

GD 70

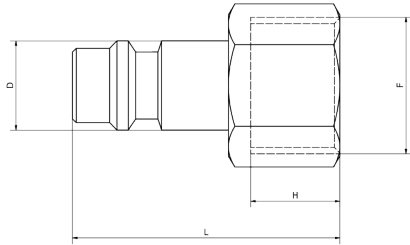

Innesto Germania femmina

German female connection

Kupplungen Deutschland

Embout femelle Allemagne

Adaptador hembra Alemania

CODICE/CODE	F	H	D	L	CH	PEZZI/PIECES
GD700014	G1/4	11	12	34,5	15	10
GD700038	G3/8	12	12	36	19	10
GD700012	G1/2	14,5	12	39	25	10

GD 80

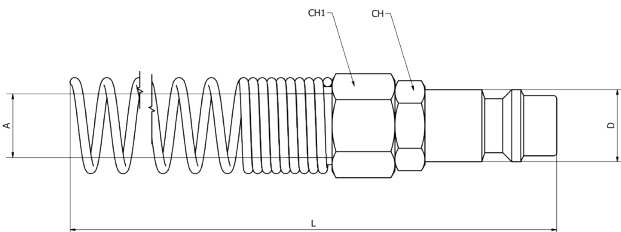

Innesto Germania con molla

German spring connection

Kupplungen Deutschland mit Feder

Embout Allemagne avec ressort

Adaptador Alemania con muelle

CODICE/CODE	A	D	L	CH	CH1	PEZZI/PIECES
GD800406	04x06	12	111	13	12	10
GD800508	05x08	12	122	13	13	10
GD800608	06x08	12	121	13	13	10
GD806510	6,5x10	12	122,5	13	15	10
GD800810	08x10	12	120,5	15	13	10
GD800812	08x12	12	122	17	15	10
GD801012	10x12	12	123,5	17	15	10

GD 85

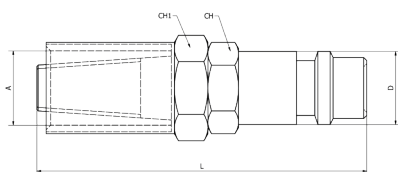

Innesto Germania portagomma

German connection for rubber tube

Schlauchtulle Kupplungen Deutschland

Embout Allemagne pour tuyau

Adaptador Alemania para tubo

CODICE/CODE	A	D	L	CH	CH1	PEZZI/PIECES
GD850610	06x10	12	53	13	15	10
GD850612	06x12	12	53	13	15	10
GD850614	06x14	12	53	13	17	10
GD850812	08x12	12	54	13	15	10
GD850813	08x13	12	54	13	16	10
GD850817	08x17	12	54	13	20	10
GD851019	10x19	12	58	13	22	10

GD 90

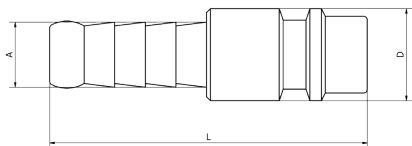

Innesto Germania con resca

 German connection with tail

 Kupplungen Deutschland mit Abschluss

 Embout Allemagne barbillon

 Adaptador Alemania con espiga

CODICE/CODE	A	D	L	PEZZI/PIECES
GD900006	6,5	12	39,5	10
GD900007	7,5	12	41,5	10
GD900008	8,5	12	41,5	10
GD900009	9,5	12	41,5	10
GD900010	11	12	41,5	10
GD900012	12	12	41	10
GD900013	13,5	12	46,5	10

GD 95

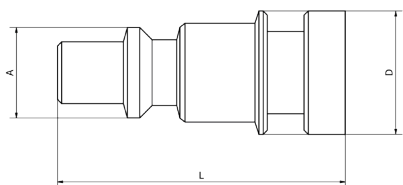

Innesto Germania baionetta

 German bayonet connection

 Kupplungen Deutschland mit Bajonett

 Embout Allemagne baïonnette

 Adaptador Alemania bayoneta

CODICE/CODE	A	D	L	PEZZI/PIECES
GD950000	12	15	32,5	10

GD 97

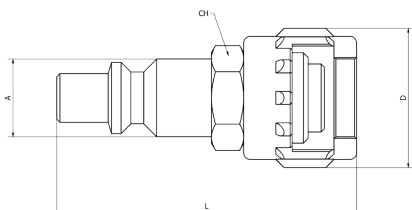

Innesto Germania con dado fresato

 German connection with milled nut

 Kupplungen Deutschland mit Mutter

 Embout Allemagne avec écrou fraise

 Adaptador Alemania con tuerca fresada

CODICE/CODE	A	D	L	CH	PEZZI/PIECES
GD970000	12	20	43	14	10