

Limit Switches DP series

Summary

APPROVALS: UL 508 / CSA C22-2 N. 14 / IEC 60947-5-1



CB-SCHEME certification according to IEC 60947-5-1

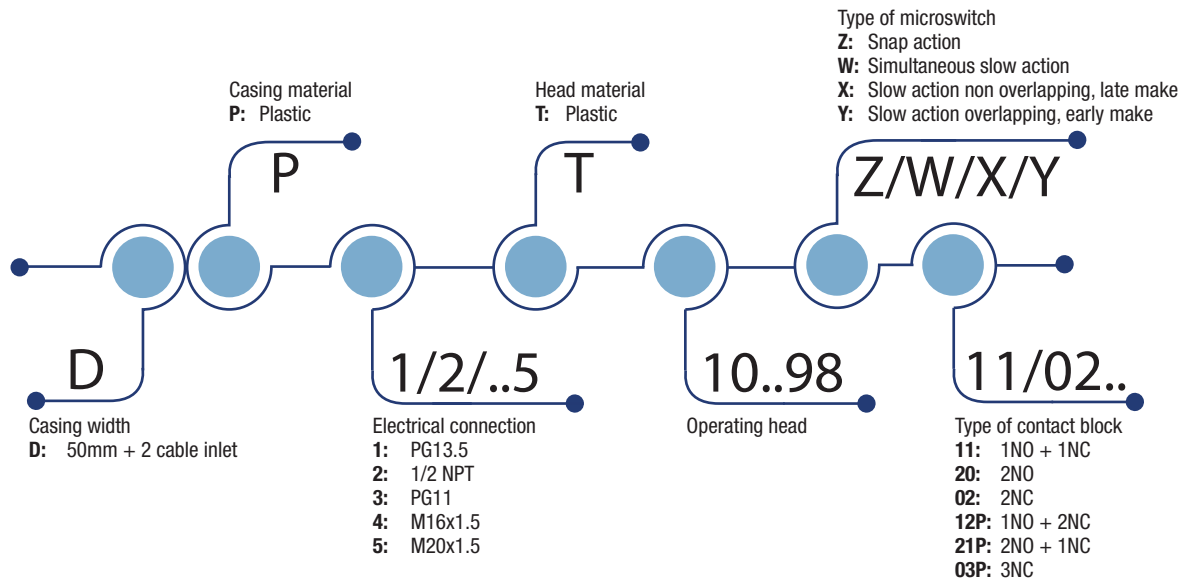

HOW IS IT MADE?

01 A variety of actuators

- Plain plunger
- Roller plunger
- Roller lever, adjustable or not, etc.

02 Wide range of heads

- Assembled using 4 x Ø3 screws

03 Casing:

- 50 mm. width

04 Mounting screws

- 2 or 4 x M4 screws on top part

05 Cover

- 1 screw Ø3 pozidriv 1

06 Contact Block

- Positive opening operation
- Snap action or slow action
- Electrically separated contacts

07 Connecting terminals

- Block of 2 contacts: M3.5 (+, -) pozidriv 2 screw
- Block of 3 contacts: M3 (+, -) screw
- Screw head with captive cable clamp
- Markings conform with IEC 60947-1, IEC 60947-5-1 standards

08 Electrical connection

- 2 x threaded cable inlets suitable for cable gland

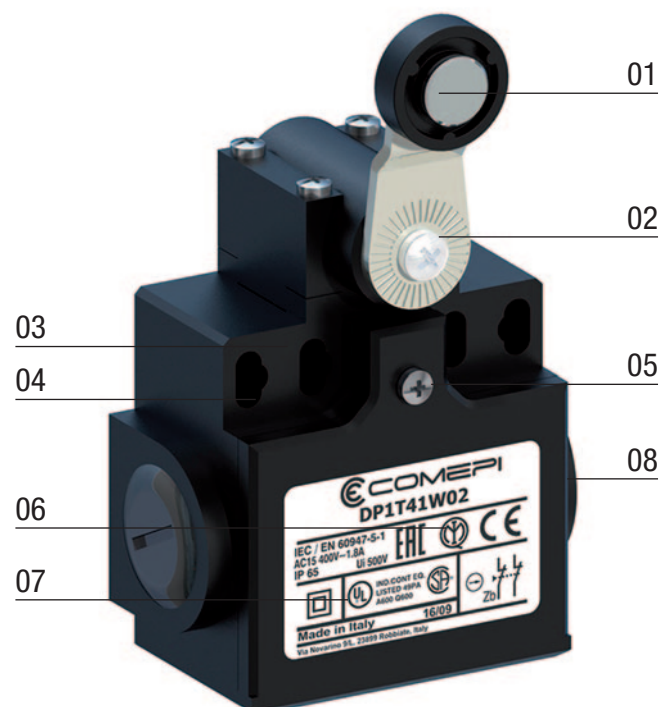

Limit Switches **DP series**

Description

APPLICATIONS

Easy to use, electromechanical limit switches offer specific qualities:

- Visible operation.
- Able to switch strong currents (10 A conventional thermal current).
- Electrically separated contacts.
- Precise operating points (consistency).
- Immune to electromagnetic disturbances.

They are purpose-built detection devices thanks to these characteristics:

- Presence/absence.
- Positioning and travel limit.
- Objects passing/counting.

DESCRIPTION

Limit switches, which are made of reinforced UL-VO thermoplastic fiber-glass, offer double insulation  and a degree of protection of IP65.

They comply with the requirements of European Directives (Low Voltage and RoHS) and are conform to European and International Standards.

The CE declaration of these products are available in the download section of website www.comepi.it or by writing to the following email address: tecnico@comepi.it
DDC02 - Limit Switches.

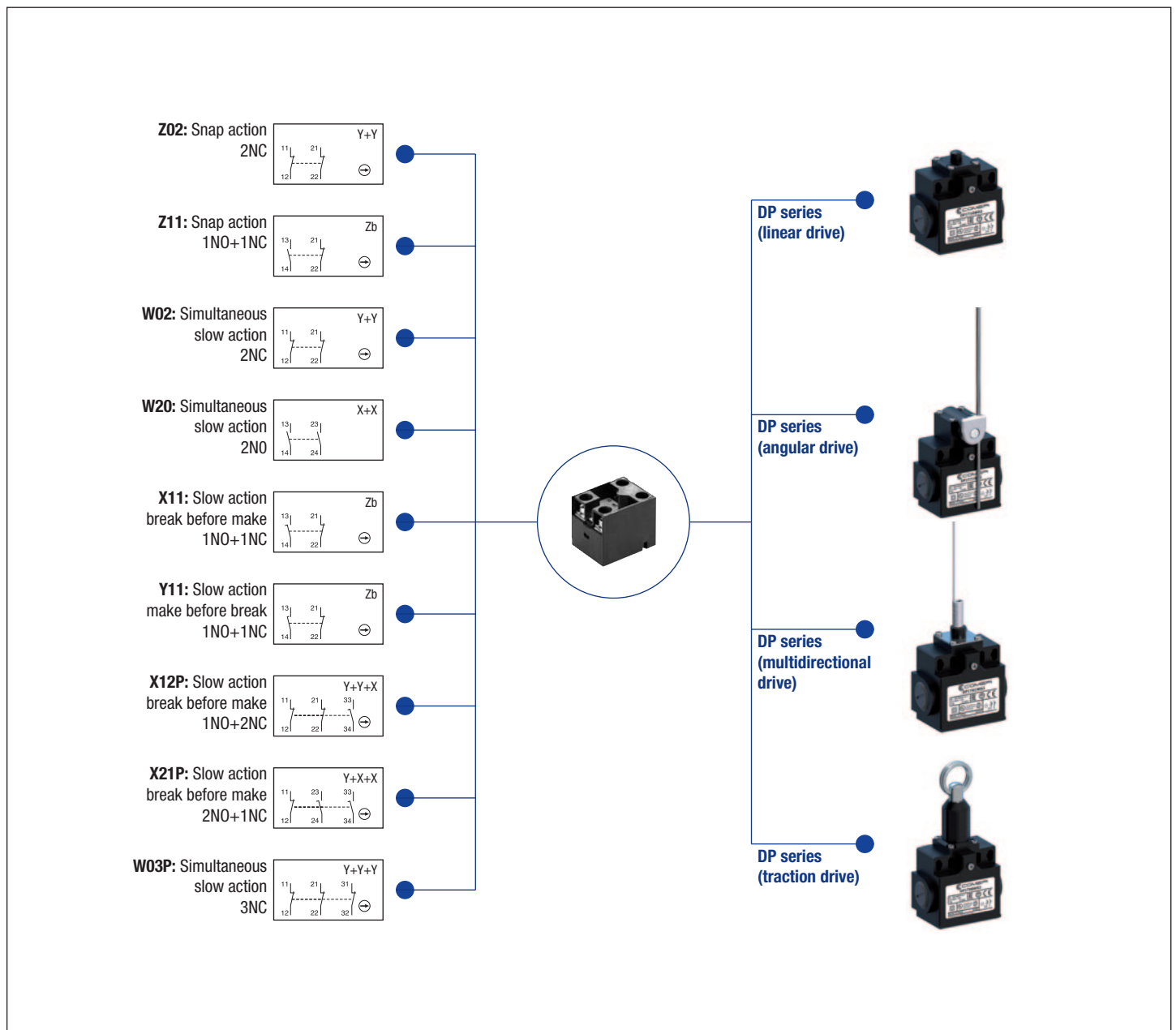

Limit Switches **DP series**

Technical Data

	DP_T Series	
Standards	IEC 60947-5-1 EN 60947-5-1	
Certifications - Approvals	UL - CSA - IMQ - EAC - CCC - UKCA	
Air temperature near the device		
– during operation	°C	– 25 ... + 70
– for storage	°C	– 30 ... + 80
Mounting positions	All positions are authorised	
Protection against electrical shocks (acc. to IEC 61140)	Class II	
Degree of protection (according to IEC 60529 and EN 60529)	IP65 (for all models) - IP67 (only for operating heads from 10 to 39)	

Electrical Data

Rated insulation voltage U_i - according to IEC 60947-1 and EN 60947-1 - according to UL 508 and CSA C22-2 n° 14	500 V (degree of pollution 3) (400 V for contacts type Z02, X12P, X21P, W03P) A 600, Q 600 (A 300, Q 300 for contacts type X12P, X21P, W03P)	
Rated impulse withstand voltage U_{imp} (according to IEC 60947-1 and EN 60947-1)	kV	6
Conventional free air thermal current I_{th} (according to IEC 60947-5-1) $\theta < 40$ °C	A	10
Short-circuit protection $U_e < 500$ V a.c. - gG (gl) type fuses	A	10
Rated operational current I_e / AC-15 (according to IEC 60947-5-1)	24 V - 50/60 Hz A 120 V - 50/60 Hz A 400 V - 50/60 Hz A	10 6 4
I_e / DC-13 (according to IEC 60947-5-1)	24 V - d.c. A 125 V - d.c. A 250 V - d.c. A	6 0.55 0.4
Switching frequency	Cycles/h	3600
Load factor		0.5
Resistance between contacts	m Ω	25
Connecting terminals	M3.5 (+, -) pozidriv 2 screw with cable clamp (M3 for 3 poles contacts type)	
Terminal for protective conductor	-	
Recommended tightening torque	Plastic	
Cover	0,5Nm, max 0,8	
Head	0,5Nm, max 0,8	
Microswitch	0,8Nm, max 0,9	
Connecting capacity	1 or 2 x mm ²	0.34 ... 2.5 (0.34... 1.5 for 3 poles contacts type)
Terminal marking	According to IEC 60947-5-1	
Mechanical durability	15 millions of operations 10 millions of operations >5 millions of operations	T10...12; T21; T2101; T30...34; T38 T13; T41...48; T51...55; T61...75 T14; T35; T36; T39; T91...93; T98
Electrical durability (according to IEC 60947-5-1)	Utilization categories AC-15 and DC-13 (Load factor of 0.5 according to curves below)	

AC-15 - Snap action

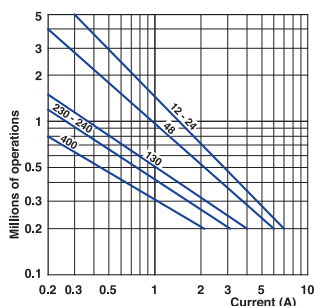

AC-15 - Slow action

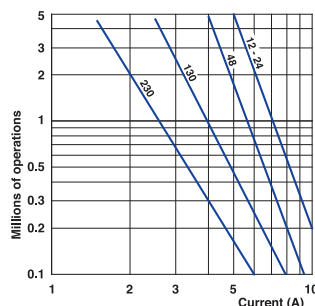

DC-13	Snap action	Slow action
		Power breaking for a durability of 5 million operating cycles
Voltage 24 V	9.5 W	12 W
Voltage 48 V	6.8 W	9 W
Voltage 110 V	3.6 W	6 W

Limit Switches DP series

Technical Data

Technical data approved by IMQ

Standards	Devices conform with international IEC 60947-5-1 and European EN 60947-5-1 standards	
Degree of protection	IP 65	
Rated insulation voltage U_i	500 V (degree of pollution 3) (400V for type Z02, X12P, X21P, W03P)	
Rated impulse withstand voltage U_{imp}	6 kV	
Conventional free air thermal current I_{th}	10 A	
Short-circuit protection - gG (gI) type fuses	10 A	
Rated operational current		
I_e / AC-15	24 V - 50/60 Hz	10 A
	400 V - 50/60 Hz	4 A
I_e / DC-13	24 V - d.c.	6 A
	125 V - d.c.	0.55 A
	250 V - d.c.	0.4 A

IMPLEMENTATION

Operating head orientation

The head can be rotated each 90°. Recommended tightening torque 0,5 Nm (max 0,8 Nm).

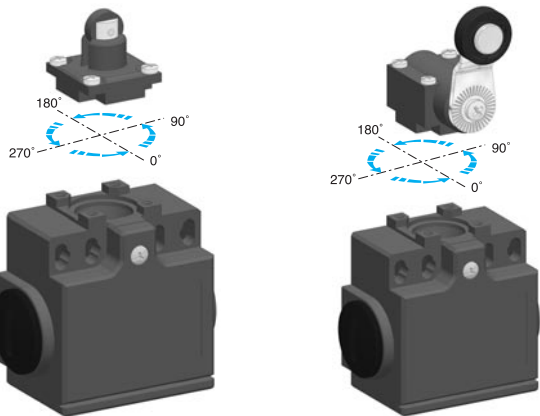

Technical data approved by UL

Standards	Devices conform with UL 508
Contact blocks type Z11, X11, Y11, W02 and Z02	
Utilization categories	A600, Q600
Contact blocks type X12P, X21P and W03P	
Utilization categories	A300, Q300

Use 60/75°C copper (Cu) conductor only. Wire rages 14-18 AWG stranded or solid. The terminal tightening torque of 7 lbs-in / 0.78 Nm. Suitable for conduit connection only with use of adapter sleeve optionally provided or recommended by the manufacturer.

For the complete list of approved products, contact our technical department

Lever adjustment

The lever of the angular actuators can be adjusted every 10° and round turned in order to obtain the maximum flexibility on the working plan. Recommended tightening torque 0,5 Nm (max 0,8 Nm).

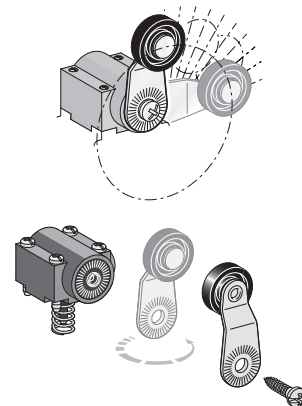

Special Versions

Metal actuators

The operating heads used in plastic limit switches AP and DP series have the same dimensions of the ones used in the corresponding metal AM and DM series. It is therefore possible to supply "mixed" versions, that is:

- plastic operating head on metal casing
- metal operating head on plastic casing

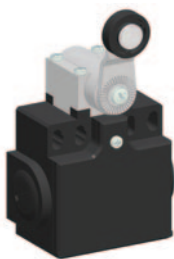

Low Temperature

The limit switches for low temperature applications are useful for refrigerated cells or equipments where the air operational temperature is very low. These devices, made in special materials, are able to extend the operational temperature range down to -40°C, maintaining mechanical performances intact.

To order add the digits "40" following the operating head indication in part number.

For example: DP1T10Z11 → DP1T1040Z11

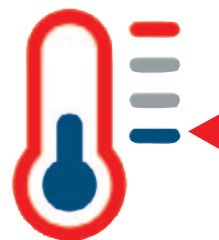

Manual reset operating head

Limit switches equipped with special operating head with manual reset button.

For more information:



For further informations, please contact our technical department.

Limit Switches **DP_T series**

Double insulation - Plastic casing IP65 - 50 mm. width

Electrical connection:

- DP1:** two cable inlets for PG 13,5 Cable Gland
DP2: two cable inlets for PG11 Cable Gland with one plastic adapter PG11 - 1/2" NPT
DP3: two cable inlets for PG11 Cable Gland
DP4: two cable inlets for M16 x 1,5 Cable Gland
DP5: two cable inlets for M20 x 1,5 Cable Gland

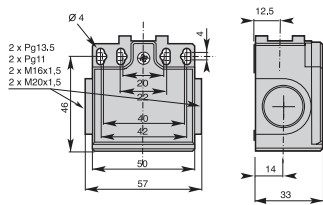

T10 - Plain nylon plunger

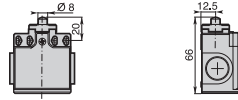

Min. actuating force
Weight 15N (30N ⊖)
100 g

T11 - Plain metal plunger

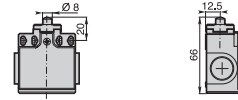

Min. actuating force
Weight 15N (30N ⊖)
100 g

T12 - Metal roller plunger

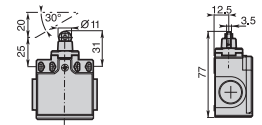

Min. actuating force
Weight 12N (30N ⊖)
105 g

Contact Blocks

Z11 (1NO + 1NC)	DP•T10Z11	DP•T11Z11	DP•T12Z11
X11 (1NO + 1NC)	DP•T10X11	DP•T11X11	DP•T12X11
Y11 (1NO + 1NC)	DP•T10Y11	DP•T11Y11	DP•T12Y11
W02 (2NC)	DP•T10W02	DP•T11W02	DP•T12W02
W20 (2NO)	DP•T10W20	DP•T11W20	DP•T12W20
Z02 (2NC)	DP•T10Z02	DP•T11Z02	DP•T12Z02
X12P (1NO + 2NC)	DP•T10X12P	DP•T11X12P	DP•T12X12P
X21P (2NO + 1NC)	DP•T10X21P	DP•T11X21P	DP•T12X21P
W03P (3NC)	DP•T10W03P	DP•T11W03P	DP•T12W03P

T13 - Nylon roller plunger

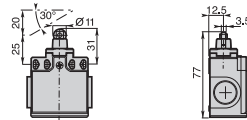

Min. actuating force
Weight 12N (30N ⊖)
105 g

T14 - Metal plunger with dust protection cup

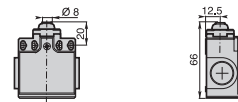

Min. actuating force
Weight 15N (30N ⊖)
100 g

T21 - Plain plunger with M18x fixing nuts

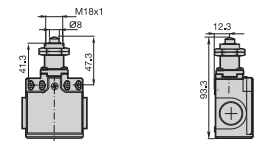

Min. actuating force
Weight 15N (30N ⊖)
110 g

Contact Blocks

Z11 (1NO + 1NC)	DP•T13Z11	DP•T14Z11	DP•T21Z11
X11 (1NO + 1NC)	DP•T13X11	DP•T14X11	DP•T21X11
Y11 (1NO + 1NC)	DP•T13Y11	DP•T14Y11	DP•T21Y11
W02 (2NC)	DP•T13W02	DP•T14W02	DP•T21W02
W20 (2NO)	DP•T13W20	DP•T14W20	DP•T21W20
Z02 (2NC)	DP•T13Z02	DP•T14Z02	DP•T21Z02
X12P (1NO + 2NC)	DP•T13X12P	DP•T14X12P	DP•T21X12P
X21P (2NO + 1NC)	DP•T13X21P	DP•T14X21P	DP•T21X21P
W03P (3NC)	DP•T13W03P	DP•T14W03P	DP•T21W03P

Operation diagrams: page 123 - All dimensions are in mm

Limit Switches DP_T series

Double insulation - Plastic casing IP65 - 50 mm. width

Electrical connection:

- DP1:** two cable inlets for PG 13,5 Cable Gland
- DP2:** two cable inlets for PG11 Cable Gland with one plastic adapter PG11 - 1/2" NPT
- DP3:** two cable inlets for PG11 Cable Gland
- DP4:** two cable inlets for M16 x 1,5 Cable Gland
- DP5:** two cable inlets for M20 x 1,5 Cable Gland

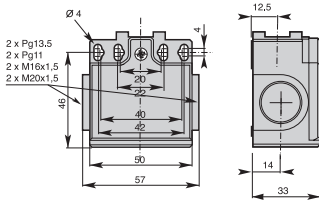

Contact Blocks

- Z11** (1NO + 1NC)
- X11** (1NO + 1NC)
- Y11** (1NO + 1NC)
- W02** (2NC)
- W20** (2NO)
- Z02** (2NC)
- X12P** (1NO + 2NC)
- X21P** (2NO + 1NC)
- W03P** (3NC)

T2101 - Plain plunger with M12x1 fixing nuts

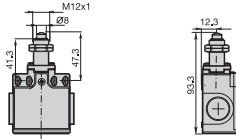

Min. actuating force **15N (30N ⊖)**
Weight **110 g**

T30 - Plastic roller lever on plastic plunger

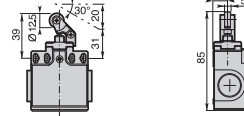

Min. actuating force **7N (24N ⊖)**
Weight **105 g**

T31 - Plastic roller lever on metal plunger

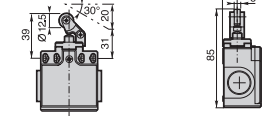

Min. actuating force **7N (24N ⊖)**
Weight **105 g**

T35 - Plastic roller lever on metal plunger with dust protection cup

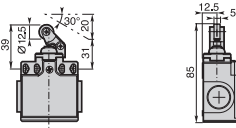

Min. actuating force **7N (24N ⊖)**
Weight **105 g**

T38 - Adjustable plastic roller lever on metal plunger

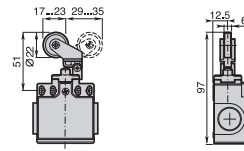

Min. actuating force **7N (24N ⊖)**
Weight **110 g**

T39 - Adjustable plastic roller lever on metal plunger with dust protection cup

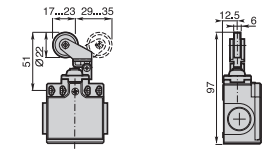

Min. actuating force **7N (24N ⊖)**
Weight **110 g**

Contact Blocks

- Z11** (1NO + 1NC)
- X11** (1NO + 1NC)
- Y11** (1NO + 1NC)
- W02** (2NC)
- W20** (2NO)
- Z02** (2NC)
- X12P** (1NO + 2NC)
- X21P** (2NO + 1NC)
- W03P** (3NC)

- DP•T35Z11**
- DP•T35X11**
- DP•T35Y11**
- DP•T35W02**
- DP•T35W20**
- DP•T35Z02**
- DP•T35X12P**
- DP•T35X21P**
- DP•T35W03P**

- DP•T38Z11**
- DP•T38X11**
- DP•T38Y11**
- DP•T38W02**
- DP•T38W20**
- DP•T38Z02**
- DP•T38X12P**
- DP•T38X21P**
- DP•T38W03P**

- DP•T39Z11**
- DP•T39X11**
- DP•T39Y11**
- DP•T39W02**
- DP•T39W20**
- DP•T39Z02**
- DP•T39X12P**
- DP•T39X21P**
- DP•T39W03P**

Operation diagrams: page 123 - All dimensions are in mm

Limit Switches DP_T series

Double insulation - Plastic casing IP65 - 50 mm. width

Electrical connection:

- DP1:** two cable inlets for PG 13,5 Cable Gland
DP2: two cable inlets for PG11 Cable Gland with one plastic adapter PG11 - 1/2" NPT
DP3: two cable inlets for PG11 Cable Gland
DP4: two cable inlets for M16 x 1,5 Cable Gland
DP5: two cable inlets for M20 x 1,5 Cable Gland

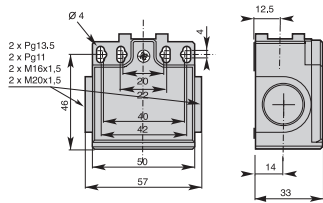

T41 - Ø 18 nylon roller lever

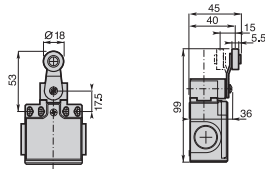

Min. actuating torque 0,10Nm (0,32Nm ⊖)
 Weight 125 g

T42 - Ø 50 rubber roller lever

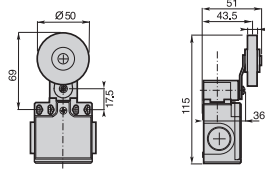

Min. actuating torque 0,10Nm (0,32Nm ⊖)
 Weight 145 g

T43 - Ø 18 metal roller lever

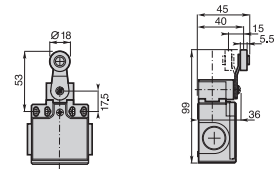

Min. actuating torque 0,10Nm (0,32Nm ⊖)
 Weight 130 g

Contact Blocks

Z11 (1NO + 1NC)	DP•T41Z11	DP•T42Z11	DP•T43Z11
X11 (1NO + 1NC)	DP•T41X11	DP•T42X11	DP•T43X11
Y11 (1NO + 1NC)	DP•T41Y11	DP•T42Y11	DP•T43Y11
W02 (2NC)	DP•T41W02	DP•T42W02	DP•T43W02
W20 (2NO)	DP•T41W20	DP•T42W20	DP•T43W20
Z02 (2NC)	DP•T41Z02	DP•T42Z02	DP•T43Z02
X12P (1NO + 2NC)	DP•T41X12P	DP•T42X12P	DP•T43X12P
X21P (2NO + 1NC)	DP•T41X21P	DP•T42X21P	DP•T43X21P
W03P (3NC)	DP•T41W03P	DP•T42W03P	DP•T43W03P

T45 - Ø 18 nylon roller lever

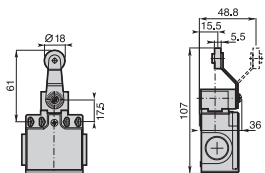

Min. actuating torque 0,10Nm (0,32Nm ⊖)
 Weight 125 g

T46 - Ø 18 metal roller lever

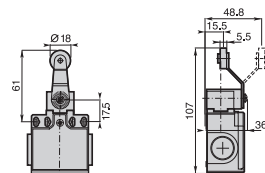

Min. actuating torque 0,10Nm (0,32Nm ⊖)
 Weight 130 g

T48 - Ceramic rod lever

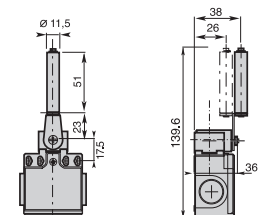

Min. actuating torque 0,10Nm (0,32Nm ⊖)
 Weight 130 g

Contact Blocks

Z11 (1NO + 1NC)	DP•T45Z11	DP•T46Z11	DP•T48Z11
X11 (1NO + 1NC)	DP•T45X11	DP•T46X11	DP•T48X11
Y11 (1NO + 1NC)	DP•T45Y11	DP•T46Y11	DP•T48Y11
W02 (2NC)	DP•T45W02	DP•T46W02	DP•T48W02
W20 (2NO)	DP•T45W20	DP•T46W20	DP•T48W20
Z02 (2NC)	DP•T45Z02	DP•T46Z02	DP•T48Z02
X12P (1NO + 2NC)	DP•T45X12P	DP•T46X12P	DP•T48X12P
X21P (2NO + 1NC)	DP•T45X21P	DP•T46X21P	DP•T48X21P
W03P (3NC)	DP•T45W03P	DP•T46W03P	DP•T48W03P

Operation diagrams: page 123 - All dimensions are in mm

Limit Switches DP_T series

Double insulation - Plastic casing IP65 - 50 mm. width

Electrical connection:

- DP1:** two cable inlets for PG 13,5 Cable Gland
- DP2:** two cable inlets for PG11 Cable Gland with one plastic adapter PG11 - 1/2" NPT
- DP3:** two cable inlets for PG11 Cable Gland
- DP4:** two cable inlets for M16 x 1,5 Cable Gland
- DP5:** two cable inlets for M20 x 1,5 Cable Gland

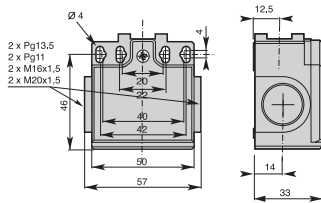

T51 - Adjustable lever with Ø 18 nylon roller

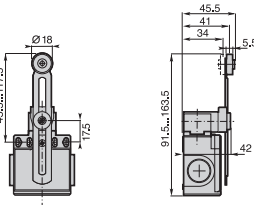

Min. actuating torque **0,10Nm (0,32Nm ⊖)**
Weight **135 g**

T5100 - Adjustable toothed lever (step 2 mm) with Ø 18 nylon roller

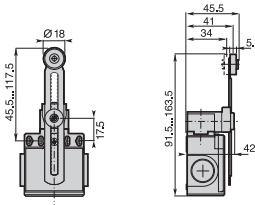

Min. actuating torque **0,10Nm (0,32Nm ⊖)**
Weight **135 g**

T52 - Adjustable lever with Ø 50 rubber roller

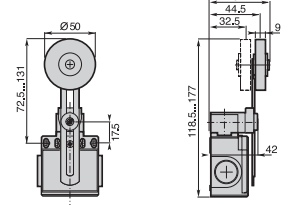

Min. actuating torque **0,10Nm (0,32Nm ⊖)**
Weight **155 g**

Contact Blocks

Z11 (1NO + 1NC)	DP•T51Z11	DP•T5100Z11	DP•T52Z11
X11 (1NO + 1NC)	DP•T51X11	DP•T5100X11	DP•T52X11
Y11 (1NO + 1NC)	DP•T51Y11	DP•T5100Y11	DP•T52Y11
W02 (2NC)	DP•T51W02	DP•T5100W02	DP•T52W02
W20 (2NO)	DP•T51W20	DP•T5100W20	DP•T52W20
Z02 (2NC)	DP•T51Z02	DP•T5100Z02	DP•T52Z02
X12P (1NO + 2NC)	DP•T51X12P	DP•T5100X12P	DP•T52X12P
X21P (2NO + 1NC)	DP•T51X21P	DP•T5100X21P	DP•T52X21P
W03P (3NC)	DP•T51W03P	DP•T5100W03P	DP•T52W03P

T5200 - Adjustable toothed lever (step 2 mm) with Ø 50 rubber roller

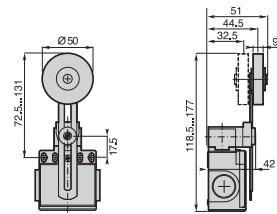

Min. actuating torque **0,10Nm (0,32Nm ⊖)**
Weight **155 g**

T53 - Adjustable lever with Ø 18 metal roller

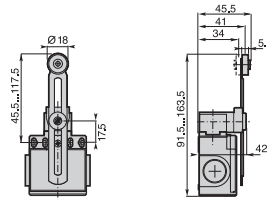

Min. actuating torque **0,10Nm (0,32Nm ⊖)**
Weight **140 g**

T55 - Adjustable lever with adjustable Ø 50 rubber roller

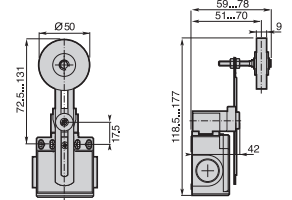

Min. actuating torque **0,10Nm (0,32Nm ⊖)**
Weight **155 g**

Contact Blocks

Z11 (1NO + 1NC)	DP•T5200Z11	DP•T53Z11	DP•T55Z11
X11 (1NO + 1NC)	DP•T5200X11	DP•T53X11	DP•T55X11
Y11 (1NO + 1NC)	DP•T5200Y11	DP•T53Y11	DP•T55Y11
W02 (2NC)	DP•T5200W02	DP•T53W02	DP•T55W02
W20 (2NO)	DP•T5200W20	DP•T53W20	DP•T55W20
Z02 (2NC)	DP•T5200Z02	DP•T53Z02	DP•T55Z02
X12P (1NO + 2NC)	DP•T5200X12P	DP•T53X12P	DP•T55X12P
X21P (2NO + 1NC)	DP•T5200X21P	DP•T53X21P	DP•T55X21P
W03P (3NC)	DP•T5200W03P	DP•T53W03P	DP•T55W03P

Operation diagrams: page 123 - All dimensions are in mm

Limit Switches DP_T series

Double insulation - Plastic casing IP65 - 50 mm. width

Electrical connection:

- DP1:** two cable inlets for PG 13,5 Cable Gland
DP2: two cable inlets for PG11 Cable Gland with one plastic adapter PG11 - 1/2" NPT
DP3: two cable inlets for PG11 Cable Gland
DP4: two cable inlets for M16 x 1,5 Cable Gland
DP5: two cable inlets for M20 x 1,5 Cable Gland

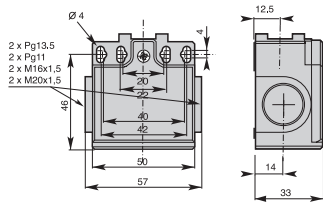

Contact Blocks

Z11 (1NO + 1NC)	DP•T5500Z11	DP•T61Z11	DP•T62Z11
X11 (1NO + 1NC)	DP•T5500X11	DP•T61X11	DP•T62X11
Y11 (1NO + 1NC)	DP•T5500Y11	DP•T61Y11	DP•T62Y11
W02 (2NC)	DP•T5500W02	DP•T61W02	DP•T62W02
W20 (2NO)	DP•T5500W20	DP•T61W20	DP•T62W20
Z02 (2NC)	DP•T5500Z02	DP•T61Z02	DP•T62Z02
X12P (1NO + 2NC)	DP•T5500X12P	DP•T61X12P	DP•T62X12P
X21P (2NO + 1NC)	DP•T5500X21P	DP•T61X21P	DP•T62X21P
W03P (3NC)	DP•T5500W03P	DP•T61W03P	DP•T62W03P

T5500 - Adjustable toothed lever (step 2 mm) with adjustable Ø 50 rubber roller

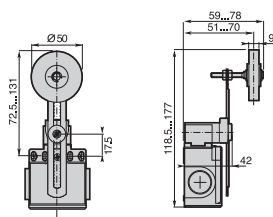

Min. actuating torque 0,10Nm (0,32Nm ⇄)
Weight 155 g

T61 - Nylon actuator with stainless steel spring

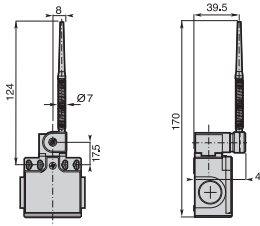

Min. actuating torque 0,10Nm
Weight 135 g

T62 - Stainless steel spring actuator

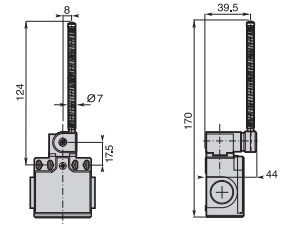

Min. actuating torque 0,10Nm
Weight 135 g

T71 - Adjustable Ø 3 rod lever with stainless steel rod

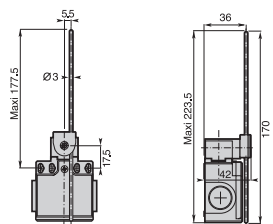

Min. actuating torque 0,10Nm (0,32Nm ⇄)
Weight 130 g

T72 - Adjustable Ø 3 rod lever with fiberglass rod

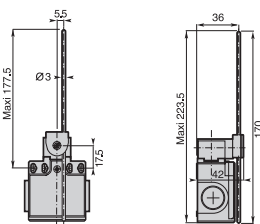

Min. actuating torque 0,10Nm (0,32Nm ⇄)
Weight 130 g

T73 - Adjustable Ø 6 rod lever with nylon rod

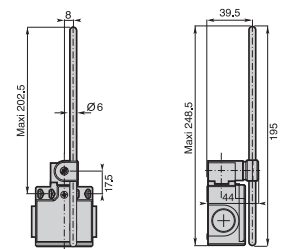

Min. actuating torque 0,10Nm (0,32Nm ⇄)
Weight 145 g

Contact Blocks

Z11 (1NO + 1NC)	DP•T71Z11	DP•T72Z11	DP•T73Z11
X11 (1NO + 1NC)	DP•T71X11	DP•T72X11	DP•T73X11
Y11 (1NO + 1NC)	DP•T71Y11	DP•T72Y11	DP•T73Y11
W02 (2NC)	DP•T71W02	DP•T72W02	DP•T73W02
W20 (2NO)	DP•T71W20	DP•T72W20	DP•T73W20
Z02 (2NC)	DP•T71Z02	DP•T72Z02	DP•T73Z02
X12P (1NO + 2NC)	DP•T71X12P	DP•T72X12P	DP•T73X12P
X21P (2NO + 1NC)	DP•T71X21P	DP•T72X21P	DP•T73X21P
W03P (3NC)	DP•T71W03P	DP•T72W03P	DP•T73W03P

Operation diagrams: page 123 - All dimensions are in mm

Limit Switches DP_T series

Double insulation - Plastic casing IP65 - 50 mm. width

Electrical connection:

- DP1:** two cable inlets for PG 13,5 Cable Gland
DP2: two cable inlets for PG11 Cable Gland with one plastic adapter PG11 - 1/2" NPT
DP3: two cable inlets for PG11 Cable Gland
DP4: two cable inlets for M16 x 1,5 Cable Gland
DP5: two cable inlets for M20 x 1,5 Cable Gland

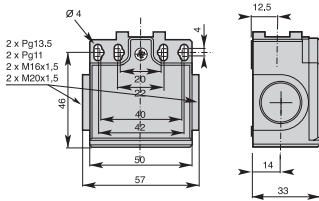

T74 - Adjustable Ø 6 rod lever with fiberglass rod

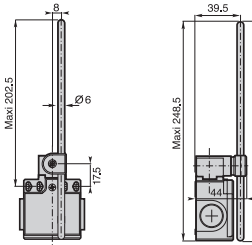

Min. actuating torque **0,10Nm (0,32Nm ⊖)**
 Weight **145 g**

T75 - Adjustable 3x3 square steel rod lever

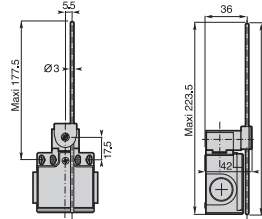

Min. actuating torque **0,10Nm (0,32Nm ⊖)**
 Weight **130 g**

T91 - Stainless steel spring multidirectional actuator

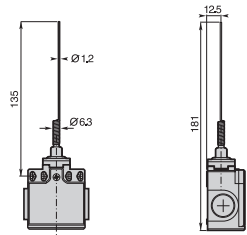

Min. actuating torque **0,12Nm**
 Weight **110 g**

Contact Blocks

Z11 (1NO + 1NC)	DP•T74Z11	DP•T75Z11	DP•T91Z11
X11 (1NO + 1NC)	DP•T74X11	DP•T75X11	DP•T91X11
Y11 (1NO + 1NC)	DP•T74Y11	DP•T75Y11	DP•T91Y11
W02 (2NC)	DP•T74W02	DP•T75W02	DP•T91W02
W20 (2NO)	DP•T74W20	DP•T75W20	DP•T91W20
Z02 (2NC)	DP•T74Z02	DP•T75Z02	DP•T91Z02
X12P (1NO + 2NC)	DP•T74X12P	DP•T75X12P	DP•T91X12P
X21P (2NO + 1NC)	DP•T74X21P	DP•T75X21P	DP•T91X21P
W03P (3NC)	DP•T74W03P	DP•T75W03P	DP•T91W03P

T92 - Multidirectional nylon actuator with stainless steel spring

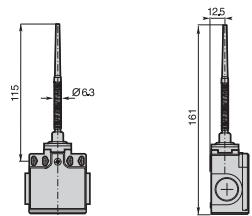

Min. actuating torque **0,12Nm**
 Weight **115 g**

T93 - Stainless steel spring multidirectional actuator

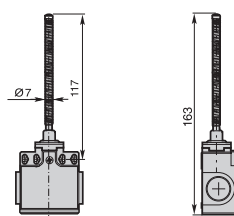

Min. actuating torque **0,12Nm**
 Weight **120 g**

T98 - Pull action with ring

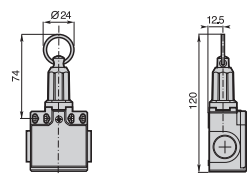

Min. actuating force **30N**
 Weight **145 g**

Contact Blocks

Z11 (1NO + 1NC)	DP•T92Z11	DP•T93Z11	DP•T98Z11A
X11 (1NO + 1NC)	DP•T92X11	DP•T93X11	DP•T98X11A
Y11 (1NO + 1NC)	DP•T92Y11	DP•T93Y11	DP•T98Y11A
W02 (2NC)	DP•T92W02	DP•T93W02	DP•T98W02A
W20 (2NO)	DP•T92W20	DP•T93W20	DP•T98W20A
Z02 (2NC)	DP•T92Z02	DP•T93Z02	
X12P (1NO + 2NC)	DP•T92X12P	DP•T93X12P	
X21P (2NO + 1NC)	DP•T92X21P	DP•T93X21P	
W03P (3NC)	DP•T92W03P	DP•T93W03P	

Operation diagrams: page 123 - All dimensions are in mm